

⚠ WARNING

1. To avoid electric shock, disconnect power at source prior to installation.
2. The installation should be performed by qualified electricians or lighting technicians.
3. Before conducting any installation, maintenance, or removal, disable all power.
4. Do not touch the fixture while it is in service.
5. If there is any problem with the fixture, turn off power and DO NOT attempt repair unless you are a qualified technician.

Mounting Instructions

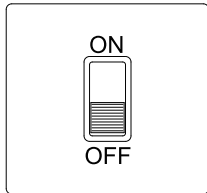

1 Turn power off.

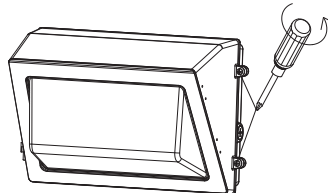

2 Remove the screws on both sides of fixture.

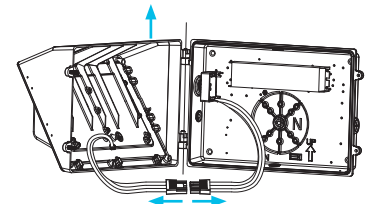

3 Open the fixture, disconnect the connection terminals, and remove the upper cover from the fixture.

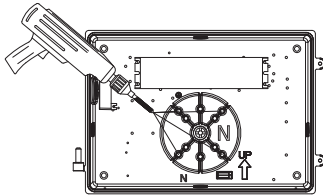

4A1: Drill through the mounting hole with an electric drill.

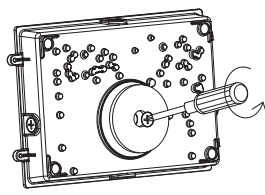

4A2: Attach an EVA cotton pad to bottom shell of fixture, use a screwdriver to remove the plug.

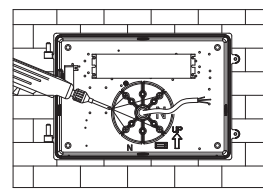

4A3: Attach the bottom shell on the mounting seat with screws.

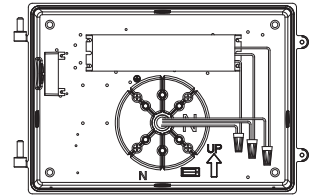

4A4: Connect positive, negative, and ground wires correctly.

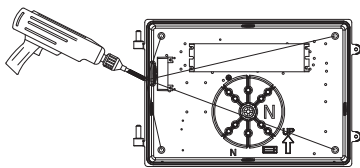

4B1: Drill through the mounting hole with an electric drill.

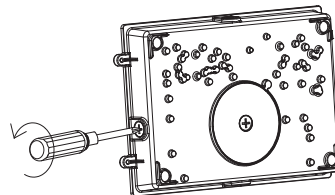

4B2: Use a screwdriver to remove the plug.

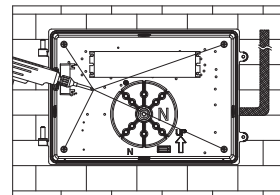

4B3: Attach the bottom shell on the mounting seat with screws.

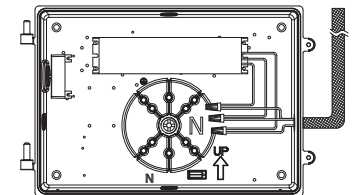

4B4: Connect positive, negative, and ground wires correctly.

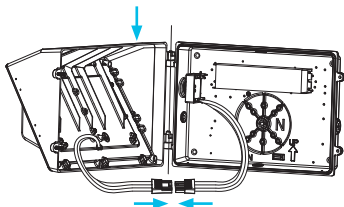

5 Reconnect the terminals.

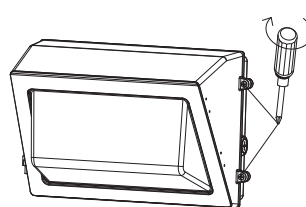

6 Close the front cover of the fixture and fix it with screws.

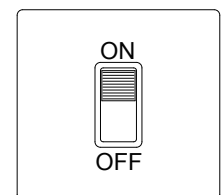

7 Turn power back on.

Function Adjustment

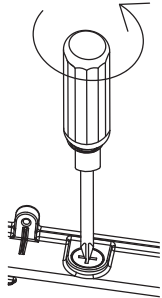

1 Open the switch control port with a screwdriver.

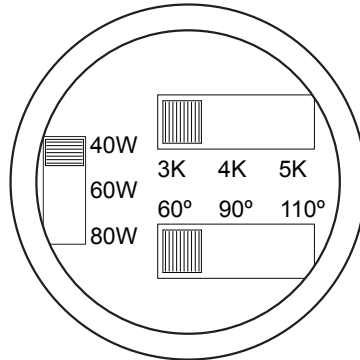

2 Adjust the function to your desired setting using the switches.

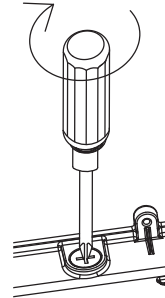

3 Replace the switch control port cap.

Photocell Activation

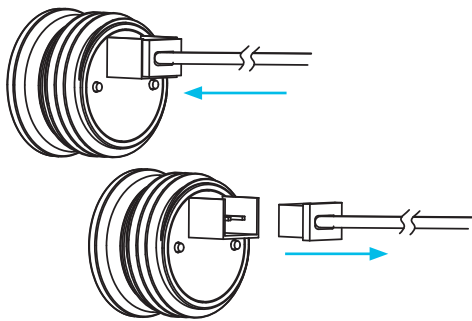

Photocell function is activated when connector is connected. Disconnection will deactivate the Photocell function.

Standard Wiring Diagram

