

! WARNING

1. To avoid electric shock, disconnect power at source prior to installation.
2. The installation should be performed by qualified electricians or lighting technicians.
3. Before installation, maintenance, or removal, disable all power.
4. Do not touch the fixture while it is in service.
5. If there is any problem with the fixture, turn off power and **DO NOT** attempt repair unless you are a qualified technician or the customer service member.
6. The fixture can be optionally equipped with an emergency function

Wattage Adjustability

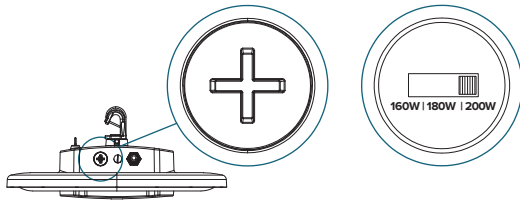

- 1 Remove plug, adjust the Wattage Switch to desired setting, and replace the plug.

Hook Mount Installation

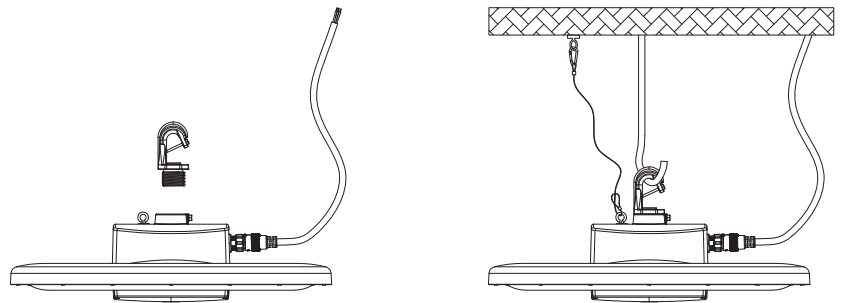

- 1 Screw mounting hook securely into fixture, then hang the fixture on a ceiling hook or chain.
- 2 After fixture is secure, connect wire to the mains, ensure the connection is stable before powering on.

Ceiling Mount Installation

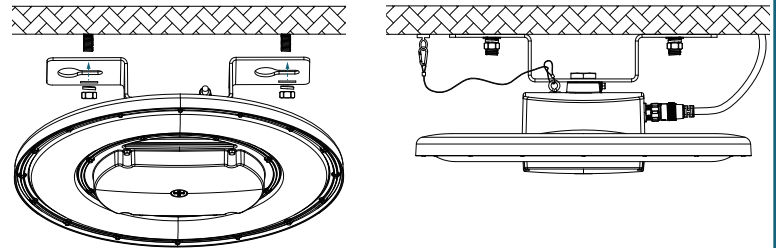
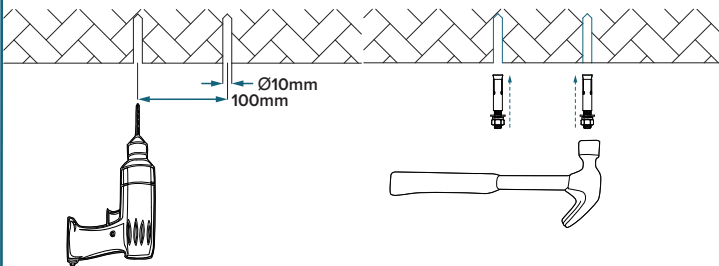

- 1 Mark with a pen or sharp tool on the mounting surface and drill two holes.
- 2 Use a hammer to fix screws into holes.
- 3 Align bracket holes with screw posts, push the fixture to one side and secure bracket to ceiling.
- 4 Connect Wires to the mains after fixture is secured.

Sensor Installation

- 1 Unscrew the 1/2" knockout at the bottom of the fixture using a screwdriver, insert sensor into opening and tighten the sensor by hand. Use remote or wireless application to program sensor.

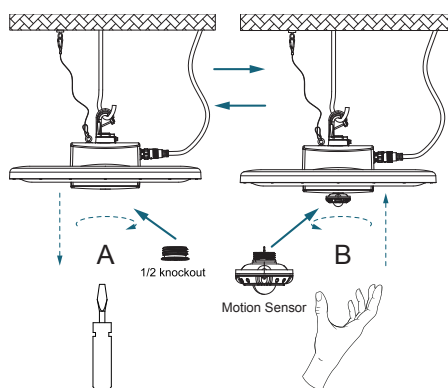

Wiring Diagram

