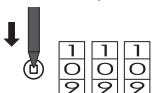
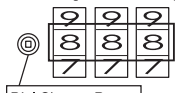
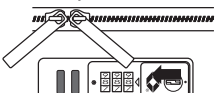

SETTING THE COMBINATION CODE

Follow the steps below to set a three-digit code that you find easy to remember.

- 
- 
- 
1. Remove the tabs from the slits following the instructions for using the dial lock (P. 8).
*Do not insert the tabs into the slits until the setup is complete.
 2. Turn the dials to your preferred numbers.
*Example is setting the combination code to 8-8-8
 3. Slide the unlocking slide lever in the direction of the arrow, then the dial change button will return to its original position. Setup is complete.

<CAUTION>

The dial change button cannot be pressed while the dials are locked. Be sure to reset the combination code to match the code you set yourself.

If you forget the combination code

If you forget the combination code, you can reset it using the included key by following the steps below.

1. Insert the key into the keyhole and turn the keyhole from the red dot (locked) to a vertical position. This will release the tabs.

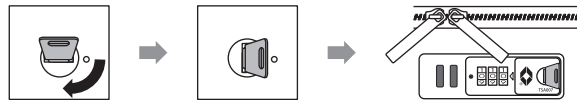

<CAUTION>

- When opening and closing with the key, make sure you insert it fully.
- Turning the lock with the key partially out may break the key.

2. Turn the key back to the original position (horizontal, in line with the red dot) and then remove the key.

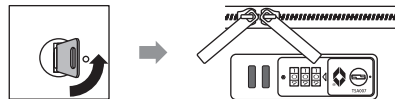

<CAUTION>

- The key must be returned to the original position before it can be removed.
- If the key is not returned to the original position, the tabs cannot be inserted into the slit.

<Other cautions>

- The included key is for unlocking the dial lock if you forget the combination number. It is not used for locking/unlocking the lock.

• You cannot reset your dial lock combination number if you forget it. Also, you cannot reset it using the key.

If you forget the combination code, it can be reset through a paid repair.

- The tabs can be inserted even when the dial is locked, so please take care.