

VET : High Temperature and High Humidity

Features

EDLC (Electric Double Layer Capacitor)

- High Power Density
- Over 500,000 cycle life (semi-permanent)
- Short-term Peak Power assist applications
- RoHS compliant
- Long-term reliability improved at high temperature and humidity

Drawing

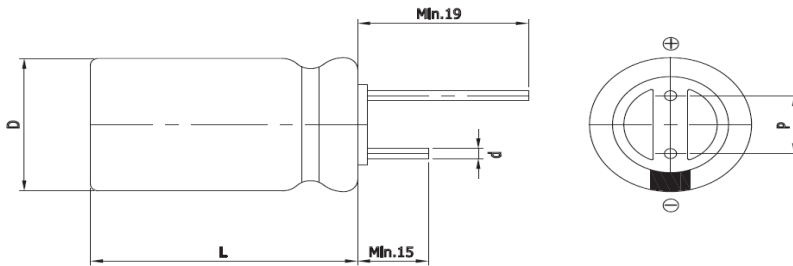

D (Φ)	8.0	8.0	10.0	12.5
L (mm)	20.0	30.0	30.0	25.0
d (Φ)	0.6	0.6	0.6	0.6
P (mm)	3.5	3.5	5.0	5.0

Specification

Item		Characteristics
Product series		EDLC
Rated Voltage (V _R)		2.7V
Operating Temperature		-40 ~ +85°C
Capacitance Tolerance		-10 ~ +30%
High Temperature & High Humidity Load Life		After 1,000 hours at V _R loaded under +85°C, 85%RH Humidity, capacitors meet the following criteria.
		Capacitance Change ≤ 30% of initial value
		ESR ≤ 3 times of specified value
Cycle Life Characteristics	Cycle	Over 500,000
	ΔC	≤ 30% of initial value
	ESR	≤ 3 times of specified value
	Method	Cycle of Charge/discharge from V _R to 1/2V _R
Shelf Life		2 Years No Electrical Charge, Temperature below 70°C (ΔC : ≤ 10% of initial value / ΔESR : ≤ 50% of specified value)

Part Number	Rated Voltage (V)	Capacitance (F)	ESR(mΩ)		Max. Current (A)	Leakage Current (mA, 72hrs)	Size (mm)
			AC(1kHz)	DC			D x L
VET 2R7 335 QG	2.7	3.3	55	95	3.0	0.007	8 x 20
VET 2R7 505 QG	2.7	5	40	60	5.0	0.020	8 x 30
VET 2R7 705 QG	2.7	7	35	50	8.5	0.025	10 x 25
VET 2R7 106 QG	2.7	10	32	48	9.0	0.030	10 x 30
VET 2R7 156 QG	2.7	15	30	45	12.0	0.045	13 x 25

VET : High Temperature and High Humidity

VET Supercapacitor

VINATech is the leading developer and manufacturer of Super Capacitors in the Smart Meter and IoT markets. Supercapacitors are a sustainable solution for provision of short term power in an array of different Smart Meter functions. **The New VET series, a high temperature series with high humidity withstanding benefits, adds to the long term benefit for AMR application.**

Why VET

- Endure High temperature(85°C) and High humidity(85% RH)
- High Energy Storage
- Long Cycle Life
- Fast Charge and Discharge
- Long Operational Life

AC-ESR(%)

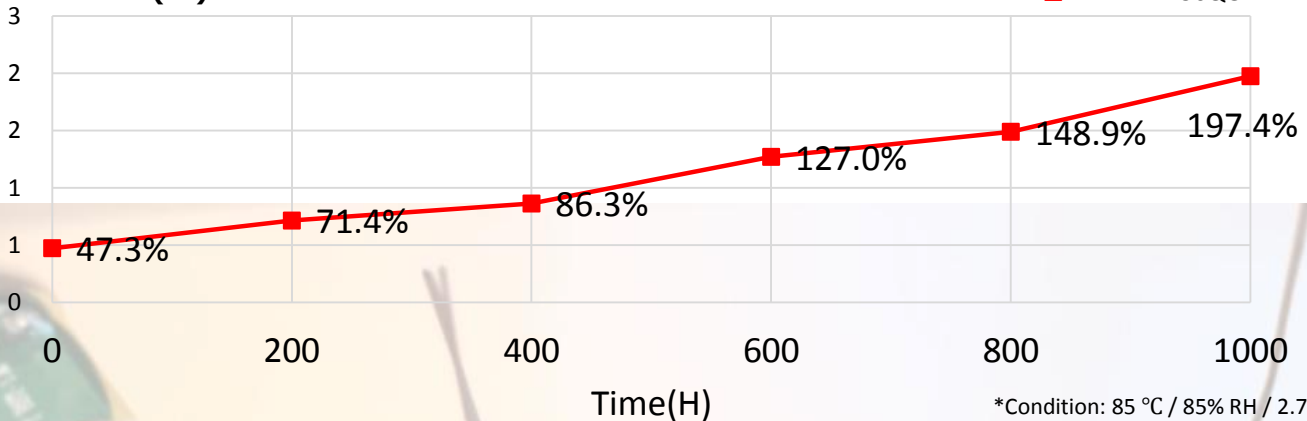

Capacitance(%)

