



1979-2023

THE WAREHOUSE

The Heart of Leeds for 40 Years

53.8008° N, 1.5491° W



EVENT SPACE & NIGHT CLUB VENUE PACK

CONTENTS

1. About us
2. What we provide
3. Costs
4. Tech spec
5. Floor plans
6. Lighting spec
7. Co-promotion
8. Marketing support
9. Contact details



ABOUT US

Proud to be at the heart of Leeds nightlife for 40 years.

- City Centre LS1 Venue
- 1,050 Person Capacity
- Up to 8 am Licence



WHAT WE PROVIDE

- Security & Bar Staff
- L'acoustics sound system
- DJ Equipment

Box Office, Ticket Management &
Event Management can be provided
at an additional cost.



TECH SPEC : SOUND

THE WAREHOUSE

- x6 L'acoustics Arcs (3 a side)
- x4 L'acoustics SB28 (2 a side)
- x2 L'acoustics LA12X Amplifiers
- x1 Midas M32 Console
- x1 Behringer Digital Mixer x32 Console
- x1 Midas DL32 Stage Box

MONITORS

- x4 HK LINEAR 5
- x2 HK PR:O 210
- CROWN XTi 6002 Amplifier
- CROWN XTi 4002 Amplifier
- (Maximum 4 mixes)

THE LOFT

- Allen & Heath iDR-4 processor
- Crown XLS1500 amplifier
- Crown XLS2500 amplifier
- Crown XTi2000 amplifier
- x4 DAP x-10
- x2 DAP x-15
- x2 DAP X18B
- RGB tube lighting system controlled via Madrix

LOAD IN & PARKING

Load in point is the yellow shutter situated to the left of the main entrance. There is no parking on Somers Street.

STAGE SIZE

- Width: 8M
- Depth: 2M or 4M
- Height: 0.55m

TECH SPEC : EQUIPMENT

LOAD IN & PARKING

Load in point is the shutter situated to the left of the main entrance. There is no parking on Somers Street.

STAGE SIZE

- Width: 8M
- Depth: 2M or 4M
- Height: 0.55m

DJ SETUP

- x4 Pioneer CDJ3000's
- x4 Pioneer CDJ2000NXS's
- x1 DJM A-9
- x2 Pioneer DJM900NXS
- x2 Technics 1210MK2

POWER

- 16a sockets available on stage
- x1 32a single phase socket available on stage
- x1 32a 3 phase socket available on stage
- 13a sockets around the venue
- Plenty of jumpers/distro boxes available

LIGHTING & EFFECTS

- x2 Chauvet Rogue Rx1 Led Wash
- x4 Chauvet Rogue R2x Led Spot
- x2 Showtec Stage Blinder4
- x8 Eurolite Led Bars
- x2 Chauvet Dj Intimidator Beam Wash
- x3 Martin Atomic 3000 Strobe
- x14 Elumen8 9RE Beam

SFX

- x4 Custom Built 6 Watt Lasers
- x2 Forcefx Co2 Jet Heads
- x1 Magicfx Superblaster confetti Cannon

SOUND/MICS

- x2 SHURE SM58 WIRELESS
- x6 SHURE SM58
- x6 SHURE SM57
- x2 SHURE BETA 52A
- x2 SHURE BETA 56A
- x2 SHURE BETA 91A
- x4 SHURE E604
- x2 SHURE KSM137
- x2 SHURE KSM32
- x1 SENNHEISER E935
- x1 SENNHEISER E945
- x1 SENNHEISER E609
- x8 AR-A33 ACTIVE DI BOXES
- AMPLE CABLES / CONVERTERS / XLR SNAKES

SCREEN

- Bespoke LED screen system
- Processor Novastar MX30
- Full Screen: 960x 6336
- x3 Strips: 192 x 6336 strips
-
- Ceiling-mounted screens: 960 x 4992px
- Rectangular angled section: 960 x 576px
- Behind DJ: 960 x 768px

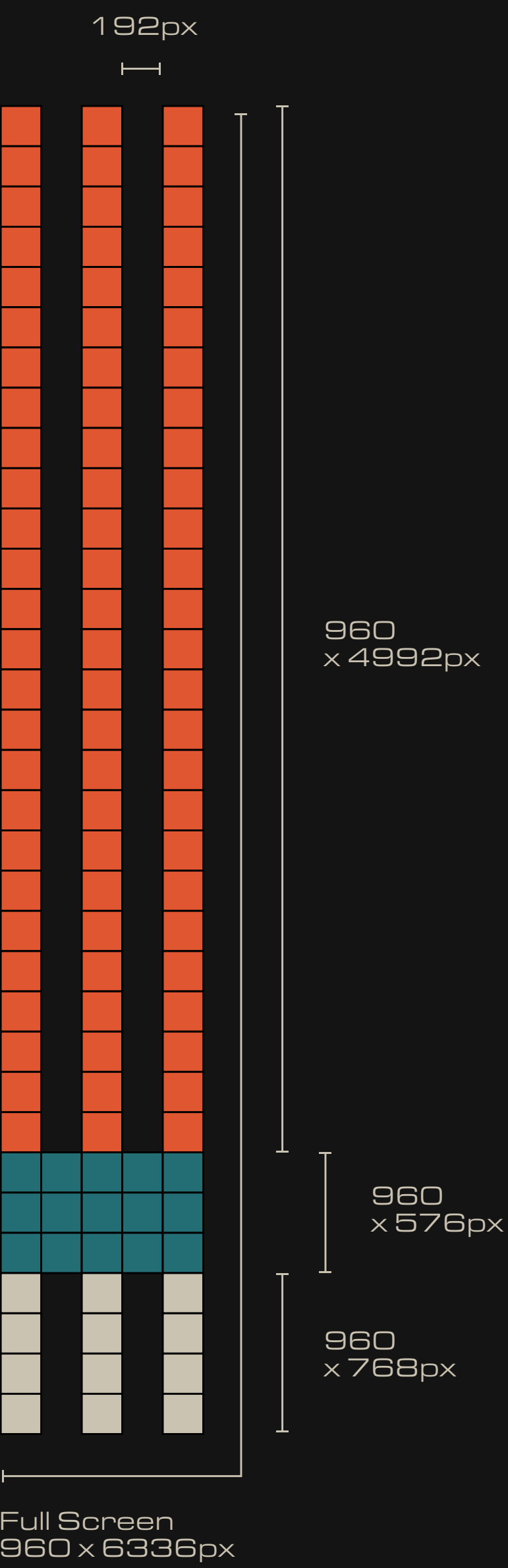

FLOOR PLAN : GROUND LEVEL

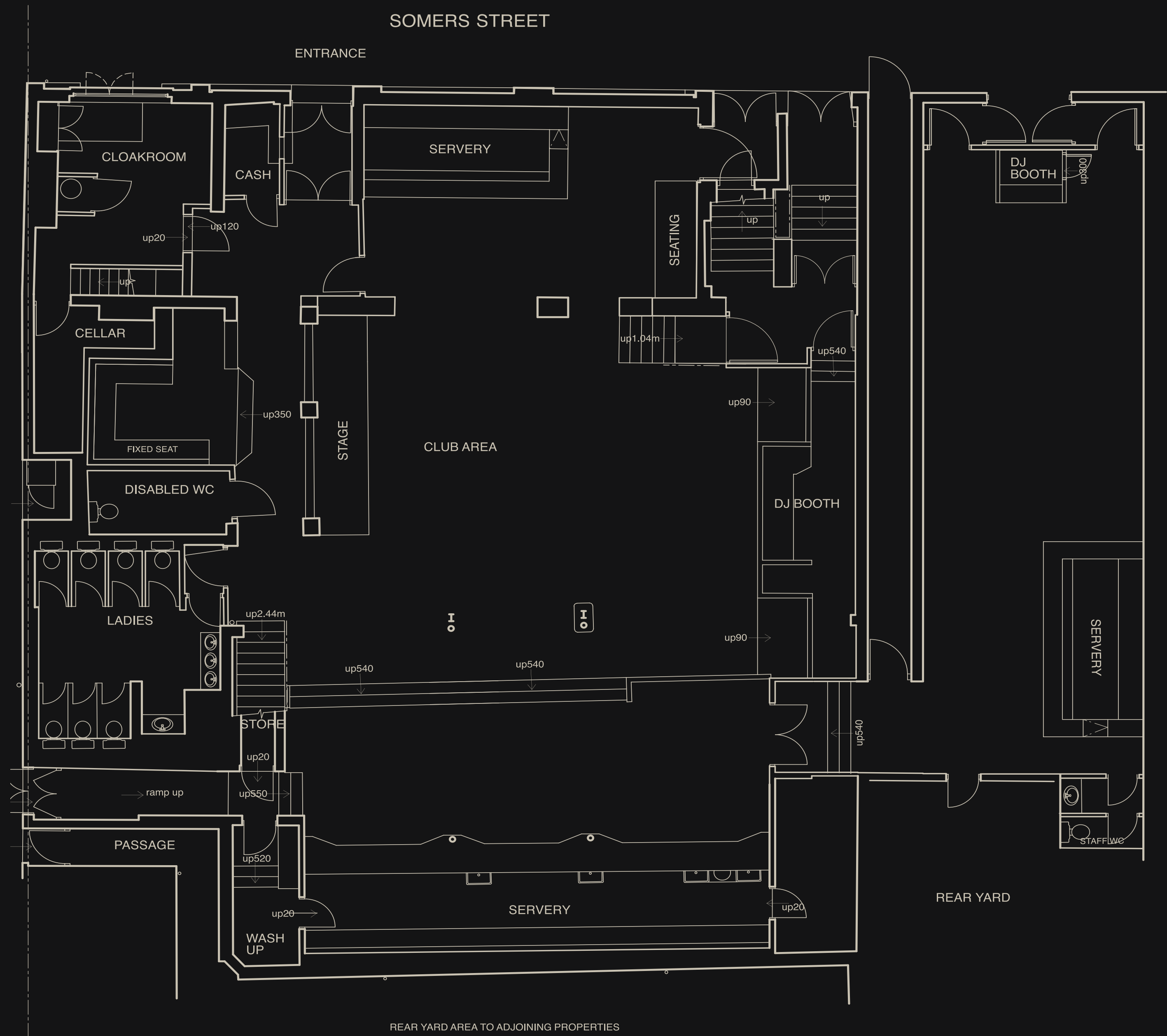

GROUND FLOOR PLAN
SCALE 1:100 @ A1

FLOOR PLAN : FIRST LEVEL



FIRST FLOOR PLAN
SCALE 1:100 @ A1



MARKETING ASSISTANCE

- Included in your booking
- Advertiser on The Venue Facebook Page & Instagram
- Co-Hosting of Events
- 3x Facebook Post & Instagram Posts
(If you provide engaging content we will provide more)
- Website Listing
- Monthly E-Flyer
- Physical Promotion
(can be provided on request at additional cost)



CO-PROMOTION

Running Wild. The creative minds behind UK tours Triple Cooked & Applebum are creative/marketing partners at The Warehouse.

If you want to expand your reach in Leeds becoming a partner with Running Wild could boost your presence in the city.

Each show is taken on a case by case. Reach out for an introduction.



CONTACT US

Kirk Allen
kirk@runningwild.co.uk
07724 415274

THE WAREHOUSE