

**COVID-19 Pinkneys Green Cricket Club (PGCC)  
Risk Assessment Form**

**July 2020**

**To play a match or train in the nets and/or practice at Pinkneys Green Cricket ground, please note the following:**

**You must**

- Be a paid-up member of Pinkneys Green Cricket Club (players not paid up will not be allowed to participate) or a bona-fide member of the visiting team.
- have reserved your place in advance or for a match register your details for track n trace for a 21-day period (abiding to GDPR rules)
- sign the form that you have read and agree with the ECB /PGCC rules and that you will comply fully with them; (ECB guidelines will be a link on the form and by submitting the form you are agreeing to conform to / abide by the ECB/PGCC guidelines)
- not come to matches or training sessions if you are symptomatic of COVID-19, living in a household with a possible COVID-19 infection or if you are classified as extremely vulnerable on health grounds
- not be 'self-isolating'
- comply with Government Guidelines for the health and safety of all
- always stay at least two metres apart or one + metre during match play from others (who are not from your own household)
- understand that if you do not comply with these rules that you will not be permitted to play matches or come to another training session
- Where there is a conflict between the 2 sets of rules/ guidelines, The ECB/Govt. guidelines takes precedence.

Only a maximum of 30 people can play a match or train together if they are not from the same household, with one coach supervising each group of 30. Spectators must socially distance away from the pavilion in max group of 6. Everyone who enters the pavilion must sign in for track n trace purposes.

**If a case of COVID-19 is traced back to the Club, we will be required to close immediately.**

**Pinkneys Green CC nets / grounds are only accessible to those with agreed match fixtures or valid bookings made in advance of attendance.**

| <b>Event Name:</b>                                  | <b>Outdoor Nets practice</b>  | <b>Date:</b>  | <b>Various</b>  | <b>Pinkneys Green Cricket Club</b>                      |
|---|---|---|---|---|
| <b>(1)<br/>Activity / Area of Concern</b>           | <b>(2)<br/>Hazards Identified</b>   | <b>(3)<br/>Persons at Risk</b>  | <b>(4)<br/>Actions to be taken to minimise each risk</b>  | <b>(5)<br/>Person responsible</b>                       |
| i.e. what is taking place as part of the event?     | i.e. what can cause harm?   | i.e. who could be harmed by the hazard and how?   | i.e. Do you need to do anything else to manage this risk?   | i.e. who is responsible for taking the necessary action |
| Managing Arrival and Leaving Times – Booking system | <p>Transference of COVID-19 due to different groups of people being in close contact with each other at gate / car parking areas / nets / on outfield</p> <p>Too many people arriving to practise at once</p> | Groundsman, volunteers, contractors, company reps on site, and Club members visiting site to practise and all household members | <p>Matchday register (name, phone, email from 1 per household kept locally for 21 days) of players, coaches &amp; officials for match fixtures and online booking system in place which respects GDPR laws to manage access and to control demand and to support contact tracing / staggered aged group arrival and leaving times / Maximum of 30 (for matches) or 30 persons per group for training / maximum length of session = 1.45 hours (Junior sessions) ,15 minutes between sessions to reduce or avoid cross over / advise members to arrive on time, not early / Members must not overstay allocated time slot / Members must not stay to socialise / Members must be clear of the nets and zone areas before the next users arrive</p> | Club members Match / Session Manager                    |

|  |   |  |  |                                  |
|--|---|--|--|----------------------------------|
|  |   |  | / Parents and Guardians to remain at the ground throughout the session / One way system in place - personal kit bags / water etc be kept within car or in open space in front of pavilion  |                                  |
| Unlocking pavilion at for emergency use  | Transference of COVID-19 via lots of different people touching metal surfaces, e.g. doors, alarm pad, and padlocks causing illness                  | Session Manager  | Controlling access to and from pavilion. Cleaning of padlocks, alarm pad and areas of doors being touched. Only match / session manager to touch padlock, alarm pad, internal & external doors.  | Match / Session Manager          |
| Compliance with ECB rules / PGCC rules   | Transference of COVID-19 due to non-compliance with rules   | Groundsman, volunteers, contractors, company reps on site and Club members visiting site to practise and all household members | Only paid up Members or bona-fide members of visiting teams with a valid match fixture or advance net / training booking may play in group sessions.   | Booking Organiser / Club Members |
| People who have coronavirus symptoms – high temperature >37.8°C and/or persistent cough and / or breathing difficulties / loss of smell / loss of taste. | Transference of COVID-19 due to different groups of people being in close contact with each other at gate / car parking areas / nets / on outfields | Groundsman, volunteers, contractors, company reps on site and Club members visiting site to practise and all household members | Members must not attend matches or book practice sessions if they are symptomatic, living in a household with a possible COVID-19 infection or if they are classified as extremely vulnerable on health grounds<br><br>No-one feeling unwell or with a high temperature or any other COVID-19 symptoms allowed on the ground | Club members                     |

Pinkneys Green Cricket Club COVID-19 Risk Assessment V3 – amended 220720

|   |   |  |  |  |
|---|---|--|--|--|
| Car Parking   | Transference of COVID-19 due to different groups of people parking their cars too close to each other                           | Groundsman, volunteers, contractors, company reps on site and Club members visiting site to practise and all household members | People must park with sufficient space between them and the next vehicle<br><br>Members should avoid arriving at Pinkneys Green CC via Public Transport if possible                            | Club members<br><br>Session Manager to oversee         |
| Use of Nets / Outfields   | Transference of COVID-19 due to different groups of people being in close contact with each other at nets / on outfields        | Groundsman, volunteers, contractors, company reps on site and Club members visiting site to practise and all household members | Booking system / staggered age group usage / Only one net to be used / mobile net<br><br>Social distancing of at least 2 metres to be always maintained (unless members of the same household) | Club members<br><br>Session Manager to oversee         |
| Change of users of nets and ground  | Air needs time to clear<br><br>Transference of COVID-19 via lots of different people touching metal / plastic / wooden surfaces | Groundsman, volunteers, contractors, company reps on site and Club members visiting site to practise and all household members | Sanitise stumps / side poles of nets, etc. – sanitising spray to be provided.<br><br>No hand shaking / no high fiving / no greeting kisses, etc.   | Session Manager to use spray                           |
| Personal Cleanliness  | Transference of COVID-19  | Groundsman, volunteers, contractors, company reps on Site and Club members visiting site to practise and all household members | Wash hands at home before and after using outdoor facilities at Pinkneys Green CC / avoid touching face / sneeze or cough into elbow or tissue and then throw tissue immediately into bin      | Club members<br>Match / Session Manager to oversee     |
| Hand Sanitiser<br>(Note: hand sanitisers should be greater than 60% alcohol (but ideally > 70% alcohol) to help prevent transfer of COVID-19) | Transference of COVID-19  | Groundsman, volunteers, contractors, company reps on site and Club members visiting site to practise and all                   | Net and age group users to bring own hand sanitiser and use before and after net session and own alcohol wipes for cleaning / Hand sanitiser to be available from                              | Club members<br><br>Match / Session Manager to oversee |

Pinkneys Green Cricket Club COVID-19 Risk Assessment V3 – amended 220720

|   |  |  |  |   |
|---|--|--|--|---|
|   |  | household members  | Match/Session Manager also at cleaning station<br><br>Bins without lids but with bin-liners to be provided   |   |
| Touching / Leaning against Net structure  | Transference of COVID-19 via lots of different people touching metal / plastic / wooden surfaces | Groundsman, volunteers, contractors, company reps on site and Club members visiting site to practise and all household members | Do not touch or lean against Net structure unnecessarily<br><br>Avoid touch points where possible / Only Session managers to touch zonal cones and other equipment                                       | Club members<br><br>Match / Session Managers to oversee |
| Social Distancing -<br><br>Greater than 2 metres apart minimum or 1+ during match play (unless from the same household) | Transference of COVID-19   | Groundsman, volunteers, contractors, company reps on site and Club members visiting site to practise and all household members | Players, coaches, and everyone must always remain at least 2m apart or 1+ during match play  | Club members<br>Match / Session Manager to oversee      |
| Batsman / Bowler Change Over in nets (unless from same household)   | Transference of COVID-19   | Groundsman, volunteers, contractors, company reps on site and Club members visiting site to practise and all household members | Take care to remain at least 2m apart and not handle the same items  | Club members<br>Match / Session Manager to oversee      |
| Dehydration / Hunger  | Feeling tired or unwell due to lack of food and water  | Groundsman, volunteers, contractors, company reps on site and Club members visiting site to practise and all household members | Clubhouse / Pavilion strictly limited so limited access to drinking water<br><br>Bring own water in a labelled bottle / Bring own food / Take bottles, food, and all rubbish away after training session | Club members<br>Match / Session Manager to oversee      |
| Sharing of Equipment, e.g.  | Transference of COVID-19   | Groundsman, volunteers, contractors,   | Use own equipment. No sharing of   | Club members<br>Match / Session                         |

Pinkneys Green Cricket Club COVID-19 Risk Assessment V3 – amended 220720

|  |  |  |  |   |
|--|--|--|--|---|
| bats, pads, gloves, helmets                                  |  | company reps on site and Club members visiting site to practise and all household members                                      | equipment outside of household members   | Manager to oversee                              |
| Cricket Balls  | Transference of COVID-19 via spitting on balls / using sweat on balls                            | Groundsman, volunteers, contractors, company reps on site and Club members visiting site to practise and all household members | During match play the match ball must be sanitized every 6 overs or 20 minutes whichever comes. For training/net sessions bring own balls / <u>no saliva or sweat should meet the ball at any time</u> / clean balls at home after use. Each person's ball should be marked with their name. | Club members Match / Session Manager to oversee |
| Bowling machines   | Transference of COVID-19 via lots of different people touching metal / plastic / wooden surfaces | Groundsman, volunteers, contractors, company reps on site and Club members visiting site to practise and all household members | Bowling machines locked away and not available   | Head of Cricket                                 |
| Running down the net lane (if not from the same household)   | Transference of COVID-19 via Bowler getting too close to batsman                                 | Club members using site to practise and their household members  | Bowler to only go down as far as their run up follow through. Batter to return ball back from net by kicking / knocking it back  | Club members Match / Session Manager to oversee |
| Litter / Rubbish   | Transference of COVID-19 via touching contaminated rubbish / litter                              | Groundsman, volunteers, and Club members visiting site to practise and all household members                                   | Encourage people to take litter home / Put out bins by nets & Pavilion / Bins to have bin-liners but no lids   | Club members Match / Session Manager to oversee |
| Someone gets ill or injured during match or practice session | Lack of medical assistance<br><br>Transference of COVID-19                                       | Club members visiting site to practise   | Member to go home / ring 111 or 119 if Covid-19 related / go to GP / A&E or call   | Club members Match / Session Manager to oversee |

|   |   |  |   |  |
|---|---|--|---|--|
|   |   |  | <p>for medical assistance as above</p> <p>Cleaning station available.</p> <p>First Aid station available (with First Aid Kit) <u>but not a trained First Aider</u></p>  |  |
| Leaving Personal belongings at Club                           | Transference of COVID-19 via touching contaminated personal belongings  | Groundsman, volunteers, and Club members visiting site to practise and all household members | <p>Leave <u>nothing</u> behind – equipment / sanitiser / sun cream / water bottles / food packaging. Any articles left behind including shoes and clothing will be disposed of.</p>   | Club members                                   |
| Clubhouse / Tea Pavilion / Toilets / Showers / Changing Rooms | Transference of COVID-19 via lots of different people touching metal / plastic / wooden surfaces and subsequent need for cleaning | Groundsman, volunteers, and Club members visiting site to practise and all household members | <p>Access to Clubhouse / Pavilion / Toilets / Changing Rooms / Bar/ via a strict one-way system with clear floor marking. All doors (and windows if possible) will be open at all times of access. All internal facilities to remain strictly limited to one person in the toilet plus one member of bar staff and one customer. They shall always maintain 2 metres distance. Toilets in use will be cleaned at the end of the day's use when the pavilion is open and a DEEPCLEAN once per week. All users of the toilets shall wipe the toilet flush handle/contact points down with sanitiser after use</p> | Match Manager, Team Captain or Session Manager |

|                              |   |   |   |          |
|------------------------------|---|---|---|----------|
|                              |   |   | <p>and the toilet door handle. Strict hygiene measure must be observed in the toilet including handwashing for every user post use in accordance with government guidelines.</p> <p>Members to use every effort to use own toilet facilities <u>before</u> arriving at ground / Pavilion will be available for very limited access only</p>   |          |
| Bar Staff service guidelines | Transference of COVID-19 via lots of different people touching metal / plastic / wooden surfaces and subsequent need for cleaning | Volunteers and Club members visiting site to practise and all household members | <p><b>Queue for the bar to be formed allowing for the 2 metre rule observing social distancing in accordance with government guidelines.</b></p> <p>Signage to be displayed.</p> <p>Bar staff should wear a mask or face covering if asked to do so. Good hygiene principles should always be maintained. This includes regular washing of hands and drinking glasses/vessels. The drinks should be poured and then placed on the bar after which the barperson should step back at least 1 metre and allow the customer to take their drinks.</p> <p><b>Contactless payment only taken unless facility unavailable</b></p> | Chairman |



Pinkneys Green Cricket Club COVID-19 Risk Assessment V3 – amended 220720

|   |  |  |   |   |
|---|--|--|---|---|
| BBQ service guidelines                          | Transference of COVID-19 via lots of different people touching metal / plastic / wooden surfaces and subsequent need for cleaning  |  | No BBQ's until further notice   | Chairman  |
| Preparation of nets / mobile nets / zonal areas | Transference of COVID-19 via transmission of balls to other nets<br><br>Risk of injury   | Club members visiting site to practise and their household members   | Clear debris from nets / Zone areas / check run ups are safe / Cable tie all holes and check at end of session for new holes<br>Repair if any new holes found with cable ties                         | Match / Session Manager                         |
| Chairs / Benches / Club House steps             | Transference of COVID-19 via lots of different people touching metal / plastic / wooden surfaces and because people may congregate in prohibited groups / sitting on the steps of pavilion | Groundsman, volunteers, and Club members visiting site to practise and all household members                                   | Bring own chairs and remove when finished / no sitting on pavilion steps  | Players, Spectators, Parents and Guardians      |
| Groundsman / Other Contractors and Volunteers   | Transference of COVID-19 via contact with people from outside their households   | Groundsman, volunteers, contractors, company reps on site and Club members visiting site to practise and all household members | Members to <u>avoid approaching Groundsman</u> / other contractors as far as possible to minimise risk to them and their families<br><br>Social distancing of not less than 2 metres to be maintained | Club members Match / Session Manager to oversee |
| Pets  | Transference of COVID-19 via too close contact between owners and other Club members   | Groundsman, volunteers, contractors, company reps on Site, the public and Club members visiting site to practise               | Members to keep their pets under control on a lead always and remove any dog waste from ground when leaving site  | Club members Match / Session Manager to oversee |

|              |  |  |  |  |
|--------------|--|--|--|--|
|              |  | and all household members  |  |  |
| Coaching     | Transference of COVID-19 due to different groups of people being in close contact with each other at nets / on outfields | Groundsman, volunteers, contractors, company reps on site and Club members visiting site to practise and all household members | Coaching sessions may only be delivered with a maximum ratio of 1 to 5 (per ECB stipulation).<br><br>No external coaches permitted to use the nets   | Match / Session Managers<br><br>Committee Members  |
| Review Cycle | Transference of COVID-19 via too close contact between Club members due to non-compliance of rules                       | Groundsman, volunteers, contractors, company reps on site and Club members visiting site to practise and all household members | Review & debrief of compliance with rules at end of Day 1 and Day 7 via discussion with Match/Session Managers<br><br>Booking system / Session managers to stay in place until ECB Guidance is changed | Match Managers<br><br>Session Managers<br><br>Committee Members<br><br>Executive Committee |

**Notes for all visitors to Pinkneys Green CC:**

- Undergo a personal symptom check at home – stay away if any symptoms demonstrated
- Ensure you follow the one-way system in place within the pavilion (diagram below)
- Sign the register on arrival and departure for track n trace purposes (please bring your own pen)
- No changing rooms are open until further notice
- Come changed and ready for cricket, use your own equipment throughout and sanitize bat when leaving field of play
- Bring your own hand sanitizer
- Bring your own drinks/food
- Sanitize your kit when finished
- No sweat or saliva to be applied to cricket balls. Hands and balls to be sanitized every 6 overs during the game
- Players to remain socially distanced at all times (wicket keepers and slip fielders at 1m+)
- Batters to run in distinct marked running lines to ensure they are not within 2m of the bowler or other batter
- Maximum participant size of 30 including players, coaches, and officials
- Spectators must socially distance away from pavilion and in maximum groups of 6.

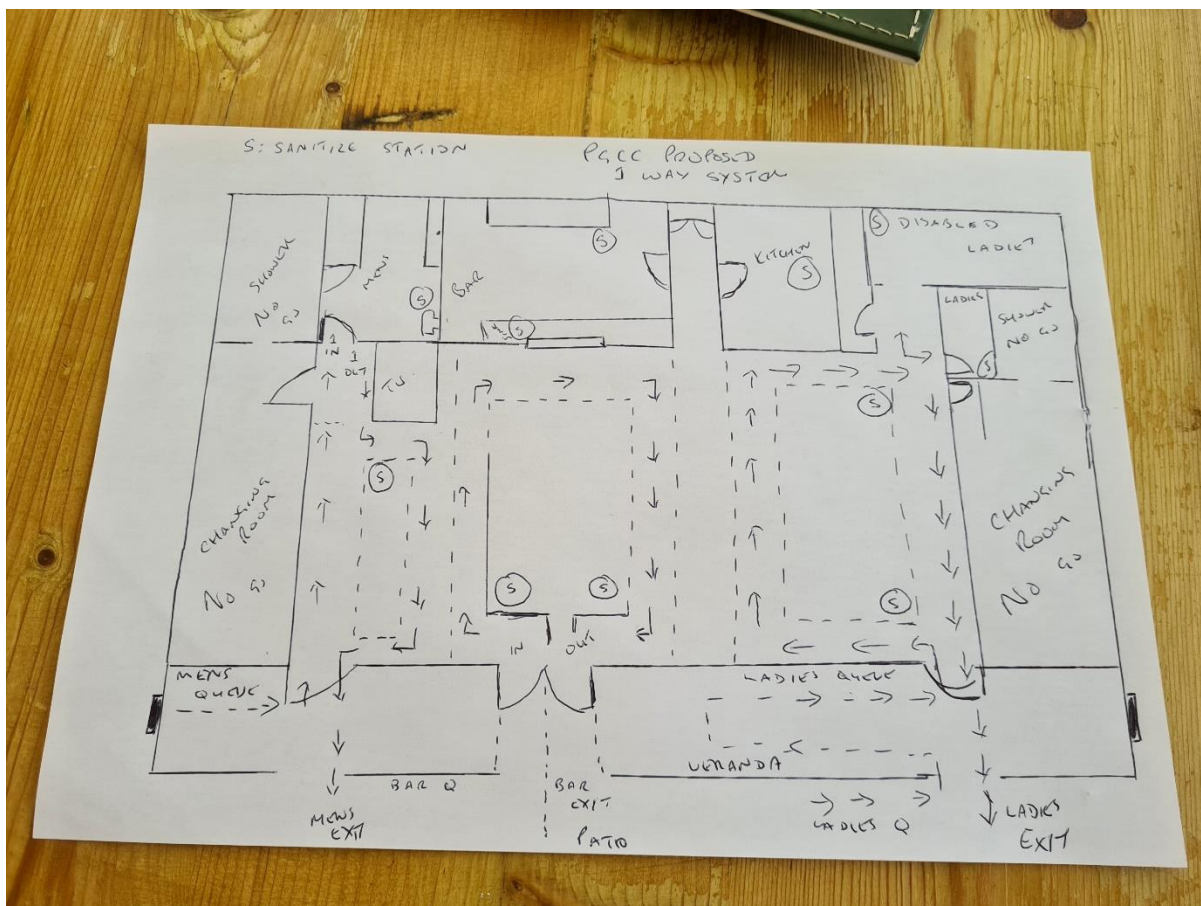

Undergo a personal symptom check prior to matches - do not take part if you demonstrate COVID-19 symptoms



Use own equipment throughout where possible and clean bat when leaving field of play



No sweat or saliva is to be applied to the ball at any time. Hands and the ball should be cleaned at all breaks in play and every 6 overs



Players to remain socially distanced at all times  
(Wicket keepers and slip fielders at 1m+)



Use of the clubhouse, changing rooms and toilets should adhere to the latest UK Government advice



Keep a record of all those in attendance at each session, including contact details



Social distancing should be maintained during wicket celebrations and drinks breaks



Batters are to run in distinct marked running lines to ensure they are not within 2m of the bowler or other batter