



In the lead up to the 2015 World Cup, AKRFC intend to increase the number of players at the club especially in the age range 14 to 24.

This shall be achieved by improving the quality of experience for all users of the club and improving the financial sustainability of the club based on a wider range of business and social users.

To support these outcomes, the club has two target markets:

Firstly, we wish to attract more parents and especially mothers to the club on Sundays to support the development of mini and junior rugby.

Secondly we wish to attract more use of the facilities for a wider range and number of functions.

2015 provides rugby union with a once in a generation opportunity to deliver the greatest participation legacy for the game in this country. RFU's Lead Up & Legacy Capital Programme will provide matching grants of £10,000 towards projects that refurbish and transform the social spaces.

We need your help to receive the grant

Please log onto the following web page

<https://www.surveymonkey.com/s/VVJYWV3>

and complete the survey before 19th March 2014



England
Rugby

ALTRINCHAM



KERSAL
R.F.C.

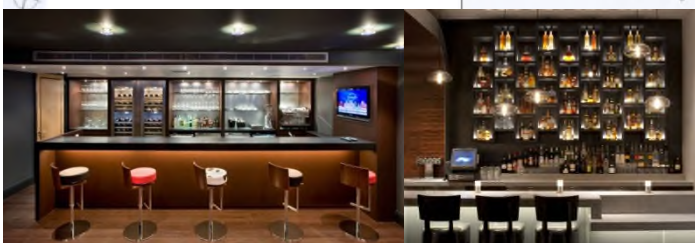
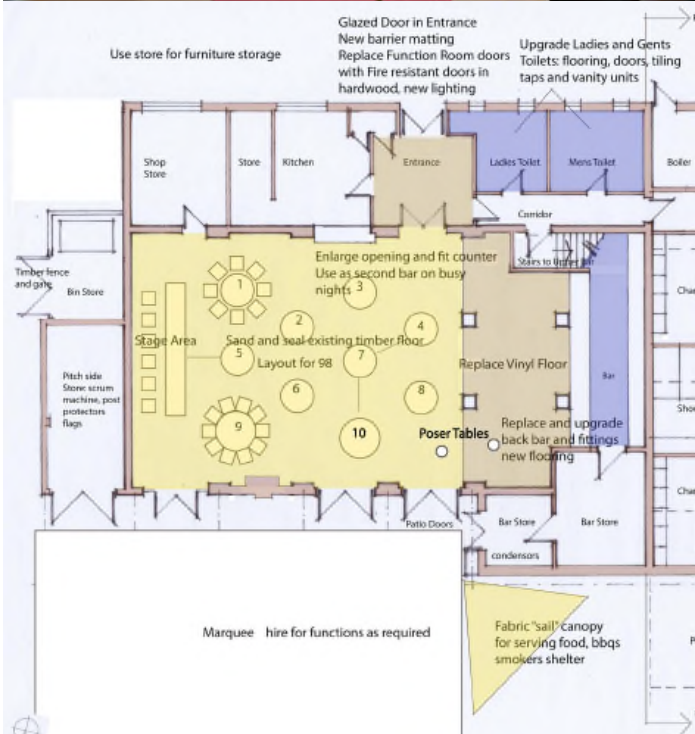

To transform our social facilities improvements shall include the following:

- Upgrade the main entrance with new doors, lighting and flooring
- Upgrade the toilets with new floors, sanitary ware, tiling and doors
- Upgrade the bar with new back bar, improved appliances, new lighting and new flooring
- Widen the counter for serving food
- Replace the function room vinyl flooring and reseal the timber floor
- Provide new furniture for flexible use of the space and functions
- Provide a covered canopy on the pitchside of the building for bbqs, serving post match food and as a shelter for smokers.



We need your help to receive the grant

Please log onto the following web page

<https://www.surveymonkey.com/s/VVJYWV3>

and complete the survey before 19th March 2014