

PN10 Bronze Draining Taps

Bronze draining taps are suitable for use on hot and cold water up to 10bar, at temperatures up to 110 degrees Celsius. The inlet is a threaded taper male connection to BS21, the outlet is ribbed for hose connection. WRAS Approved.

Materials

Part	Material	Size
1 Body	Bronze BSEN1982 CC491K	All
2 Gland	Brass BSEN12164 CW614N	All
3 Stem	Brass BSEN12164 CW614N	All
4 Washer Plate	Brass BSEN12164 CW614N	All
5 Washer	Ethylene Propylene	All
6 'O' Ring	Ethylene Propylene	All
7 Nut	Brass BSEN12164 CW614N	All



Dimensional Drawing

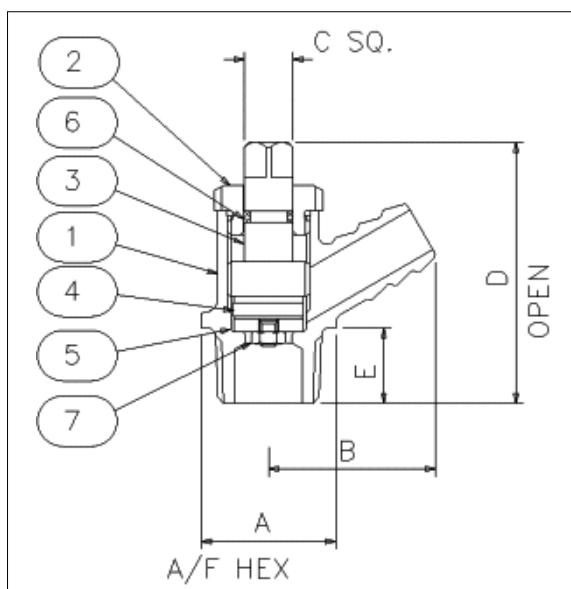

Dimensions and Weights

Size	Weight (kg)	A (mm)	B (mm)	C (mm)	D (mm)	E (mm)
1/2"	0.12	24.6	33.8	7.7	59.9	15.2
3/4"	0.34	32.4	47.9	8.4	79.8	17.2
1"	0.58	40	62.5	9.5	87.9	20.3

Specification

Sizes 1/2" and 3/4" draining taps are designed and manufactured in accordance with BS2879 type 2.

This valve is excluded from the requirements of the Pressure Equipment Directive 97/23/EC, Article 1 - 3.20.

Temperature operating range: 0 to 110 degrees celsius.

Pressure Rating: PN10

UK End Connection: BS21 Taper Male

US End Connection: Not Specified

Operating Instructions:

Loose key operation