

Geberit Duofix element for washbasin, 82–98 cm, deck-mounted tap, wall anchoring

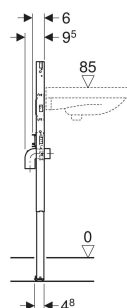
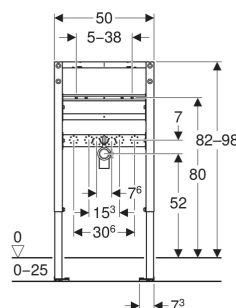

APPLICATION PURPOSES

- For metal and wood frame walls
- For Geberit Duofix system walls
- For installation in part-height prewalls
- For floor constructions 0–25 cm
- For installation of washbasins
- For deck-mounted taps

CHARACTERISTICS

- 2025 range
- Statically self-supporting frame, protected against corrosion with powder coating
- Alternative fastening point for wall anchors
- Rotating foot plates, suitable for installation in U profiles UW 50 and UW 75
- Foot plates that can be mounted in Geberit Duofix system rail without tools, without additional components

- Galvanised non-slip leg supports protected against corrosion
- Fastening distance for washbasin 5–38 cm
- Threaded rods adjustable in depth with 18 or 28 cm fastening distance
- Fastening for connection bend, height-adjustable and sound-absorbing
- Crossbar for tap adjustable in height and depth
- Self-adhesive sealing washer, fleece-laminated
- Protection plug for one-time pressure test with cold water up to a maximum of 15 bar / 1500 kPa

TECHNICAL DATA

Product material Steel

SCOPE OF DELIVERY

- 2 angle stop valves 1/2"
- 2 elbow tap connectors Rp 1/2" / R 1/2", compatible with MF

- 2 sealing washers
- 2 wall anchors
- Fastening and protection material

ACCESSORIES

- Geberit Duofix set of wall anchors for single installation, corner construction
- Geberit Duofix set of wall anchor extensions
- Geberit Duofix system fastening bracket
- Geberit Duofix set of foot fastener on rear wall
- Geberit Duofix set of foot extensions 20 cm length
- Geberit Duofix fastening for washbasins with fastening distance 38–58 cm
- Geberit sound insulation set for washbasin

Art. no.	B cm	H cm	T cm	
111.494.00.2 New	50	82-98	6	

New article available from 01.05.2025