

# AQUALISA

# TAPS

A great shower deserves a great tap



#ObsessedWithShowers<sup>TM</sup>

## Components

### Small pillar tap



### Large pillar tap



### Deck mounted bath filler tap



# Important information

## Safety information

This product must be installed by a competent person in accordance with all relevant current Water Supply and Building Regulations.

This product is suitable for domestic use only.

Aqualisa taps are supplied complete with a 5 year guarantee.

## Flushing

Some modern fluxes can be very corrosive and, if left in contact, will attack the working parts of this unit. All soldering must be completed and the pipe work thoroughly flushed out in accordance with current Water Supply Regulations prior to connection of the product.

## Isolating valve

Suitable full way isolation valves such as gate valves must be fitted to both supplies in accordance with the Water Supply Regulations and our terms of warranty.

Due to their restrictive characteristics, stopcocks and ball type valves that reduce the bore size must not be used on gravity installations.

## Pressures

This product is designed to control static pressure up to 10 bar. Where pressures are likely to exceed 10 bar a pressure reducing valve must be fitted into the incoming mains supply. A setting of 3 bar is recommended. It should be noted that daytime pressures approaching 8 bar can rise above the stated maximum overnight. For optimum performance, the following minimum pressures are recommended.

Minimum inlet pressure:

Small Pillar Tap: 1.0 bar

Large Pillar Tap: 1.0 bar

Deck Mounted Bath Filler: 1.0 bar

For optimum performance hot and cold pressures should be equal.

A suitable PRV is available from Aqualisa, if required.

\* Not suitable for mixed water supplies, i.e gravity hot/ cold mains

## Installation

The product must not be used with a hot water supply temperature of over 65° C.

The hot supply should be on the left when viewed from the front of the fitting.

## Cleaning

Your Aqualisa taps should be cleaned using only a soft cloth and washing up liquid.

DO NOT USE ABRASIVE CLEANERS

# TAPS

A great shower deserves a great tap

## Small pillar tap installation



In addition to the guide below it is essential that the important information section is read and understood and that you have all the necessary components before commencing installation. Failure to install the product in accordance with these instructions may adversely affect the warranty terms and conditions. Do not undertake any part of this installation unless you are competent to do so. Prior to starting, ensure that you are familiar with the necessary plumbing regulations required to install the product correctly and safely.

1

Fit cover plate (2) at base of tap.

2

Fit the two rigid extensions (8) into the body of tap.

3

Fit the flexible hoses (7) into the rigid extensions inlets and tighten using a suitable tool, taking care not to overtighten.

4

Place the fixing bolt (5) into the tap body and secure using a screwdriver in the machined slot.

5

Feed the flexible hoses through the hole in the mounting surface and offer the mixer tap into position.

6

Feed the fixing washer (4) and fixing plate (3) onto the fixing bolt and secure to the underside of the mounting surface using a suitable tool. Ensure correct alignment of the mixer tap over the basin.

7

Connect flexible hoses to the supply inlets ensuring washers are fitted and tightened firmly.



## Small pillar taps components

Small Pillar Tap (1)

Cover Plate (2)

Fixing Plate (3)

Fixing Washer (4)

Fixing Bolt (5)

Fixing Nut (6)

1/2" Flexible Hoses (7)

Rigid Extensions (8)

Flow regulator 5 lpm (9)

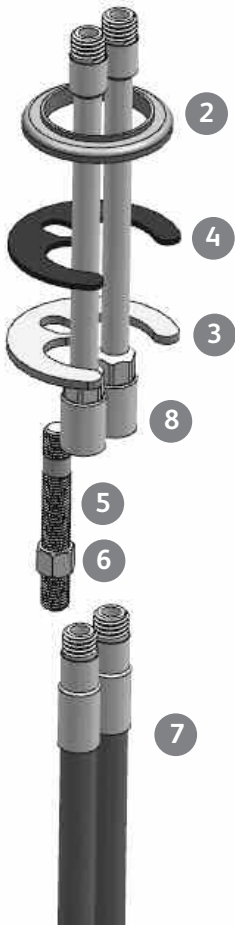

# TAPS

A great shower deserves a great tap

## Large pillar tap installation



In addition to the guide below it is essential that the important information section is read and understood and that you have all the necessary components before commencing installation. Failure to install the product in accordance with these instructions may adversely affect the warranty terms and conditions. Do not undertake any part of this installation unless you are competent to do so. Prior to starting, ensure that you are familiar with the necessary plumbing regulations required to install the product correctly and safely.

1

Fit cover plate (2) at base of tap.

2

Fit the two rigid extensions (8) into the body of tap.

3

Fit the flexible hoses (7) into the rigid extensions inlets and tighten using a suitable tool, taking care not to overtighten.

4

Place the fixing bolts (5) into the tap body and secure using a screwdriver in the machined slot.

5

Feed the flexible hoses through the hole in the mounting surface and offer the mixer tap into position.

6

Feed the fixing washer (4) and fixing plate (3) onto the fixing bolts and secure to the underside of the mounting surface using a suitable tool. Ensure correct alignment of the mixer tap over the basin.

7

Connect flexible hoses to the supply inlets ensuring washers are fitted and tightened firmly.

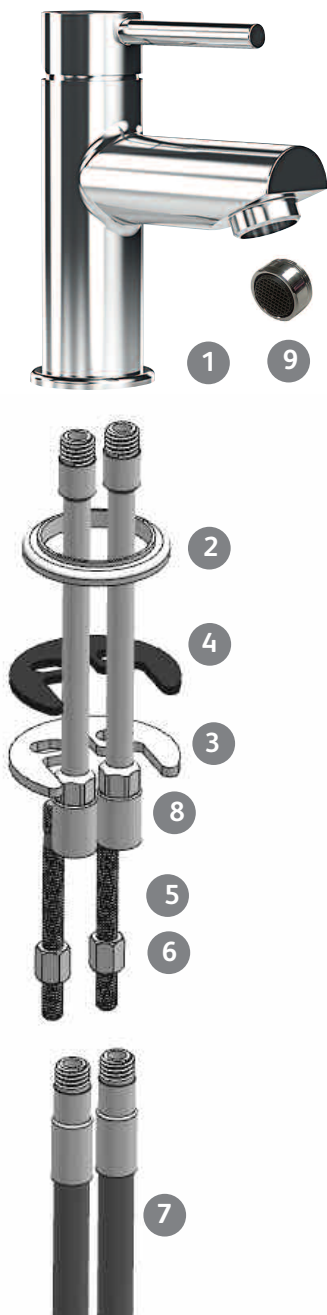

## Large pillar taps components

Large Pillar Tap (1)

Cover Plate (2)

Fixing Plate (3)

Fixing Washer (4)

Fixing Bolt (x2) (5)

Fixing Nut (x2) (6)

1/2" Flexible Hoses (7)

Rigid Extensions (8)

Flow regulator 5 lpm (9)

# TAPS

A great shower deserves a great tap

## Deck Mounted Bath Filler installation



In addition to the guide below it is essential that the important information section is read and understood and that you have all the necessary components before commencing installation. Failure to install the product in accordance with these instructions may adversely affect the warranty terms and conditions. Do not undertake any part of this installation unless you are competent to do so. Prior to starting, ensure that you are familiar with the necessary plumbing regulations required to install the product correctly and safely.

1

Fit the base rings into the bath filler (2).

2

Locate the tails of the bath filler into the holes of the bath.

3

Underneath the bath, put the fixing washers (3) onto the tap tails and secure them using the fixing nuts (4).

## Deck Mounted Bath Filler Components:

Deck Mounted Bath Filler (1)

Base Ring (x2) (2)

Fixing Washer (x2) (3)

Fixing Nut (x2) (4)

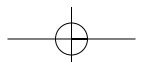
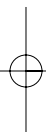
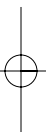

[illegible]

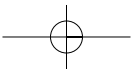
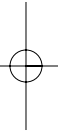
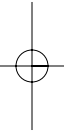

# #ObsessedWithShowers<sup>TM</sup>

## AQUALISA

Aqualisa Products Limited  
The Flyers Way  
Westerham Kent TN16 1DE

Customer helpline: 01959 560010  
Brochure Hotline: 0800 652 3669  
Website: [www.aqualisa.co.uk](http://www.aqualisa.co.uk)  
Email: [enquiries@aqualisa.co.uk](mailto:enquiries@aqualisa.co.uk)

Republic of Ireland  
Sales enquiries: 01-864-3363  
Service enquiries: 01-844-3212

Follow us on:



Please note that calls may be recorded for training and quality purposes.

The company reserves the right to alter, change or modify the product specifications without prior warning.

© Registered Trademark Aqualisa Products Limited



### Did you know we offer free installer training?

- Locations across the UK
- Expert installation advice
- Deals on the day

Book your place!

**[aqualisa.co.uk/training](http://aqualisa.co.uk/training)**  
**01959 560042**

Part No.703772 Issue 02 Oct 17