

HARMONY

800mm Basin and Full Pedestal

RAK
CERAMICS



SPECIFICATION/CODE REFERENCE

Please use the reference codes shown below:

HAR80BAS1 HARPED

SIZE	800 x 500 x 850 mm
TAP HOLE	Single tap hole
OVER FLOW	Built-in
WASTE OUTLET	Ø45mm standard waste outlet
STANDARD	BS 3402 1S09001
MATERIAL	Vitreous china
WEIGHT	45.10 kg
COLOURS	White
FIXING	Fisher fittings supplied
WARRANTY	25 Years

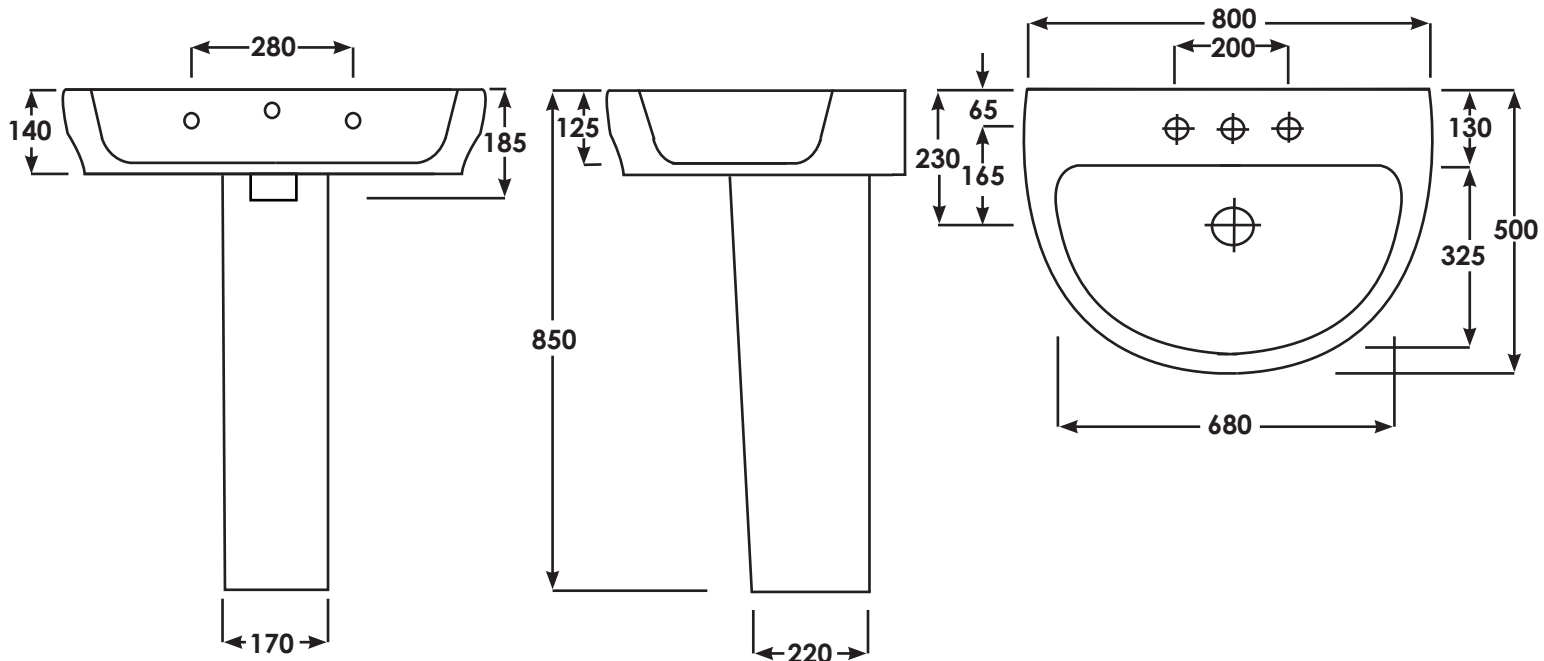

Dimensions: All measurements are in millimeters and are subject to normal manufacturing variations.

Note: Due to a continuing development programme to improve design and performance, the manufacturer reserves all rights to vary specifications without prior informations. Please note accessories are for photographic use only.

Tel: 01730 237850 Fax: 01730 263210. RAK Ceramics, Bradford House, Frenchmans Road, Petersfield, Hampshire GU32 3AW

Contact us at: info.uk@rakceramics.com/ Visit us at: www.rakceramics.com 2017