

## Sola Non-concussive Shower

### SF1215CP

## Installation and Maintenance Instructions

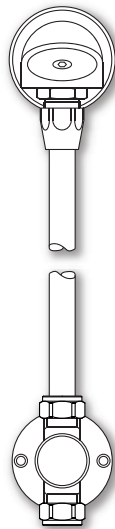

In this procedure document we have endeavoured to make the information as accurate as possible.

We cannot accept any responsibility should it be found that in any respect the information is inaccurate or incomplete or becomes so as a result of further developments or otherwise.

## Contents

Thank you for choosing the Twyford Sola non-concussive shower.

<b>Subject</b>	<b>Page</b>
Introduction and Safety	2
Technical Data	3
Components	3
Dimensions	4
Site Preparation	4
Installation	5
Aftercare	6
Twyford Guarantee	7

## Introduction

This installation guide has been produced for the Sola non-concussive shower. These instructions cover the installation, operation and maintenance. Please read the enclosed instructions before commencing the installation of this product, please note;

**We recommend that the installation of any Twyford product is carried out by an approved installer.**

The installation must be carried out strictly in accordance with the Water Supply (Water Fitting) Regulations 1999 and any local authority regulations.

If in doubt we recommend that you contact WRAS - Water Regulations Advisory Scheme on Tel: 0333 207 9030, your local water authority - details available on the WRAS website or the Chartered Institute of Plumbing and Heating Engineers on Tel: 01708 472 791.

All products MUST be re-commissioned to suit site conditions to ensure optimum performance levels of the product are obtained.

## Safety

The Twyford Sola non-concussive shower must be installed and commissioned correctly to ensure that water is supplied at a safe temperature to suit the users.

A thermostatic mixing valve (TMV) should be installed in the supply to the timed flow controller to ensure a safe bathing temperature for the user.

A service valve and single check valve should also be installed in the supply to the timed flow controller.

The British Burns Association recommends 37 to 37.5°C as a comfortable bathing temperature for children. In premises covered by the Care Standard Act 2000, the maximum mixed water outlet temperature is 43°C.

## Products

Sola non-concussive shower

SF1215CP

## Check Content

Before commencing remove all components from packaging and check each component with the contents list.

Ensure all parts are present, before discarding any packaging. If any parts are missing, do not attempt to install your shower until the missing parts have been obtained.

## Technical Data

Max Inlet Pressure (Static)	5 bar
Min Operating Pressure (Dynamic)	0.2 bar
Max Inlet Temperature	65°C
Timed Flow @ 3 bar	30±5 seconds

## Components

Item	Qty	Component
1	1	Timed flow controller
2	2	Olive
3	2	Compression nut
4	1	Compression nut
5	1	Domed plug
6	1	Connector
7	1	Retaining screw
8	1	Shower head
9	1	Blanking plug
10	1	Wall plate
11	1	Chrome pipe

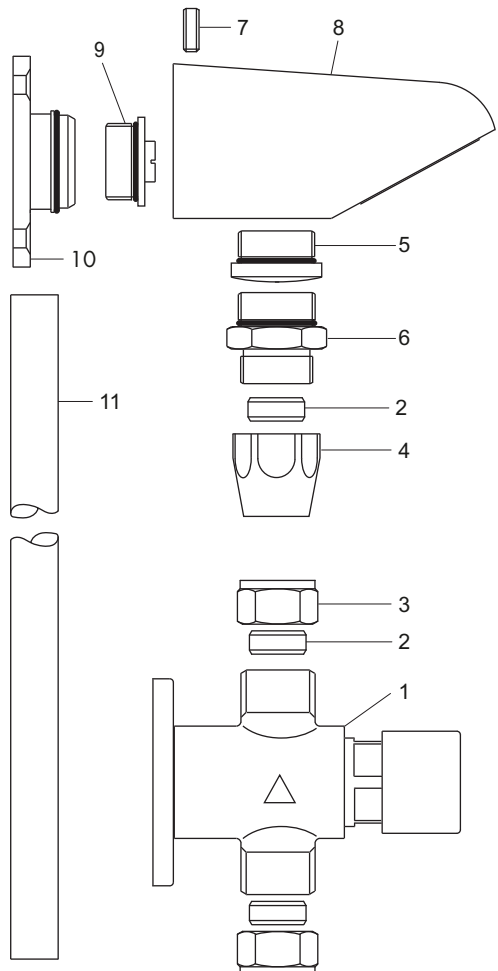

## Dimensions

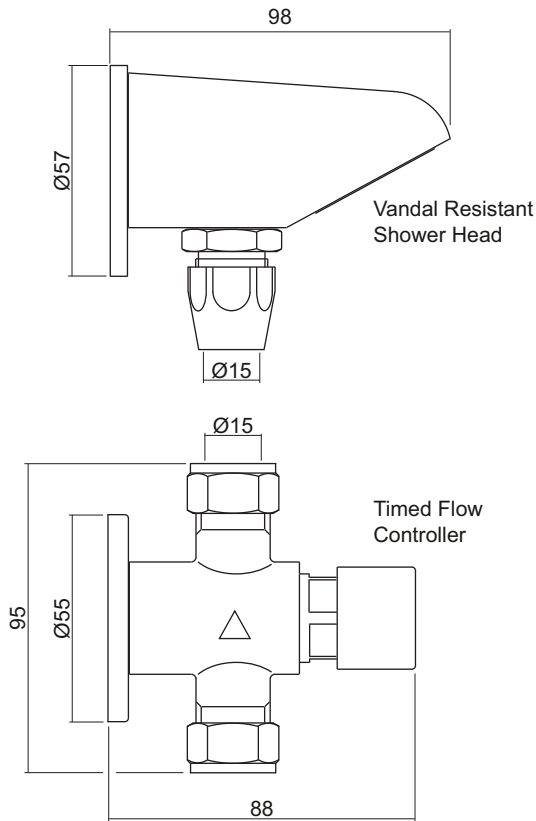

## Site Preparation

**It is important to plan the installation thoroughly to suit site conditions before commencing.**

- Before commencing the installation ensure site conditions are suitable.
- A service valve and single check valve should be fitted in an accessible position in the mixed water supply should the valve need to be isolated in the future for servicing.
- Both the flow controller and shower head are designed for exposed pipework.
- If a stud wall ensure structural members are in a position where the flow controller and shower head will be fitted.

## Site Preparation Continued

- Finish the wall and floor before fitting the flow controller and shower head.
- The whole system should be thoroughly flushed, prior to the connection of the mixed water supply to the shower mixing valve, to remove any debris that may be in the supply pipework.

## Installation

The screws and wall plugs supplied are only suitable for use in solid walls. If the wall is plaster board or soft building block use special wall plugs obtainable from most DIY stores.

Ensure there are no supply pipes or cables where you intend to drill.

Where possible, drill holes between ceramic tiles (in the grout). If drilling into ceramic tiles use a ceramic bit.

This product must always be used and fitted in such a way as not to cause water damage, therefore should be located and directed towards a suitable shower tray.

Take care to use power tools safely.

To avoid cracking ensure the wall plugs are pushed all the way behind the ceramic tile.

The components are supplied individually or loosely assembled.

- Screw the blanking plug (9) into the wall plate (10) and tighten to make a water tight seal.
- If the domed plug (5) is fitted into the shower head (8) remove it and replace with the connector (6) and again tighten to make a water tight seal.
- Mark the position for the timed flow controller on the wall at a convenient height approximately 1 metre above the floor of the shower.
- Drill two holes and using the screws and wall plugs provided secure to the wall ensuring the riser rail when fitted will be vertical.
- Ensure the flow direction arrow on the body of the timed flow controller is pointing upwards in the direction of the shower head.
- Mark the position for the shower head on the wall, vertically above the flow controller, at a height to suit the tallest user.
- Drill two holes and using the screws and wall plugs provided secure the wall plate to the wall.
- Fit the chrome pipe (11) into the timed flow controller and into the shower head and offset to the wall, it may need reducing in length to suit site conditions.
- With the chrome pipe located in the in the flow controller and shower head locate on the wall plate and secure in position with the retaining screw (7) located at the top of the shower head.
- Connect the mixed water supply to the inlet of the timed flow controller and tight all the compression joints.
- Turn on the water supply and check the joints and shower head for any signs of leakage other than from the spray nozzle.

## Aftercare

Twyford shower units have a high quality finish and should be treated with care.

An occasional wipe with a mild washing-up liquid on a soft damp cloth followed by a thorough rinsing is all that is required.

**Do not use an abrasive or chemical household cleaner** as this may **cause damage**.

## Spares

A full range of spares are available for this product from Twyford.

**PLEASE NOTE:** Only genuine spares should be used.

**Please leave this Manual for the User**

## Twyford Guarantee

At Twyford, we want to make things as easy as possible for our customers. That's why we design products that are easy to fit and use, and that are quality tested to make sure they won't let you down. It's also why we offer solid guarantees on all products, effective from the date of purchase, to give you peace of mind.

Twyford Sola non-concussive shower is covered by a parts only **2 year guarantee**.

### Guarantee Terms and Conditions

This guarantee is in addition to your statutory and other legal rights and is subject to the following conditions:

- The product was purchased within the United Kingdom or Republic of Ireland.
- The guarantee applies solely to the original purchaser with proof of purchase.
- The installation must allow ready access to all products for the purpose of inspection, maintenance or replacement.
- Repair under this guarantee does not extend the original expiry date. The guarantee on any replacement parts or products ends at the original expiry date.
- Any part found to be defective during the guarantee period will be replaced without charge, providing that the product has been installed in accordance with the instructions given in this guide and used as the manufacturer intended.

The guarantee does not cover damage or defects caused by:

- General wear and tear (including special non-chrome finishes; components such as filters, seals, 'O' rings and washers).
- Incorrect installation.
- Repair using non-Twyford parts
- Accidental or wilful misuse
- Corrosion and the use of inappropriate cleaning products.

- System debris including the build up of limescale (which can be controlled through regular servicing and maintenance).

The guarantee does not cover compensation for loss of use of the product or consequential loss of any kind.

In the interests of continuous product improvement, Twyford reserves the right to alter product specifications without notice.

The Twyford Product Guarantee does not affect your statutory rights as a consumer.

### Need help?

If this product does not function correctly when first used, contact **Geberit Technical Department on 01926 516800** where our expert team of advisors will be able to offer you help and advice.

### Problems during the guarantee period

In the unlikely event that you encounter any problems with the product during the guarantee period, contact **Geberit Technical Department on 01926 516800** with your proof of purchase and we will work to resolve the problem quickly.

### Technical support hotline

(Tel: **01926 516800**) with access to fully trained advisors who can offer installation advice, talk you through quick maintenance checks, or recommend the best course of action to fix any problems with a product.

### Contact Us

For any queries please contact us or visit our website for further information:

Email: [technical@geberit.co.uk](mailto:technical@geberit.co.uk)

Website: [www.twyfordbathrooms.com](http://www.twyfordbathrooms.com)

Telephone: 01926 516800



**Notes:**

**Notes:**

**Notes:**



E & O.E

12-07-21

---

**Geberit Sales Ltd, Geberit House**  
**Edghehill Drive, Warwick, CV34 6NH**

**Geberit International AG Schachenstrasse**  
**77, CH-8645 Jona**  
**documentation@geberit.com**  
**www.geberit.com**