

## Basin

## Conca

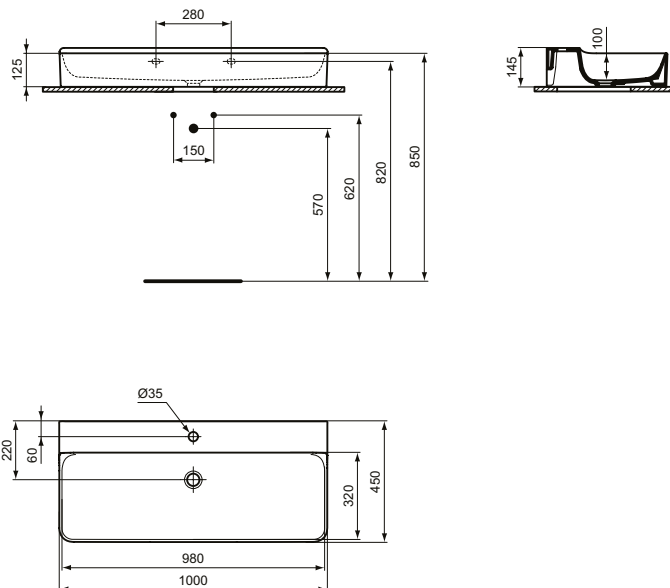

Article-No.: **T383501**

### Basin 100cm grinded underneath

Conca wall-mounted basin with 1 taphole punched, without overflow. Grinded underneath: suitable for worktop installation. Assembly with free waste (separate order). In case of installation with mixer with pop-up waste, please, order A960200AA Elongated pop-up rod. Please see the Atelier Collections Catalogue/Price list for Recommended equipment.

**Colour:** 01 - White

**Features:** .With an overflow

#### More product details:

Type:	Wall mounted / pedestal
Mounting:	Wall mounted! Worktop installation
Style:	Contemporary
Accreditations:	DIN EN 14688 CL 00, DIN EN 31
Tap Holes:	1
Net Weight (kg):	25,4
Material:	Fine fireclay
Designer:	Palomba Serafini Associati
Height (mm):	165
Width (mm):	1000
Depth (mm):	450
Shape:	Squared / Rectangle
Certificate Number:	EN 14688
Installation:	Wall-mounted