

Technical Data Sheet

Back to wall unit

What's in the box: 1x F2BW5.X, F2BW6.X, F3BW5.X, F3BW6.X + fixings

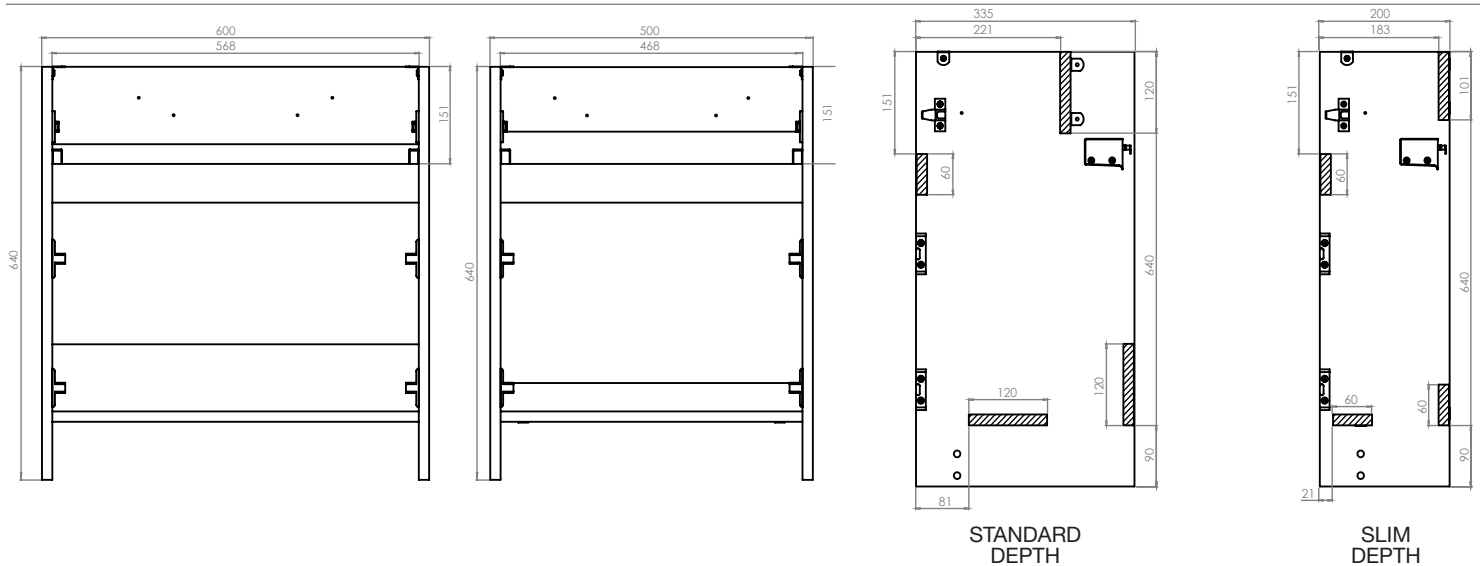

Materials

Carcass: 16mm MFC

- Dimensions are subject to change, customers are advised to measure actual product before commencing installation.
- Legs provide height adjustment range of 75mm (included in the box, but not shown in the diagram).
- Care should be taken when calculating configurations without filler/end panels.

Diagrams not to scale
All dimensions in mm
Tolerance of +/-5mm

FAQs

Q: How do I fix the unit to the wall?

A: There are adjustable wall hangers installed in the unit and wall plate kit provided.

Q: Are the fascia/ door packs included?

A: No, these will need to be ordered separately - please see brochure for more details.

Q: Are the BTW fascia and cupboard fascia interchangeable?

A: No.

Q: Should I see the carcass behind the fascia components?

A: Yes, parts of the carcass may be visible when installed.

Q: How do you apply an in-wall cistern frame?

A: Refer to instruction provided with wall hung frame product.

Q: Can I fix a wall hung frame via internal brace?

A: No. When installing a wall hung frame you must fix to a supporting wall, not to the wooden brace components.

For standard depth carcasses you can remove top back brace to access the supporting wall.

Q: Do you apply adjustable legs when installing an in-wall cistern frame?

A: No, legs are not to be applied. Hanging unit on wall and using mechanism adjustment should be used to achieve desired position.

Q: How do you make vertical adjustment to wall hanging mechanisms?

A: Use the adjustment screw on the rear of the wall hanging mechanism to make vertical adjustments.

NOTE: Colours unique to Tavistock - No RAL Code available