



Semi-detached House

908 Carntyne Road, Carntyne, GLASGOW, G32 6NE

Offers Over £165,000



properties

Solicitors and Estate Agents





Description

This beautifully presented three bedroom semi detached villa has been professionally extended and offers superb family accommodation in a popular residential setting. The property has been very well maintained by the sellers, the main roof having been renewed in recent years and the external paintwork has been regularly freshened. Furthermore the gardens and driveway are neatly tended all adding to the attractive kerbside appearance of this home.

Inside the property exhibits stylish decor and contemporary fixtures & fittings throughout. The single storey rear extension has really enhanced the available living space adding a versatile room off the kitchen and an en-suite facility from the downstairs bedroom.

The entrance to this property is to the side elevation leading to a carpeted reception hall which in turn leads to the lounge and Bedroom one. A stairway from this hall accesses the upper floor. The lounge is a wonderful reception room with a deep bay window formation adding additional depth to this room. A deep under stair cupboard off this room provides handy storage space with a window to the side elevation lending light. You access the kitchen from a doorway to the rear of this lounge. Beautifully appointed, this kitchen is fitted with an array of high gloss units and the broad worktops incorporate a gas hob with oven below. In addition the integrated appliances include a fridge, freezer and washing machine all of which are neatly enclosed. An archway to the other end leads to the dining room which has French doors leading directly to the rear garden. This is a really useful living space and links to the outdoor space. Also on the ground floor is Bedroom one. This is a nicely proportioned double bedroom with a window to the side elevation. Another superb feature is the large en-suite shower room off this bedroom. It is beautifully tiled and fitted with a shower cubicle, wc and wash hand basin within fitted furniture. A window to the rear elevation allows natural light to flood in.

Upstairs there is a long landing which links to the two further bedrooms and the bathroom. There is more handy storage space available within two recessed cupboards off this landing, one of which houses the gas central heating boiler. A ceiling hatch with pull down ladder leads to the attic space. Both bedrooms are of good proportion, the larger bedroom two is to the front and bedroom three is rear sited. The bathroom is again beautifully appointed complete with a three piece suite including a bath, wc and wash hand basin within fitted furniture. A window to the side elevation lends light.

This property has a gas fired central heating system with a combination boiler and the windows are double glazed with UPVC casements. Externally there are excellent sized gardens to the front and rear all enclosed and providing a family friendly outdoor space to be enjoyed. The front garden has a lawn bordered by railings/fencing and the gated monoblock driveway continues to the side affording off street parking for several cars. To the rear there is a level lawn with paved area enclosed by timber fencing.

Situated within the east end district of Carntyne this property enjoys a much admired location close to a host of amenities. There is local schooling at both Primary & Secondary level. Lightburn Medical Centre & Pharmacy sit just along from the property along with some convenient local shops. Further shopping facilities can be found at a Tesco Extra and Aldi in neighbouring Shettleston. Those commuting have easy access to local bus services and Carntyne Train Station is a short walk away. There are also convenient road links to Glasgow city centre, the M74, M8 and central belt motorway network.

Room Dimensions

Reception hall	1.88 m x 1.24 m / 6'2" x 4'1"
Lounge	5.08 m x 4.27 m / 16'8" x 14'0"
Dining Room	2.67 m x 3.07 m / 8'9" x 10'1"
Kitchen	3.15 m x 2.08 m / 10'4" x 6'10"
Bedroom 1	3.23 m x 3.20 m / 10'7" x 10'6"
Bedroom 2	4.11 m x 3.51 m / 13'6" x 11'6"
Bedroom 3	3.48 m x 3.20 m / 11'5" x 10'6"
Bathroom	2.11 m x 1.88 m / 6'11" x 6'2"
Ensuite	2.67 m x 1.98 m / 8'9" x 6'6"

EPC: D

Features

Lovely family home
Professionally extended to the rear
Stylish decor
Three bedrooms, master with en-suite
Beautifully appointed kitchen
Dining room - French doors to garden
Enclosed gardens & driveway
Close to Schools, shops and transport links



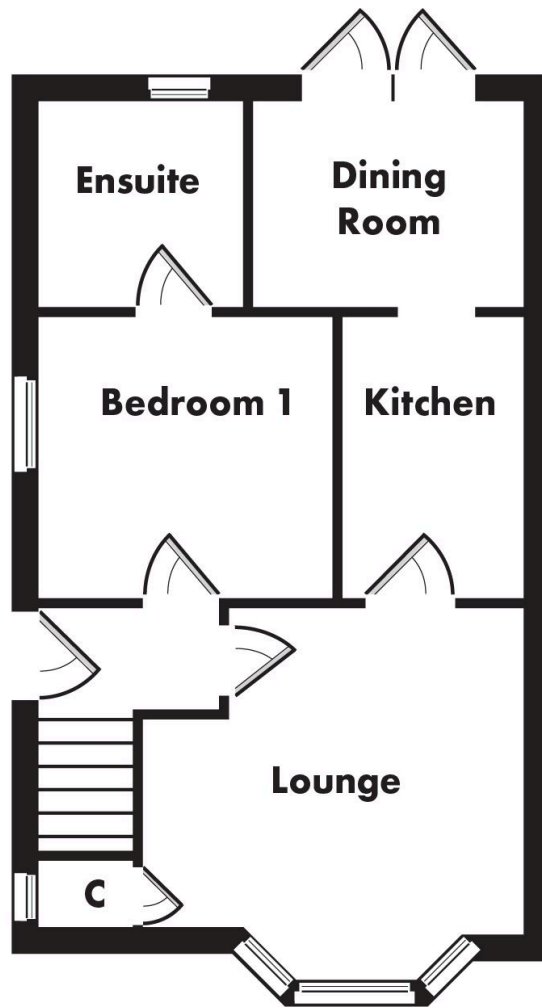

Floor plans are indicative only - not to scale.

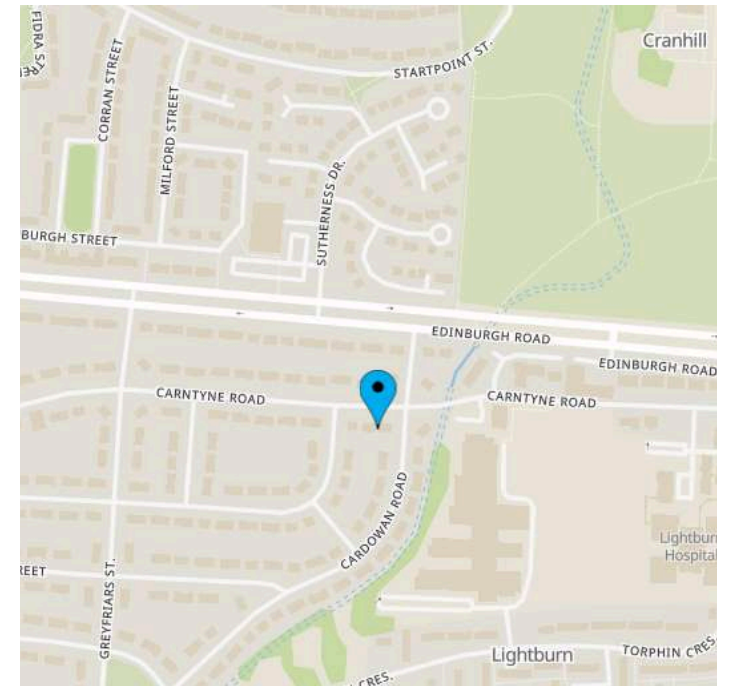
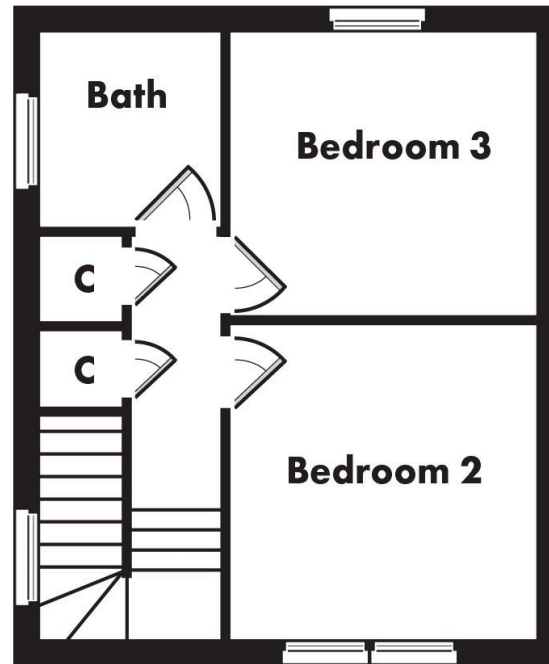

TRAVEL DIRECTIONS

Travelling westwards along Carntyne Road continue passing the Lightburn Medical Centre on your left. Pass the junction with Cardowan Road and this property is found on the left hand side.

MARKET APPRAISAL

For an up-to-date appraisal on your own property please call us on **0141 331 0741**. This is a complimentary service and will help us to calculate your purchasing power.

Property Manager: Iain Macmillan • Telephone: **0141 331 0741**

Email: iain@prp-legal.co.uk

Kensington House, 227 Sauchiehall Street, G2 3EX F: 0141 332 6847
1242 Shettleston Road, Shettleston, G32 7PG F: 0141 763 1948

For further information:

Or to view this property please call:

0141 331 0741



properties
Solicitors and Estate Agents

PRP properties is a trading name of PRP Legal Limited (Registered Company Number SC411714)

DISCLAIMER

Whilst we endeavour to make particulars as accurate as possible they do not form part of any contract on offer, nor are they guaranteed. Measurements are approximate and in most cases are taken with a digital/sonic-measuring device and are taken to the widest point. We have not tested the electricity, gas or water services or any appliances. Photographs are reproduced for general information and it must not be inferred that any item is included for sale with the property. If there is any part of this that you find misleading or simply wish clarification on any point, please contact our office immediately when we will endeavour to assist you in any way possible.

ESPC Ref: E438741

