



6 Aydon Crescent

Guide Price | £350,000



Detached home within walking distance of Corbridge centre with a surrounding plot, garaging and driveway parking.



Deceptively Spacious Throughout

uPVC door bordered by glazing provides access into the central entrance hall. The first door to the left leads into the living room with attractive fireplace. This is a large room with south and north facing windows, it has an L-shape to it leading out towards the kitchen.

The kitchen itself has a range of wall and floor mounted cabinets, integrated double oven, four ring gas hob, stainless steel sink with mixer tap above, window looking out over the rear garden and a door out to the garage.



To the other side of the living room lies the sun room which has a tremendous amount of light via both south and west facing windows. The western elevation also has lovely fully glazed French doors leading out on to the western side of the garden, perfect for enjoying the afternoon and evening sun. The room itself is of a good size and has exposed wooden boards to the floor.

From the other side of the hallway lies the ground floor double bedroom which has south facing window.

The final room on the ground floor is the shower room which has a two piece white suite and sliding door walk in shower.

Stairs leads to the first floor.



The larger of the two bedrooms on the first floor is located on the western elevation. It has lovely mature green views over Corbridge rooftops and three integrated storage spaces as well as shelving.

To the eastern side of the home, there is another double bedroom this time with a south facing window as well as sliding door built in wardrobe.

The final room is the family bathroom with three piece white suite, south facing window, splash back tiling, wall fixed mirror with vanity light and loft access via a hatch in the ceiling.





Generous Surrounding Plot

Externally there is a long garage with driveway parking to the front with double cast iron gates closing off the garden.

The gardens predominately lie to the south and west and are mainly laid to lawn. To the north west corner lies a shed, summerhouse and greenhouse all requiring a little care and attention to bring them back to their former glory.

Further gardens are found to the rear which have various shrubs and lawn as well as pedestrian access out on to the Aydon Road.



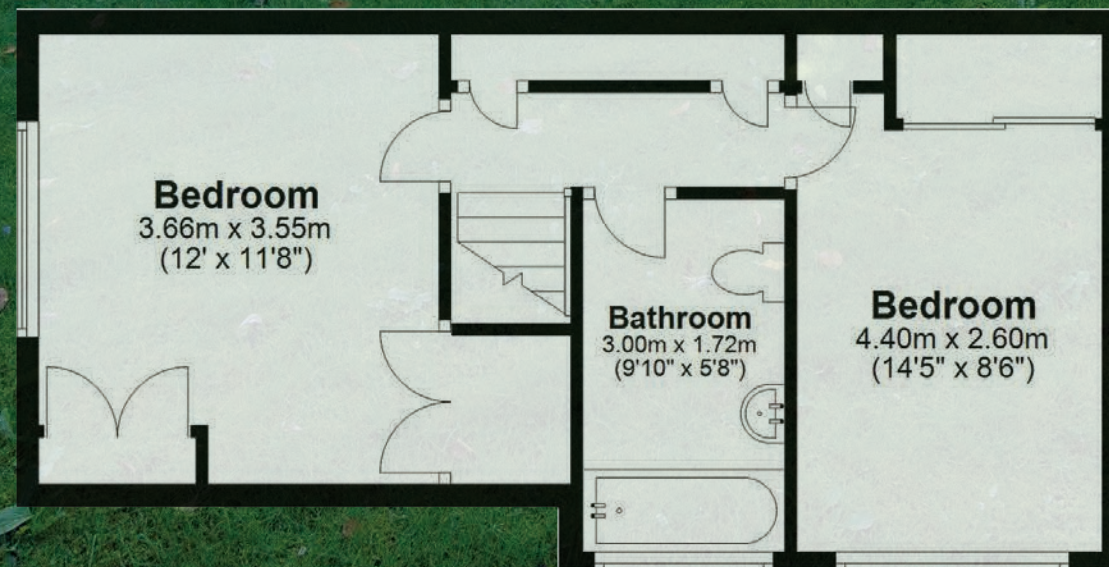
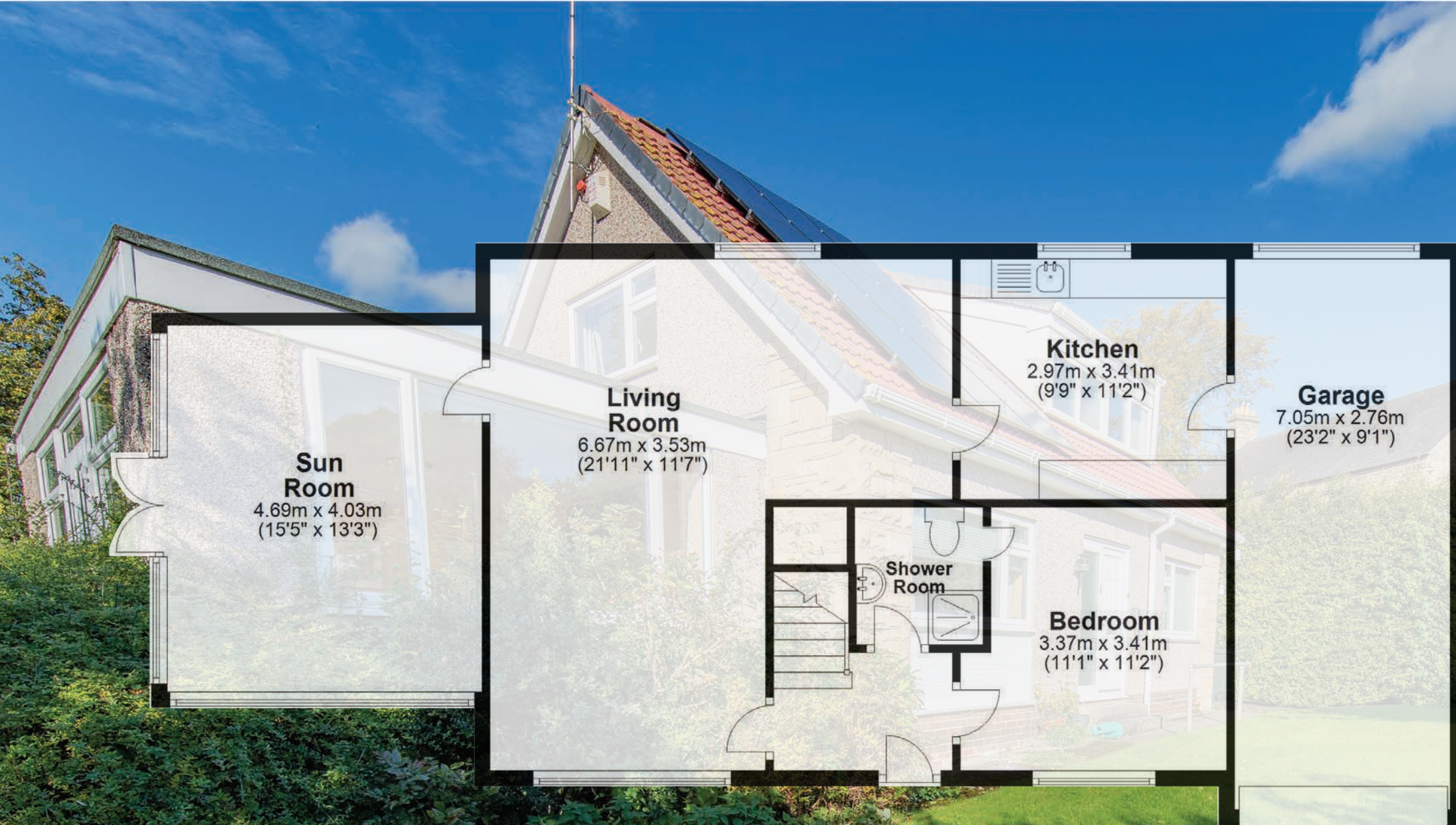

Finer Detail

FULL ADDRESS

6 Aydon Crescent, Corbridge, NE45 5EB

INTERNAL

Living Room | Sun Room | Kitchen | Ground Floor WC | Ground Floor Double Bedroom | Two Further Double Bedrooms | Family Bathroom

EXTERNAL

Garage | Driveway Parking | Surrounding Plot | Generous Gardens | Shed | Greenhouse | Summerhouse

DISTANCES

Hexham 4 miles | Newcastle 21 miles | Newcastle Airport 19 miles

SERVICES

Mains throughout

Council Tax Band | E

Tenure | Freehold

EPC | F

ANTON ESTATES

Telephone: 01434 632 080

Email: home@antonestates.co.uk

Website: www.antonestates.co.uk

Social Media: @antonestates

Address: 19 Middle Street, Corbridge, Northumberland, NE45 5AT

- These particulars do not form any part of any offer or contract.
- They are intended to give a fair description of the property, but neither Anton Estates nor the vendor accept any responsibility for any error they may contain, however caused. Any intending purchaser must therefore satisfy themselves by inspection or otherwise as to their correctness.
- Neither Anton Estates nor any of their employees has any authority to make or give any further representation or warranty in relation to this property.