

# NOVUS Residential

SALES  
LETTINGS  
MANAGEMENT

## HIGHFIELD ROAD, WINCHMORE HILL, N21



A three-bedroom, two reception mid-terrace family house located upon this popular residential street which is well located for access to the local amenities and leisure facilities of Winchmore Hill. The accommodation, which extends to 875 sq ft, comprises an entrance hall with doors leading to: dual aspect reception room, dining room and separate kitchen with range of appliances and door leading to a south facing garden, laid to lawn. Stairs rise to the first-floor landing comprising a large bay fronted, dual aspect principal bedroom with built in wardrobes, two further bedrooms to front and rear aspect and family bathroom suite. The property benefits from UPVC double glazing throughout and existing planning consent for a loft conversion and possible further addition to the rear of the building subject to obtaining the correct planning consents.

Highfield Road is a quiet one-way street, closely located to the New River Loop and the many sporting and leisure amenities of Winchmore Hill and Firs Lane. Sainsbury's Superstore is within comfortable walking distance as are both Palmers Green and Winchmore Hill's shopping parades and Overground stations, providing regular commuter services to London's Moorgate and Kings Cross stations. The property is also well placed to benefit from the investment in infrastructure by local government which has seen adjoining roads transformed to improve public spaces and reduce congestion. In addition, several schools of good renown are within very close proximity to the property to include Highfield Primary and Winchmore School.

**£550,000 (STC)**

**FREEHOLD**

0208 350 8936

[move@novusresidential.co.uk](mailto:move@novusresidential.co.uk)

**zoopla**

**rightmove**   
find your happy

**PRS** Property  
Redress  
Scheme



**Council Tax - E £2,251 (ENFIELD)**















- These particulars are offered on the understanding that all negotiations are conducted through this company.
- These details and photographs have been prepared for "Novus Residential" in good faith and as a general guide, not a statement of fact.
- Neither these particulars, nor oral representations, form part of any offer or contract and their accuracy cannot be guaranteed.
- Any floor plan provided is for representation purposes only, measurements are approximate and should not be relied upon, whilst every attempt has been made to ensure their accuracy the measurements of windows, doors and rooms are approximate and should be used as such by prospective purchasers.
- We have not tested any services, systems and appliances mentioned and we cannot verify that they are in working order.
- Should you have a query or complaint about our service, please contact us at [move@novusresidential.co.uk](mailto:move@novusresidential.co.uk)

**GROUND FLOOR**  
435 sq.ft. (40.4 sq.m.) approx.

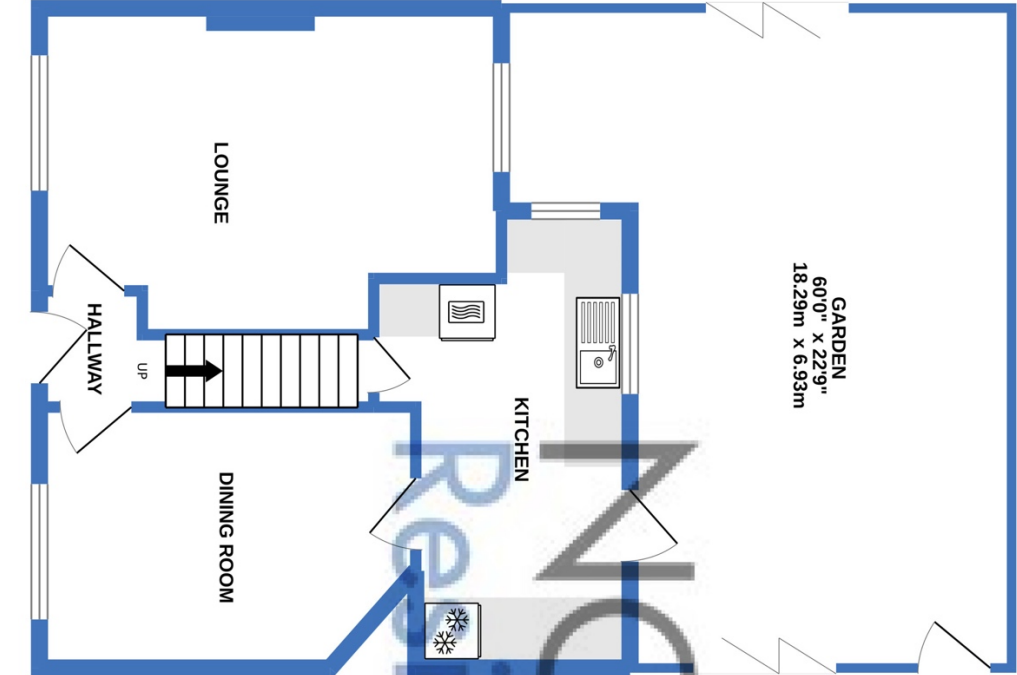

**1ST FLOOR**  
430 sq.ft. (39.9 sq.m.) approx.

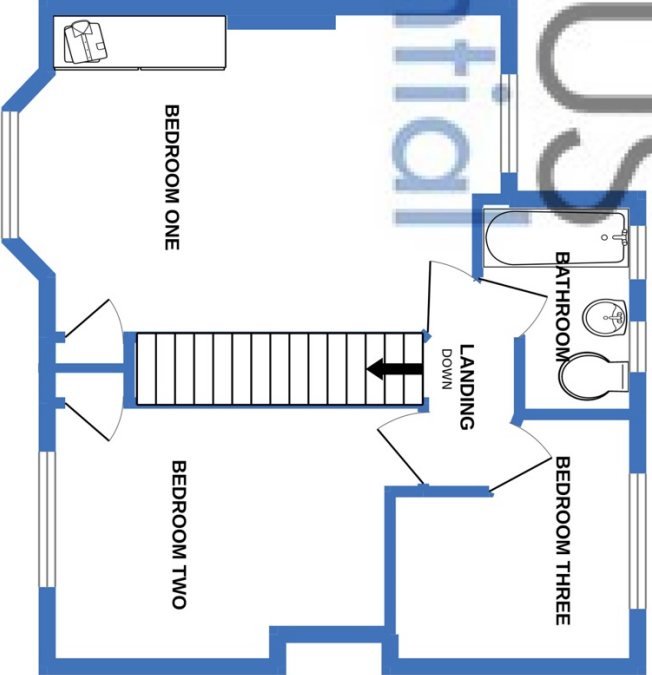

TOTAL FLOOR AREA: 865 sq.ft. (80.4 sq.m.) approx.

Whilst every attempt has been made to ensure the accuracy of the floorplan contained here, measurements of doors, windows, rooms and any other items are approximate and no responsibility is taken for any error, omission or mis-statement. This plan is for illustrative purposes only and should be used as such by any prospective purchaser. The services, systems and appliances shown have not been tested and no guarantee as to their operability or efficiency can be given.  
Made with Metroplan ©2022