

Reabrook Road, Longbridge, Birmingham, B31 4EP | £160,000  
Three Bedroom Semi-Detached House



**Features:**

- Three Bedrooms
- Shower Room and Separate WC
- Lounge
- Kitchen and Separate Utility Room
- Rear Garden
- Driveway and Garage
- No Upward Chain

**Summary:**

A well proportioned three bedroom semi-detached house, offered with no upward chain, lounge, kitchen/diner and driveway with garage, situated in Longbridge, Birmingham.

**Description:**

The accommodation, in brief, features:- Driveway and Garage with Shed to Rear, Hall, Lounge with Feature Fireplace, Kitchen with Door to Rear Garden, Utility Room, Stairs to First Floor Landing, Master Bedroom with Built In Wardrobe, Double Bedroom Two with Built In Wardrobe, Bedroom Three, Shower Room and Separate WC.

**Outside:**

Outside, the property enjoys a rear garden with a paved patio and steps up to a lawn with hedged boundaries.

**Location:**

Situated in Longbridge, the property enjoys close proximity to the new Longbridge development with Sainsburys supermarket and large Marks and Spencers, as well as nearby Rubery offering a selection of shops, restaurants, ten pin bowling and a cinema. In addition, Longbridge train station is nearby and ideal for those commuting to Birmingham City Centre.





## Room Dimensions:

### Hall

### Lounge:

21' 3" x 11' 11" (6.50m x 3.65m) max

### Kitchen:

15' 10" x 8' 10" (4.85m x 2.70m) max

### Utility Room:

9' 0" x 4' 9" (2.75m x 1.45m)

### Stairs To First Floor Landing

### Master Bedroom:

14' 2" x 10' 2" (4.32m x 3.10m)

### Bedroom Two:

12' 7" x 7' 10" (3.85m x 2.40m)

### Bedroom Three:

10' 2" x 6' 11" (3.10m x 2.12m)

### Shower Room:

6' 4" x 4' 11" (1.95m x 1.50m)

### WC

EPC: TBC

Council Tax Band: TBC

Tenure: Freehold

For more information on Reabrook Road or to arrange a viewing, please call the Rubery Office on 0121 453 4349



## Reabrook Road, Longbridge First Floor

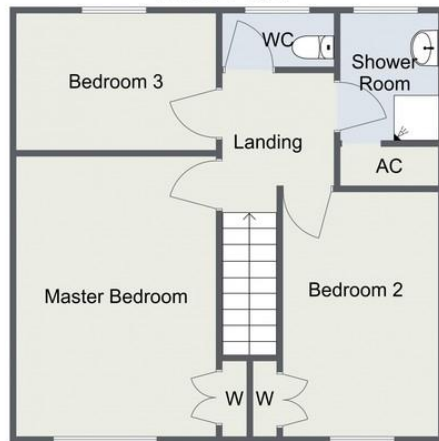

## Reabrook Road, Longbridge First Floor



## Ground Floor



Total Area Approx (not inc garage)  
86.3 sq metres (928 sq ft)

## Ground Floor



Total Area Approx (not inc garage)  
86.3 sq metres (928 sq ft)

For illustrative purposes only. Decorative finishes, fixtures & fittings do not represent the current state of the property. Measurements are approximate & not to scale. Floor Plans made using RoomSketcher.

For illustrative purposes only. Decorative finishes, fixtures & fittings do not represent the current state of the property. Measurements are approximate & not to scale. Floor Plans made using RoomSketcher.

**Please read the following:** These particulars are for general guidance only and are based on information supplied and approved by the seller. Complete accuracy cannot be guaranteed and may be subject to errors and/or omissions. They do not constitute a contract or part of a contract in any way. We are not surveyors or conveyancing experts therefore we cannot and do not comment on the condition, issues relating to title or other legal issues that may affect this property. Interested parties should employ their own professionals to make enquiries before carrying out any transactional decisions. Photographs are provided for illustrative purposes only and the items shown in these are not necessarily included in the sale, unless specifically stated. The mention of any fixtures, fittings and/or appliances does not imply that they are in full efficient working order and they have not been tested. All dimensions are approximate. We are not liable for any loss arising from the use of these details.