



Seymours



Ashbury Drive
Camberley, GU17 9HH
£575,000 Guide Price
Council Tax Band E
Council Tax £2,428.62
Freehold

Arrange a viewing: 01276 534100

Property Details

4 bedrooms

0 baths

EPC Rating TBC

1772 sqft

Station Name (0.0 miles)

- Detached extended family house
- Four double bedrooms
- Refitted bathrooms
- Modern Kitchen
- Large Living room
- Dining room
- Sunny aspect rear garden
- Driveway parking for several cars
- Convenient for Blackwater amenities

No onward chain. A superbly presented four double bedroom family house that has been extended and beautifully refurbished over the years and now offers spacious and flexible living space as well as a very sunny aspect rear garden and driveway parking for several vehicles. The property is conveniently located in this popular road which is situated less than a mile from local shops ,amenities and railway station at Blackwater as well as Hawley primary school and attractive countryside at Hawley woods.

[01276 534100](tel:01276534100) / james@seymours-blackwater.co.uk



Ashbury Drive

Approximate Gross Internal Area = 164.6 sq m / 1772 sq ft

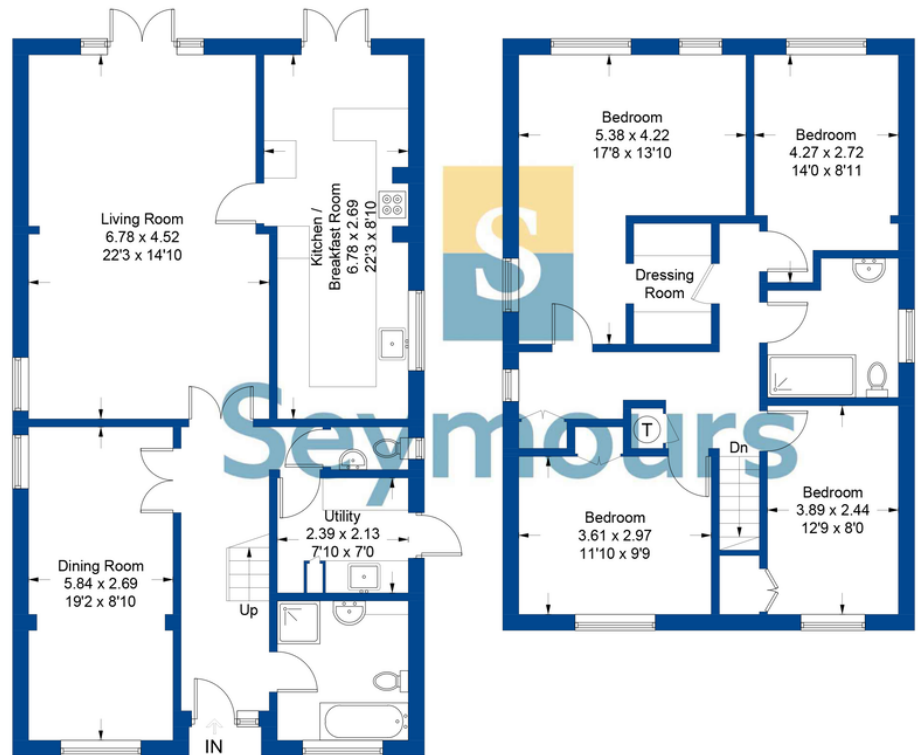

Ground Floor = 90.4 sq m / 973 sq ft

First Floor = 74.2 sq m / 799 sq ft

Illustration for identification purposes only, measurements are approximate, not to scale. FloorplansUsketch.com © 2022 (ID894105)