





Myrtle Drive  
Camberley, GU17 0JL  
£199,995

## Property Details

 1 bedroom

 1 bathroom

 EPC Rating TBC

 397 sq ft

 Blackwater Station under half a mile

- Ideal for first time buyers
  - Modern kitchen and bathroom
  - Living room and double bedroom with fitted wardrobes
  - Own parking for one car
  - Private enclosed rear garden
  - Convenient for Blackwater local shops and amenities
  - Good road links close by
- Near to Blackwater nature reserve

**IDEAL FOR FIRST TIME BUYERS AND DOWNSIZERS.** This ground floor flat is beautifully presented and also has its own private garden and allocated parking. There is a modern kitchen and bathroom as well as a living room and a double bedroom which benefits from fitted wardrobes. The property is very well situated for local shops and amenities at Blackwater as well as the railway station and really good road links close by.



## Property Details

### Myrtle Drive

Approximate Gross Internal Area = 36.8 sq m / 397 sq ft

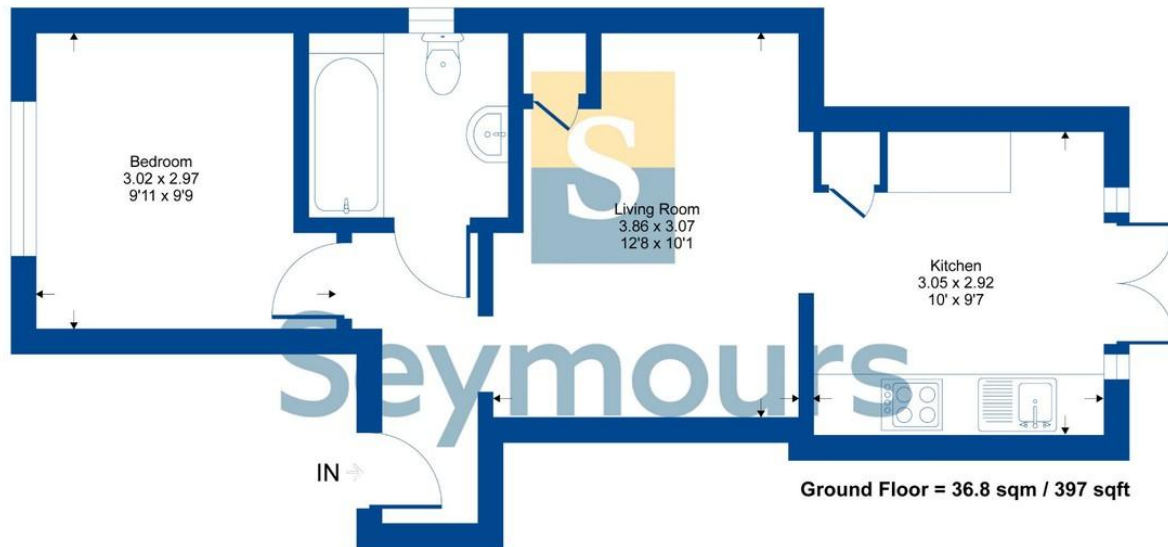

Ground Floor = 36.8 sqm / 397 sqft

Whilst every attempt has been made to ensure the accuracy of the floor plan contained here, measurements of doors, windows, rooms and any other items are approximate and no responsibility is taken for any error, omission or mis-statement. This plan is for illustrative purposes only and should be used as such by any prospective purchaser.



Seymours Blackwater Office 6 Kings Parade, 34 London Road, Blackwater, Camberley, Surrey, GU17 9AA  
01276 534100 / james@seymours-blackwater.co.uk / seymours-estates.co.uk

The information contained in these Sales Particulars does not form part of any contract neither is any warranty given or implied by Seymours or their clients as to the accuracy of measurements of details stated. Every effort is made to ensure that our Sales Particulars are correct and reliable. We do not test service, systems and appliances and we are unable to verify they are in working order.