

Property Description

Offered with NO ONWARD CHAIN is a THREE BEDROOM SEMI DETACHED house with OFF STREET PARKING and a 60FT GARDEN. The property is LOCATED CLOSE TO CLOCKHOUSE PRIMARY SCHOOL and is also JUST A SHORT WALK FROM COLLIER ROW HIGH STREET. Call KEYSTONES TODAY to book your INTERNAL VIEWING!!

The property enters into an entrance hallway with stairs leading to the first floor. There is a WC to the right and a door into a 24ft dual aspect lounge diner to your left with a door leading to the garden. The kitchen is located to the rear. The first floor offers a landing with access into the loft, three bedrooms and the main family bathroom. Externally the property has off street parking to the front with a shared side access leading round the rear garden.

Entrance Hallway

WC

Lounge/Diner - 24'2 x 12'5

Kitchen - 11'9 x 7'4

Landing

Bedroom 1 - 12'2 x 12'1

Bedroom 2 - 11'5 x 10'2

Bedroom 3 - 8'6 x 7'9

Bathroom

Rear Garden

Off street parking

Keystones property also offer a professional, ARLA accredited Lettings and Management Service. If you are considering renting your property in order to purchase, are looking at buy to let or would like a free review of your current portfolio then please call the Lettings Branch Manager on the number shown above.

Disclaimer: Information provided about this property does not constitute or form part of an offer or contract, nor may be it be regarded as representations. All interested parties must verify accuracy and your solicitor must verify tenure/lease information, fixtures & fittings and, where the property has been extended/converted, planning/building regulation consents.

All dimensions are approximate and quoted for guidance only as are floor plans which are not to scale and their accuracy cannot be confirmed. Reference to appliances and/or services does not imply that they are necessarily in working order or fit for the purpose.

"Our Service is Key"

**3 Bedroom
Semi-Detached House
Offers In Region Of £380,000
Boxmoor Road, Collier Row, Romford, RM5 2SH**



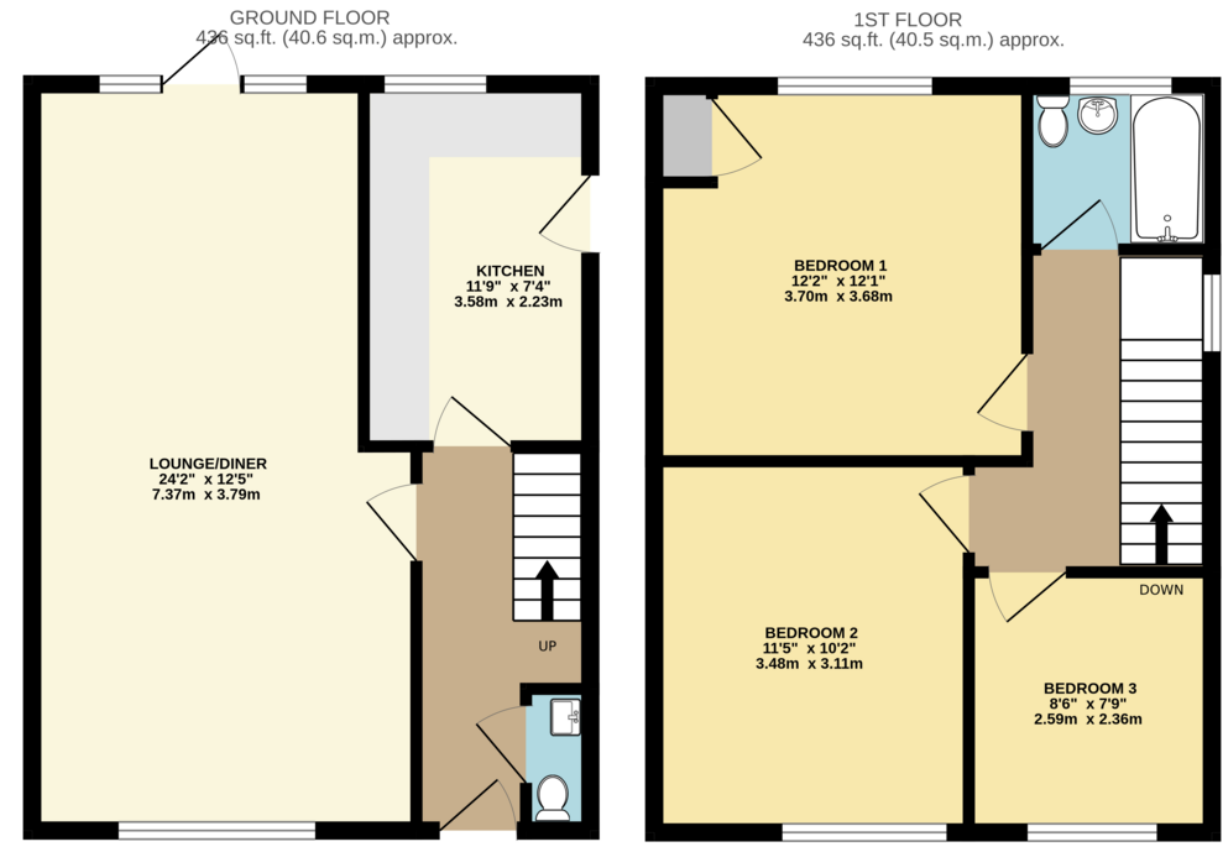

TOTAL FLOOR AREA : 873 sq.ft. (81.1 sq.m.) approx.
 Whilst every attempt has been made to ensure the accuracy of the floorplan contained here, measurements of doors, windows, rooms and any other items are approximate and no responsibility is taken for any error, omission or mis-statement. This plan is for illustrative purposes only and should be used as such by any prospective purchaser. The services, systems and appliances shown have not been tested and no guarantee as to their operability or efficiency can be given.
 Made with Metropix ©2023