



Seymours



Frogmore Park Drive
Camberley, GU17 0PJ

£575,000

Council Tax Band E

Council Tax £2,428.62

Freehold

Arrange a viewing: 01276 534100

Property Details

 4 bedrooms

 2 baths

 EPC Rating TBC

 1553 sqft (Excluding Garage)

 Blackwater (0.8 miles)

- No onward chain
- Four bedrooms
- Spacious Living room
- Dining room
- Bathroom and Shower room
- Mature and attractive rear garden
- Driveway leading to garage.
- Close to shops, amenities, and railway station & Good local schools

Offered to the market with no onward chain this spacious detached chalet benefits from a mature rear garden as well as plenty of driveway parking leading to the garage. The property itself has a large Living room as well a kitchen and a dining room . There is also a downstairs bedroom which could be used as a family room/study and a bathroom . Over the years upstairs has been converted and now comprises of three good bedrooms and a shower room . The property is conveniently located for the local shops, amenities, and station at Blackwater as well as good local schools and attractive countryside close by at Hawley Woods and Yateley Common.

[01276 534100](tel:01276534100) / james@seymours-blackwater.co.uk

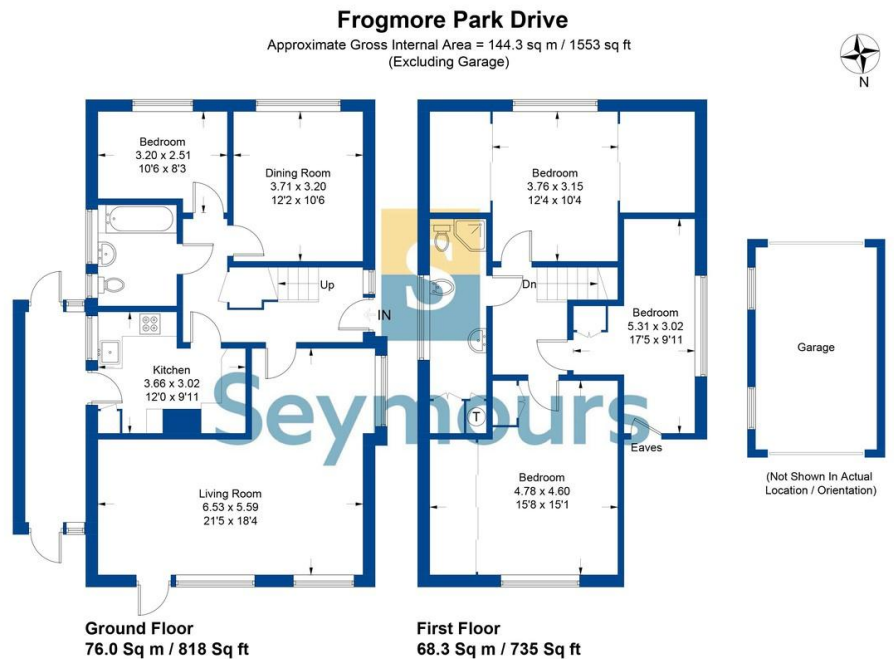

Illustration for identification purposes only, measurements are approximate, not to scale. FloorplansUsketch.com © 2023 (ID979578)