





Seymours



Frogmore Park Drive
Camberley, GU17 0PJ
£465,000 Guide Price

Arrange a viewing: 01276 534100

Property Details

-  3 bedrooms
-  1 baths
-  EPC Rating TBC
-  1073 sqft
-  Station Name (0.0 miles)

- Three bedrooms
- Living room
- Dining room
- Kitchen/Breakfast room
- Bathroom
- Mature rear garden
- Driveway Parking
- Mature rear garden
- Convenient for local schools

****COMING SOON**** A fabulous semi-detached three bedroom home which is located in this popular road in Frogmore and benefits from a superb mature rear garden. The property itself has a lovely living room with a brick fireplace as well as a dining room and a modern Kitchen/Breakfast room overlooking the garden. Upstairs there are three bedrooms and a modern bathroom. The property is located conveniently for Blackwater and the local shops, amenities and railway station as well as good local schools and excellent road links.

[01276 534100](tel:01276534100) / james@seymours-blackwater.co.uk

Frogmore Park Road

Approximate Gross Internal Area = 87.6 sq m / 943 sq ft
Garage = 12.1 sq m / 130 sq ft
Total = 99.7 sq m / 1073 sq ft

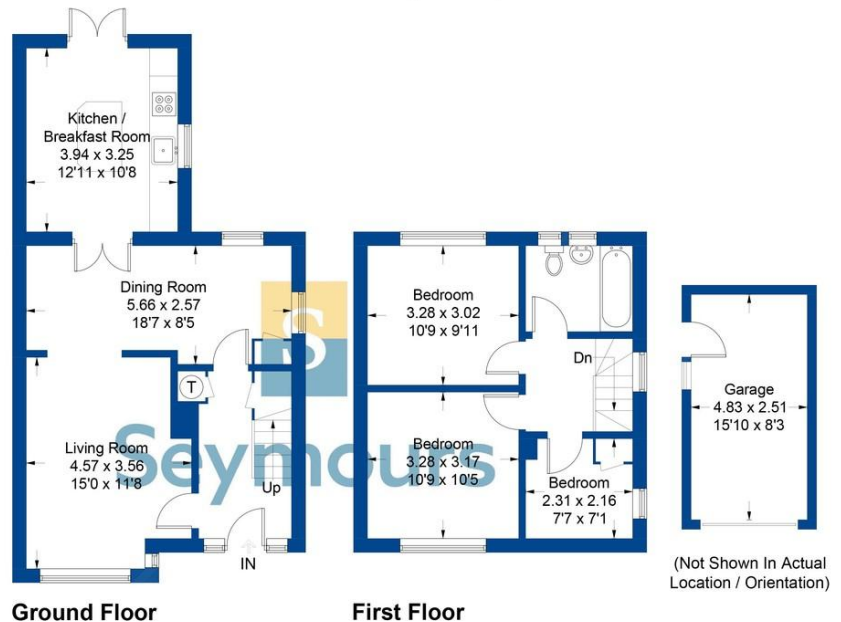

Illustration for identification purposes only, measurements are approximate, not to scale. FloorplansUsketch.com © 2020 (ID 694971)