



Shelone Terrace, offers in the region of £145,000

- Well Presented
- Ideal First Time Purchase
- Good Size Garden
- Potential for Off Street Parking *STPP
- Family Home
- EPC Rating: D



 3  1  1



About the property

The perfect Family Home, First Time Purchase or Buy To Let Investment! With fantastic links to local amenities including a train station, well renowned schools such as Ysgol Tyle'r Ynn and Ysgol Carreg Hir, and Neath Town Centre with high street stores, bars, restaurants and bus routes! Great for commuters with access to the M4 corridor, and !465 onto the A470! The home is approached through a gated forecourt offering great potential for off street parking (*STPP), side access is available through to an enclosed rear garden laid with tiers of patio and lawn. Internally, the property comprises of an entrance hallway, with stairs to the landing, and a door through to the reception space, split into lounge and diner but functionally used as a living room and fourth bedrooms. The property then flows through to a modern fitted kitchen, ground floor w.c and utility cupboard under the stairs. The first floor houses all three double bedrooms and the family bathroom!

Internal viewings are highly recommended to truly appreciate this property!

Potential for off-street parking to the front! *STPP





Accommodation

Entrance Hallway

Cloakroom

Lounge

12' 8" Max x 10' 7" (3.86m Max x 3.23m)

Dining Room

10' 2" x 9' 1" Max (3.10m x 2.77m Max)

Kitchen

9' 9" Plus Recess x 7' 2" (2.97m Plus Recess x 2.18m)

Landing

Bedroom One

12' 2" Max x 10' 6" (3.71m Max x 3.20m)

Bedroom Two

10' 1" x 7' 9" (3.07m x 2.36m)

Bedroom Three

10' 6" x 8' (3.20m x 2.44m)

Bathroom

Front & Rear Gardens

Agents Note

*Subject To Planning Permissions

Floorplan

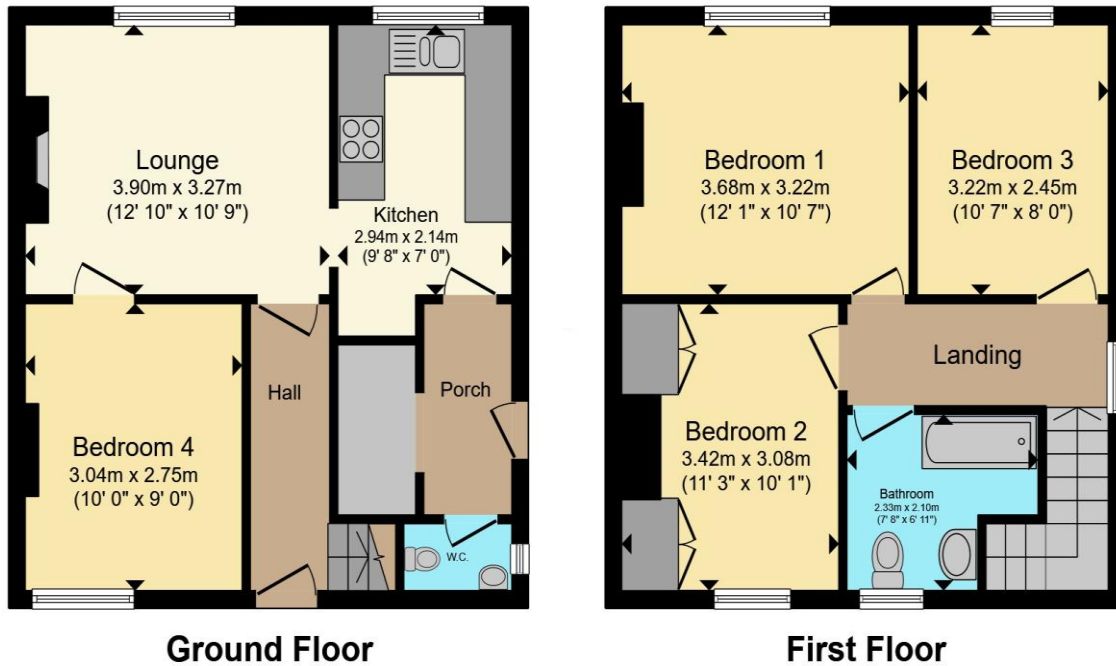

Total floor area 84.0 m² (904 sq.ft.) approx

This floor plan is for illustrative purposes only. It is not drawn to scale. Any measurements, floor areas (including any total floor area), openings and orientation are approximate. No details are guaranteed, they cannot be relied upon for any purpose and they do not form part of any agreement. No liability is taken for any error, omission or misstatement. A party must rely upon its own inspection(s). Powered by www.propertybox.io



Important Information

Note while we endeavour to make our sales details accurate and reliable, if there is any point which is of particular interest to you, please contact the office and we will be pleased to confirm the position for you. We have not personally tested any apparatus, equipment, fixtures, fittings or services and cannot verify they are in working order or fit for their purposes. Nothing in these particulars is intended to indicate that carpets or curtains, furnishings or fittings, electrical goods (whether wired or not). Gas fires or light fittings or any other fixtures not expressly included form part of the property offered for sale. This computer generated Floorplan, if applicable, is intended as a general guide to the layout and design of the property. It is not to scale and should not be relied upon for dimensions. Tenure: We cannot confirm the tenure of the property as we have not had access to the legal documents. The buyer is advised to obtain verification from their solicitor or surveyor.

Peter Alan Limited is registered in England and Wales under company number 2073153, Registered Office is Cumbria House, 16-20 Hockliffe Street, Leighton Buzzard, Bedfordshire, LU7 1GN. VAT Registration Number is 500 2481 05. For activities relating to regulated mortgages and non-investment insurance contracts, Peter Alan Limited is an appointed representative of Connells Limited which is authorised and regulated by the Financial Conduct Authority. Connells Limited's Financial Services Register number is 302221. Most buy-to-let