



## 7 Dorchester Drive, Royton, Oldham OL2 5AU

This is an extended, semi-detached bungalow style property in this sought after and pleasing location on Dorchester Drive, which is a well regarded crescent off Cumberland Drive, off Sheepfoot Lane and consequently within easy reach of all amenities.

£124,950

## 7 Dorchester Drive, Royton, Oldham OL2 5AU

This is an extended, semi-detached bungalow style property in this sought after and pleasing location on Dorchester Drive, which is a well regarded crescent off Cumberland Drive, off Sheepfoot Lane and consequently within easy reach of all amenities. The accommodation comprises; L-shaped hallway, lounge, kitchen, two bedrooms and lean to extension at ground level (requires attention) and there is also a third bedroom first floor level. Externally there are garden areas to the front and rear with a side driveway leading to a garage and a general programme of improvement would be required to maximise the considerable potential available. Viewing recommended.

**HALLWAY** With uPVC entrance door, uPVC double glazed window, radiator, laminate flooring.

**LOUNGE** 17' 3 max" x 11' 0" (5.26m x 3.35m) With uPVC double glazed window, two panel radiators, laminate flooring.

**KITCHEN** 10' 0" x 9' 6" (3.05m x 2.9m) With fitted wall and base units with stainless steel sink unit, uPVC double glazed window.

**BEDROOM ONE** 15' 5" x 11' 0" (4.7m x 3.35m) With fitted wardrobes, two radiators.

**BEDROOM TWO** 10' 0" x 7' 10" (3.05m x 2.39m) With single glazed window, radiator, laminate flooring.



**BATHROOM** With three piece suite white comprising of panelled bath, pedestal wash hand basin and low level w.c, fully tiled walls, radiator, double glazed window.



### FIRST FLOOR

**BEDROOM THREE** 17' 11" x 17' 2 max" (5.46m x 5.23m) With uPVC double glazed windows to the front and rear, fitted wardrobes, radiator, built in eaves cupboard.



**EXTERNALLY** There are garden areas to the front and rear with a side driveway leading to a garage and a general programme of improvement would be required to maximise the considerable potential available.

**ADDITIONAL INFORMATION TENURE:** Freehold.  
Solicitors to confirm details.

**COUNCIL BAND:** C.

**VIEWING ARRANGEMENTS:** Strictly by appointment with the agents.



### Ground Floor

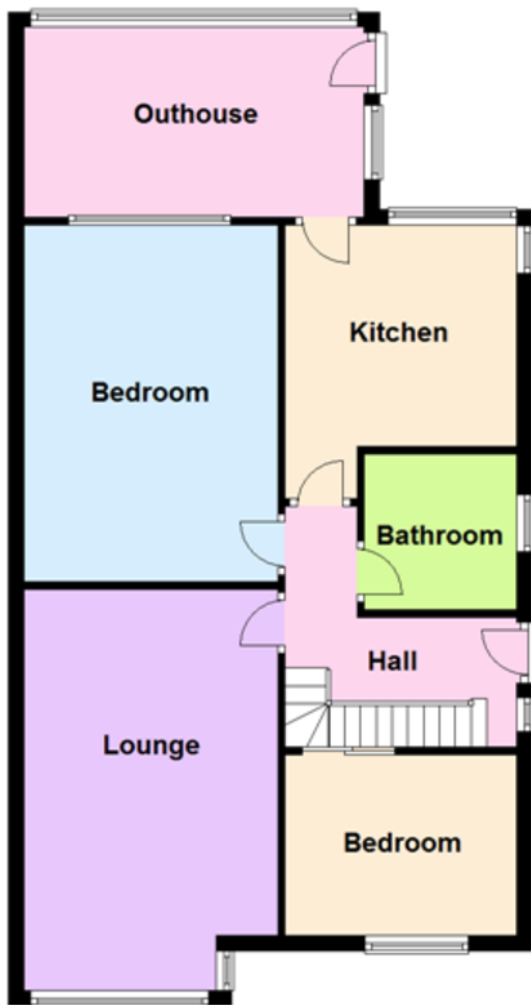

### First Floor



#### Additional information and viewing

Services: None of the services have been tested by the agent.

Viewing strictly by appointment with Alan Kirkham.

Royton Office

64 Rochdale Road

Royton

Oldham

OL2 6QJ

0161 626 9789

royton@alankirkham.co.uk

www.alankirkham.co.uk

NOTICE. Whilst every effort has been made to ensure the accuracy of these sales details, they are for guidance purposes only and prospective purchasers or lessees are advised to seek their own professional advice as well as to satisfy themselves by inspection or otherwise as to their correctness. No representation or warranty whatever is made in relation to this property by Alan Kirkham or its employees nor do such sales details form part of any offer or contract.