



Seymours





Christchurch Drive Camberley, GU17 0HH

£379,950 Guide Price

Arrange a viewing: 01276 534100

Property Details

-  3 bedrooms
-  0 baths
-  EPC Rating TBC
-  1263 sqft
-  Station Name (0.0 miles)

- NO ONWARD CHAIN
- Three bedrooms
- Living room
- Conservatory
- Kitchen
- Integrated garage with potential to convert subject to consents
- Downstairs cloakroom
- Bathroom

NO ONWARD CHAIN. A three bedroom home with a large living room, modern conservatory and a kitchen as well as a downstairs cloakroom which has been added and a garage which could easily lend itself to conversion subject to the usual consents. To the rear of the property is an attractive garden and to the front of the house is driveway parking. The house is conveniently located in Christchurch Drive which is ideal for good access to Blackwater and the local shops and amenities as well as a railway station and good local schools.

[01276 534100](tel:01276534100) / james@seymours-blackwater.co.uk

Christchurch Drive

Approximate Gross Internal Area = 117.4 sq m / 1263 sq ft
(Including Garage)

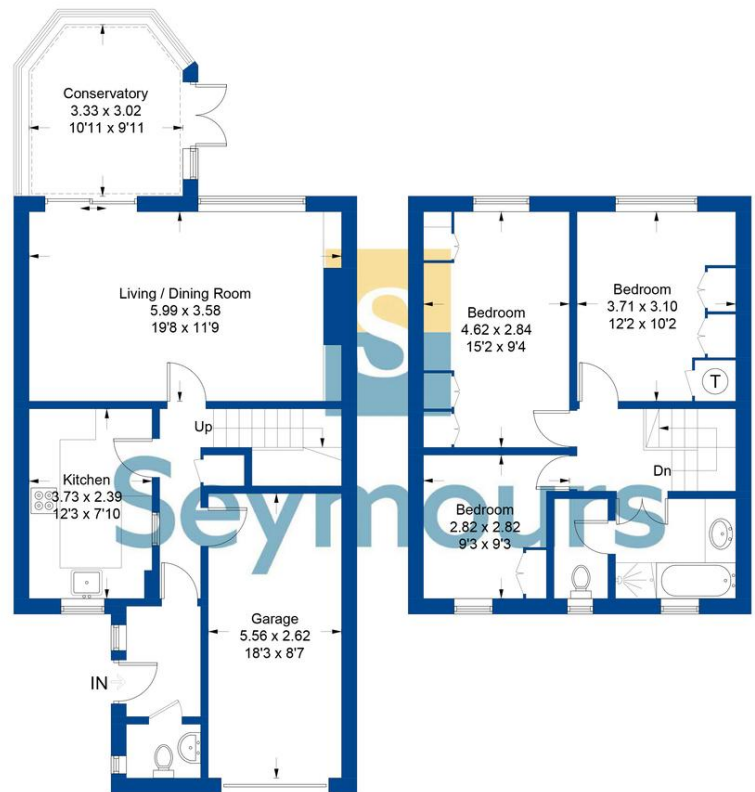

Ground Floor
71.4 sq m / 768 sq ft

First Floor
46.0 sq m / 495 sq ft