



Seymours



Bramley Lane
Camberley, GU17 0BY
£480,000 Guide Price

Arrange a viewing: 01276 534100

Property Details

- 4 bedrooms
- 1 baths
- EPC Rating TBC
- 1089 sqft
- Station Name (0.0 miles)

- Four bedrooms
- Cloak room
- Living room
- Kitchen
- Dining room
- Bathroom
- Driveway leading to the garage
- Bathroom
- Close to shops and amenities

A well proportioned four bedroom family home which is presented in good decorative order and is located in this popular close in Frogmore. The property benefits from a spacious living room as well as a kitchen and a dining room which could easily be opened up to create a spacious open plan Kitchen/breakfast room. To the rear of the property is a private and enclosed rear garden .The property also benefits from a driveway leading to a single garage. A particular feature of the area are the good local schools as well as local shops at Darby green and further shops, amenities and a railway station at Blackwater.

[01276 534100](tel:01276534100) / james@seymours-blackwater.co.uk

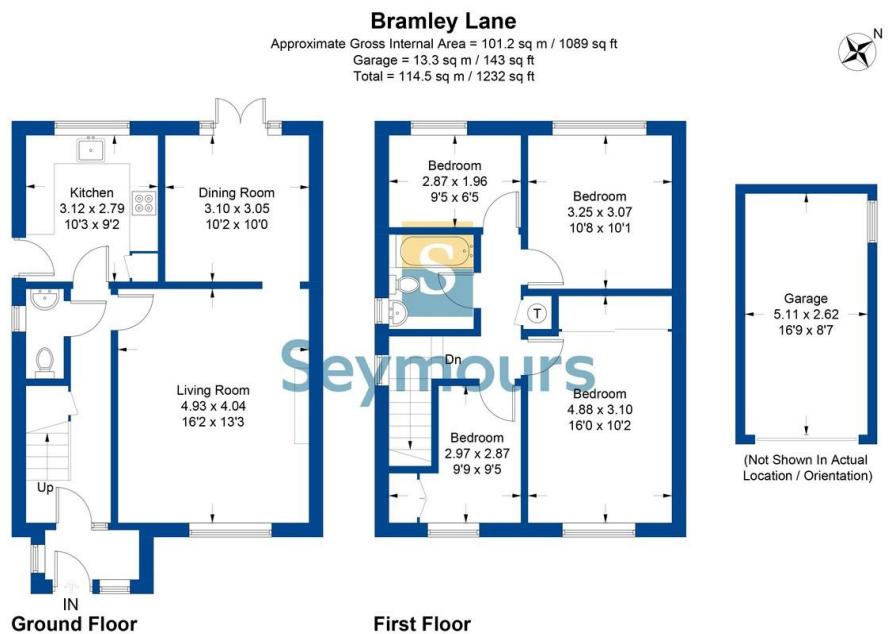

Illustration for identification purposes only, measurements are approximate, not to scale. FloorplansUsketch.com © 2023 (ID1024049)