

Agents Note: Whilst every care has been taken to prepare these sales particulars, they are for guidance purposes only. All measurements are approximate and whilst every care has been taken to ensure their accuracy, they should not be relied upon and potential buyers are advised to check the measurements

TOTAL APPROX. FLOOR AREA 998 SQ.FT. (92.7 SQ.M.)
Schematic Diagram only - Not to scale
Made with Metropix ©2019

1ST FLOOR
APPROX. FLOOR AREA 402 SQ.FT. (37.4 SQ.M.)

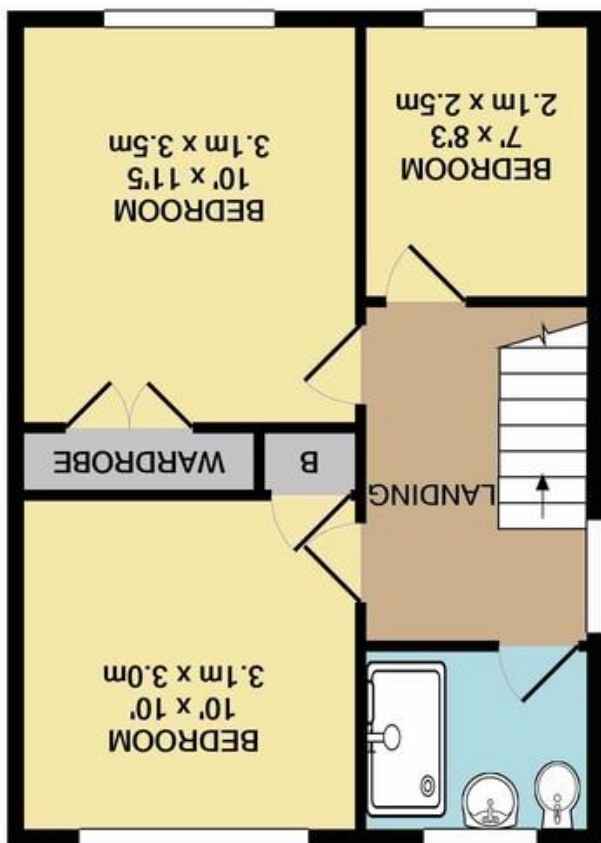

GROUND FLOOR
APPROX. FLOOR AREA 596 SQ.FT. (55.3 SQ.M.)

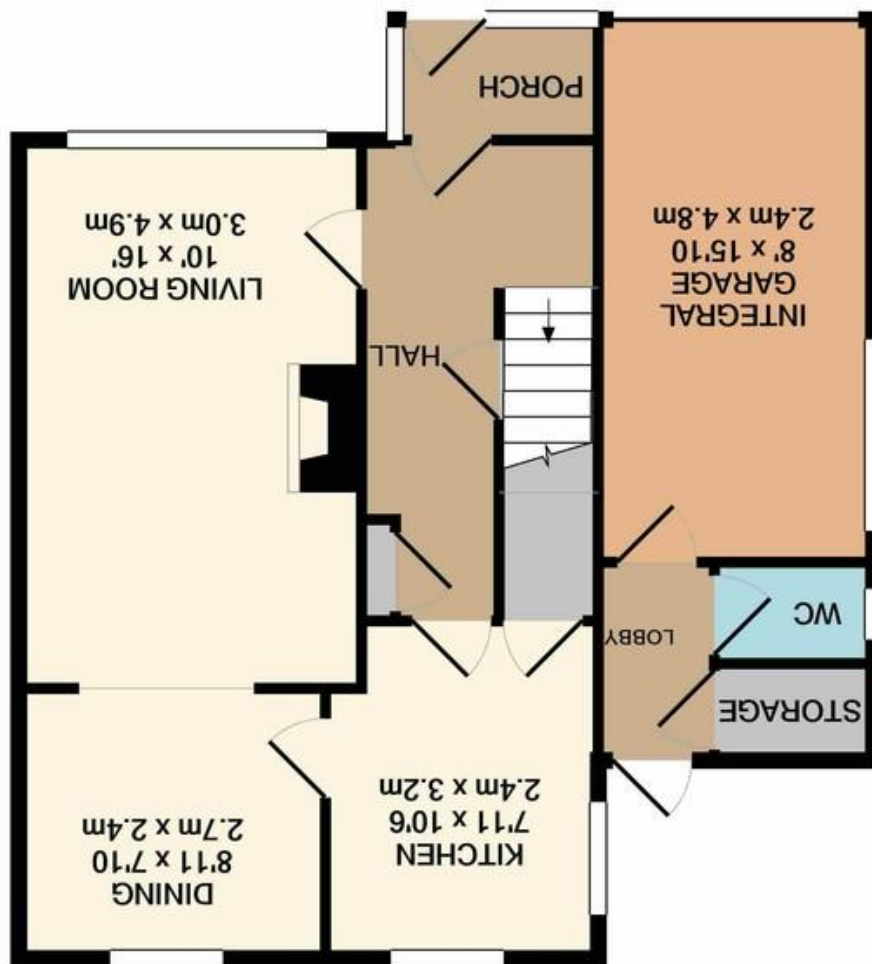

20 Woodborough Road, Corsham, Wiltshire, SN13 9AR

David Ingram
RESIDENTIAL

20 Woodborough Road, Corsham, Wiltshire, SN13 9AR

- Three bedroom semi detached house
- Scope to extend (subject to the necessary consents)
- Spacious plot
- Sought after location
- In need of some updating
- UPVC double glazing and gas central heating
- Garage and driveway parking
- NO ONWARD CHAIN

£275,000

Situation and Description

Offered for sale with no onward chain, this is a rare opportunity to purchase a property in need of some updating and enjoying a wonderful sized plot with potential to extend (subject to the necessary consents being granted). Situated on the sought after Broadmead development on the Prospect side of Corsham

The property offers well proportioned accommodation over two floors comprising entrance porch, hall, open plan sitting/dining room, kitchen, lobby with cloakroom and storage cupboard, integral garage with window to side, two double bedrooms, one single bedroom and a shower room (formerly a bathroom).

Externally, to the front of the property is a good sized driveway, and a level, gravelled garden with ornamental bushes and small trees. To the rear is a good sized, level garden laid to gravel with various seating areas. The garden is well enclosed and enjoys a good deal of privacy. The garage has a roller door to front, window to side and internal door to rear lobby.

The Broadmead development is situated on the sought after Prospect side of this popular market town and every facility is within walking distance including Corsham Primary (Ofsted outstanding), Heywood Prep, The Corsham School, sports centre, library, arts centre and cricket club as is the picturesque high street with its variety of interesting shops, cafes, pubs as well as Corsham Court with its lovely park and lake. More comprehensive shopping and leisure facilities are available in The World Heritage City of Bath (approximately nine miles) which has a mainline railway station with fast access to London (Paddington) as does nearby Chippenham (approximately about 4 miles). Junctions 16 and 17 of the M4 motorway are within easy reach and commuting distance of Bristol, Swindon and London.



Directions

From The Methuen Arms, proceed on the B3353 towards Melksham. Turn right at the mini roundabout into Pound Mead, continue straight on at the roundabout and over the railway bridge. Take the left hand turning into Broadmead and follow the road round to the left. Turn right into Woodborough Road where the property can be found on the right hand side.