



Sibdon Grove, West Heath, Birmingham, B31 3RH | £125,000
Two Bedroom End-Terraced House

Features:

- Two Bedrooms
- Bathroom
- Lounge/Diner
- Kitchen, Breakfast Room and Utility Room
- Low Maintenance Rear Garden
- No Upward Chain

Summary:

A well proportioned two bedroom end-terraced house, offered with no upward chain, a lounge/diner, kitchen and low maintenance rear garden, situated in West Heath, Birmingham.

Description:

The accommodation, in brief, features:- Enclosed Porch, Hall, Lounge/Diner with Fireplace and French Doors to Rear Garden, Kitchen, Breakfast Room with Door to Rear Garden, Utility Room, Stairs to First Floor Landing, Master Bedroom with Built In Wardrobe, Double Bedroom Two and Main Bathroom.

Outside:

Outside, the property benefits from having a low maintenance rear garden with paved patio with steps up to a low maintenance gravelled area with fenced boundaries.

Location:

Sibdon Grove is well located for several nearby schools and nearest train station offering connections to Redditch and Birmingham. West Heath offers good access to the M5, M42 and A38 as well as plenty of green space including the Waseley and Lickey Hills. Nearby is Birmingham Great Park and the new Longbridge development offering excellent shop, restaurants and entertainment facilities.



Room Dimensions:

Porch

2' 7" x 6' 7" (0.79m x 2.01m)

Hall

Lounge/Diner:

22' 10" x 12' 7" (6.97m x 3.84m) max

Kitchen:

9' 10" x 9' 7" (3.00m x 2.93m)

Breakfast Room:

5' 4" x 7' 4" (1.64m x 2.24m)

Utility Room:

7' 10" x 5' 4" (2.41m x 1.64m)

Stairs To First Floor Landing

Master Bedroom:

16' 9" x 11' 4" (5.11m x 3.46m) max

Bedroom Two:

12' 8" x 8' 6" (3.88m x 2.60m) max

Bathroom:

7' 9" x 5' 6" (2.38m x 1.68m)

EPC: E

Council Tax Band: B

Tenure: Freehold

For more information on Sibdon Grove or to arrange a viewing, please call the Rubery Office on 0121 453 4349



Sibdon Grove, West Heath

Ground Floor



First Floor

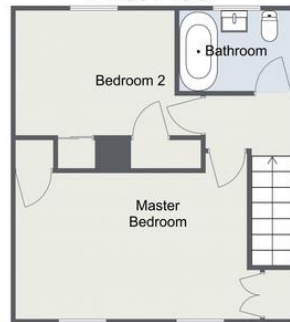

Total Area Approx
84.3 sq m
907.4 sq ft

For illustrative purposes only. Decorative finishes, fixtures & fittings do not represent the current state of the property. Measurements are approximate & not to scale. Floor Plans made using RoomSketcher.

Sibdon Grove, West Heath

Ground Floor



First Floor



Total Area Approx
84.3 sq m
907.4 sq ft

For illustrative purposes only. Decorative finishes, fixtures & fittings do not represent the current state of the property. Measurements are approximate & not to scale. Floor Plans made using RoomSketcher.

Please read the following: These particulars are for general guidance only and are based on information supplied and approved by the seller. Complete accuracy cannot be guaranteed and may be subject to errors and/or omissions. They do not constitute a contract or part of a contract in any way. We are not surveyors or conveyancing experts therefore we cannot and do not comment on the condition, issues relating to title or other legal issues that may affect this property. Interested parties should employ their own professionals to make enquiries before carrying out any transactional decisions. Photographs are provided for illustrative purposes only and the items shown in these are not necessarily included in the sale, unless specifically stated. The mention of any fixtures, fittings and/or appliances does not imply that they are in full efficient working order and they have not been tested. All dimensions are approximate. We are not liable for any loss arising from the use of these details.