



Seymours



22 Queensbury Place  
Camberley, GU17 9LX  
£345,000

Arrange a viewing: 01276 534100

## Property Details

 2 bedrooms

 1 baths

 EPC Rating TBC

 654 sq ft

 Blackwater

- End terrace home
- Desirable location
- Two bedrooms
- Modern Kitchen/breakfast room
- Living room
- Cloakroom
- Large garden
- Parking
- Convenient for local shops amenities and railway station



A fabulous end terrace home which benefits from a great garden as well as having a modern Kitchen/breakfast room, downstairs cloakroom and refitted modern bathroom. The property itself has two good bedrooms but has the potential to enlarge subject to the relevant consents because of the desirable location and larger than expected garden. It is tucked away in this very sought after close within the favoured Hawley Hill development and is convenient for local countryside at Hawley Woods as well as for local shops amenities and Railway station at Blackwater.

[01276 534100 / james@seymours-blackwater.co.uk](mailto:james@seymours-blackwater.co.uk)

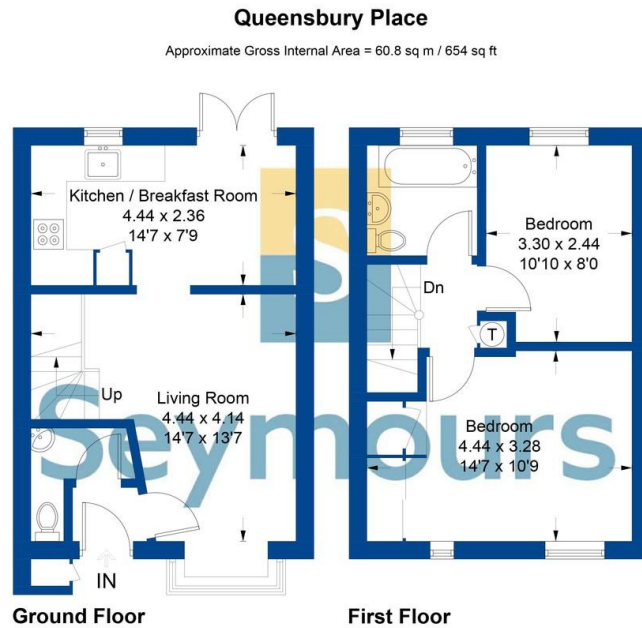

Illustration for identification purposes only, measurements are approximate, not to scale. FloorplansUsketch.com © 2021 (ID723872)