

Agents Note: Whilst every care has been taken to prepare these sales particulars, they are for guidance purposes only. All measurements are approximate and whilst every care has been taken to ensure their accuracy, they should not be relied upon and potential buyers are advised to recheck the measurements.

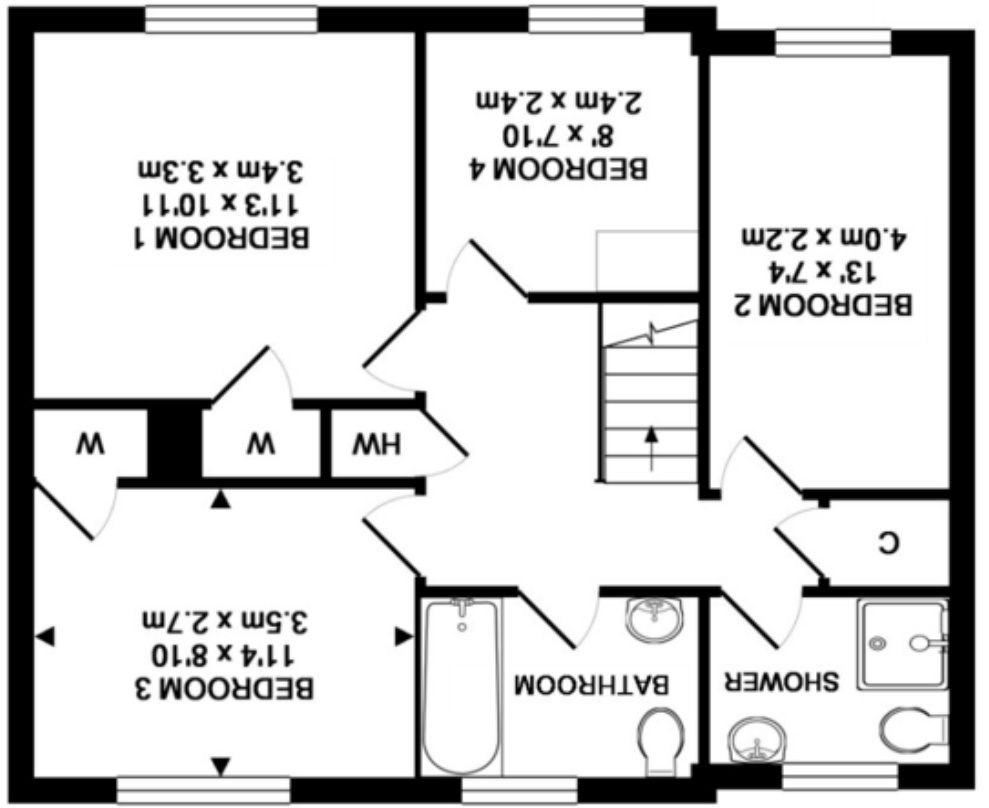

1ST FLOOR
APPROX. FLOOR
AREA 574 SQ.FT.
(53.4 SQ.M.)



TOTAL APPROX. FLOOR AREA 1157 SQ.FT. (107.5 SQ.M.)

The floor plan is provided in good faith and believed to be accurate, but location and sizes of rooms, doors and windows are provided for guidance only and as such should not be relied upon. If any aspect of the plan is important to you, please contact our office.
Made with Metropix ©2017

GROUND FLOOR
APPROX. FLOOR
AREA 583 SQ.FT.
(54.2 SQ.M.)

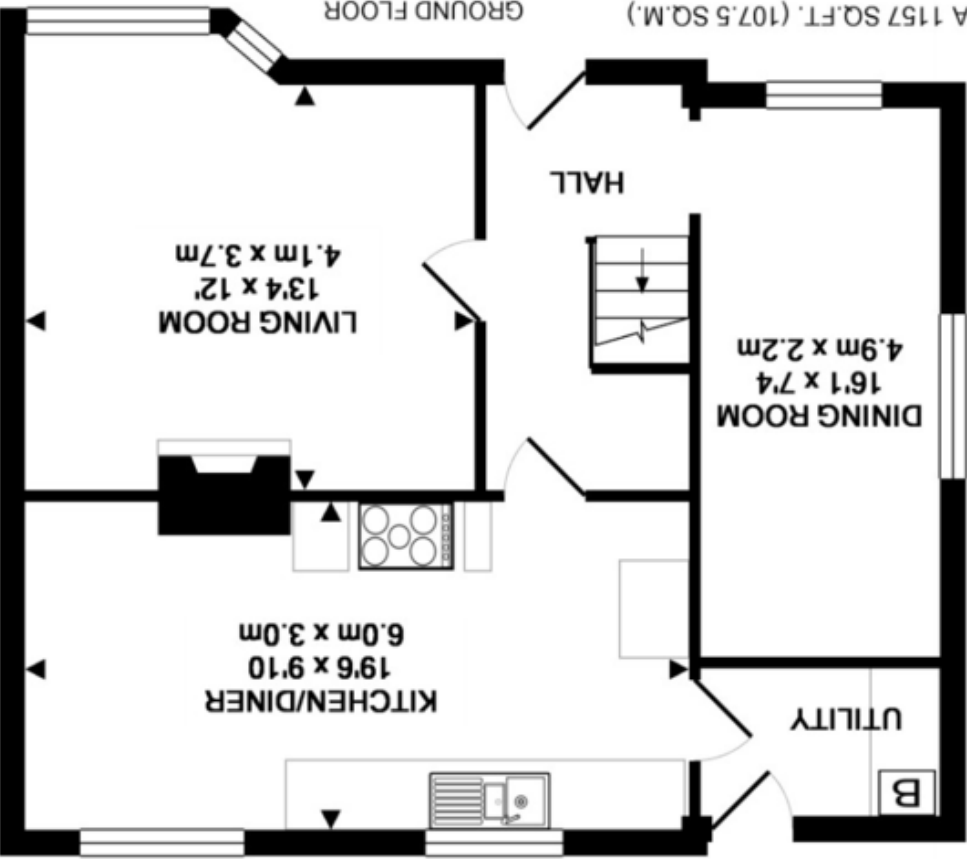

6 Providence Lane, Corsham, Wiltshire, SN13 9DJ



6 Providence Lane, Corsham, Wiltshire, SN13 9DJ

- Well presented throughout
- Four bedrooms
- Bathroom and shower room
- Good sized garden
- Level walking distance of amenities
- Two reception rooms
- Utility
- Off street parking

Guide Price - £389,950

Situation and Description

A well presented and conveniently located semi detached house which offers accommodation comprising entrance hall, sitting room with bay window, superb kitchen/dining room, family room, utility room, three double bedrooms, one single bedroom, bathroom with white suite and shower room.

Outside

Front
Driveway for parking two cars. Gated access to side leading to the rear garden.

Rear
Good sized, predominately lawned garden with paved patio seating area, shrub beds and ornamental bushes. The garden is well enclosed and enjoys a good deal of privacy.

Providence Lane is a sought after road which is situated within a few minutes walk of Corsham's picturesque and historic high street which offers a variety of interesting shops, cafes and restaurants. Other local amenities include junior and comprehensive schooling, doctors surgery and leisure centre. Ideally placed for access to the A4, the Georgian city of Bath is within 9 miles with it's vast array of shopping, cultural and leisure amenities and high speed rail service to London, which is also available at nearby Chippenham. There is also fast road access to the M4 motorway via junction 17.



Directions

From our office on the High Street turn right onto Pickwick Road, proceed over the mini roundabout and take the third turning on the left into Providence Lane where the property can be found on the right hand side.