

Offers In Excess Of **£260,000**

tel: **01442 214151**



Deaconsfield Road, Hemel Hempstead HERTS HP3 9HY

OPEN EVENT - SATURDAY FEBRUARY 1ST AT 11 AM. Clements are delighted to market this stunning two bedroom ground floor maisonette benefitting from driveway parking, spacious and light rooms with the most beautiful kitchen and open plan living area. The property also has a large fully enclosed rear garden accessed through the double glazed French doors off the living room. Miss it and miss out.

- GROUND FLOOR MAISONETTE
- TWO BEDROOMS
- STUNNING KITCHEN
- OPEN PLAN LIVING AREA
- DRIVEWAY PARKING



Property Description

OPEN EVENT - SATURDAY FEBRUARY 1ST AT 11AM.

Clements are delighted to market this stunning two bedroom ground floor maisonette benefitting from driveway parking, spacious and light rooms with the most beautiful kitchen and open plan living area. The property also has a large fully enclosed rear garden accessed through the double glazed French doors off the living room. Miss it and miss out.

ENTRANCE

Front door leading to:-

ENTRANCE HALL

Well decorated with doors to rooms.

LOUNGE/KITCHEN 17' 6" x 12' 9" (5.33m x 3.89m)

LOUNGE AREA

A well decorated room with a window to side and further windows and door to rear leading on to the garden, laminate wood flooring, TV point, opening leading to:-

KITCHEN AREA

A modern kitchen comprising a range of wall and floor mounted units, fitted work surfaces with an inset sink with mixer tap, built in oven with hob and extractor hood, space and plumbing for a dishwasher and washing machine, space for fridge freezer, part tiled walls.

MASTER BEDROOM 11' 6" x 10' 6" (3.51m x 3.2m)

Well decorated with laminate wood flooring, windows to front, wall mounted radiator.

BEDROOM TWO 9' 5" x 7' 3" (2.87m x 2.21m)

Laminate wood flooring, window to front, wall mounted radiator.

BATHROOM

A well decorated modern bathroom suite comprising a tiled panel enclosed bath with central mixer taps, pedestal wash hand basin, low level WC, tiled walls and flooring.

OUTSIDE

FRONT GARDEN

Parking to front and access to the side and front door.

REAR GARDEN

A very well kept mainly laid to lawn garden with a good sized patio area, wooden shed, fence enclosed with a gate to side for access.



Tenure **Share of Freehold**

Council Tax Band **B**

Viewing Arrangements **Strictly by appointment**

Contact Details

142 Marlowes
Hemel Hempstead
Hertfordshire
HP1 1EZ

Email: sales@clementsestateagents.co.uk

Tel: 01442 214151

www.clementsestateagents.co.uk

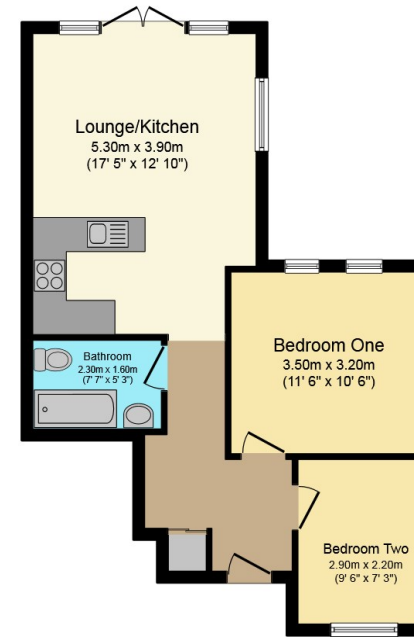

Floor Plan

Floor area 50.0 sq. m. (538 sq. ft.) approx

Total floor area 49.0 sq. m. (528 sq. ft.) approx

This Floor Plan is for illustration purposes only and may not be representative of the property. The position and size of doors, windows and other features are approximate. Unauthorized reproduction prohibited. © PropertyBOX

Agents Note: Whilst every care has been taken to prepare these sales particulars, they are for guidance purposes only. All measurements are approximate and are for general guidance purposes only and whilst every care has been taken to ensure their accuracy, they should not be relied upon and potential buyers are advised to recheck the measurements.