

Property Description

Perfectly located in this quiet turning and benefiting from large resin driveway for multiple cars! This three-bedroom family home has been decorated to a high standard throughout. To the ground floor there is an excellent size living room leading throughout to kitchen/diner with Kardean herringbone flooring. There are three bedrooms on the first-floor master bedroom offering excellent views of nearby fields, as well as modern bathroom suite with Amtico flooring.

Perfectly located in this quiet turning and benefiting from large resin driveway for multiple cars! This three-bedroom family home has been decorated to a high standard throughout. To the ground floor there is an excellent size living room leading throughout to kitchen/diner with Kardean herringbone flooring. There are three bedrooms on the first-floor master bedroom offering excellent views of nearby fields, as well as modern bathroom suite with Amtico flooring.

Living Room – 19'11" x 11'10"

Kitchen/Diner – 19'09" x 9'10"

Landing

Bedroom One – 14'03" x 11'08"

Bedroom Two – 13'00" x 8'10"

Bedroom Three – 10'07" x 8'04"

Four Piece Family Bathroom – 7'10" x 5'06"

Rear Garden

Resin Driveway for Multiple Cars Disclaimer: Information provided about this property does not constitute or form part of an offer or contract, nor may it be regarded as representations. All interested parties must verify accuracy and your solicitor must verify tenure/lease information, fixtures & fittings and, where the property has been extended/converted, planning/building regulation consents. All dimensions are approximate and quoted for guidance only as are floor plans which are not to scale and their accuracy cannot be confirmed. Reference to appliances and/or services does not imply that they are necessarily in working order or fit for the purpose.

"Our Service is Key"

3 Bedroom

End Terraced House

Guide Price £425,000 - £450,000

Chigwell View, Collier Row, Romford, RM5 2JB



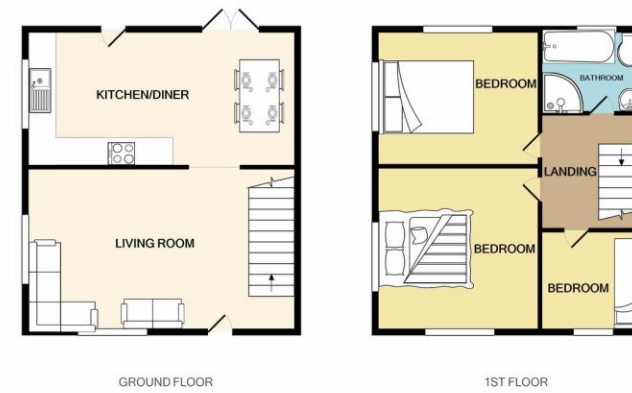

Whilst every attempt has been made to ensure the accuracy of the floor plan contained here, measurements of doors, windows, rooms and any other items are approximate and no responsibility is taken for any error, omission, or mis-statement. This plan is for illustrative purposes only and should be used as such by any prospective purchaser. The services, systems and appliances shown have not been tested and no guarantee as to their operability or efficiency can be given.
Made with Metropix ©2020