



Seymours



New Road Camberley, GU17 9AY

£350,000 Guide Price

Council Tax Band D

Council Tax £2,086.74

Freehold

Arrange a viewing: 01276 534100

Property Details

 3 bedrooms

 1 baths

 EPC Rating TBC

 978 sqft

 Station Name (0.0 miles)

- No onward chain
- Three bedrooms
- Living room
- Dining room
- Kitchen
- Large mature rear garden
- Convenient for local shops, amenities and railway station
- Council tax band D currently £2086.74 per annum



NO ONWARD CHAIN. A character home with a large garden that gives the incoming purchaser the chance to put their own stamp on the property as it does require some updating. It benefits from two reception rooms and a kitchen as well as a shower. Upstairs there are three good bedrooms. The house is conveniently located close to local shops, amenities and railway station at Blackwater as well as good local schools nearby and excellent road links.

[01276 534100](tel:01276534100) / james@seymours-blackwater.co.uk

New Road

Approximate Gross Internal Area = 90.9 sq m / 978 sq ft

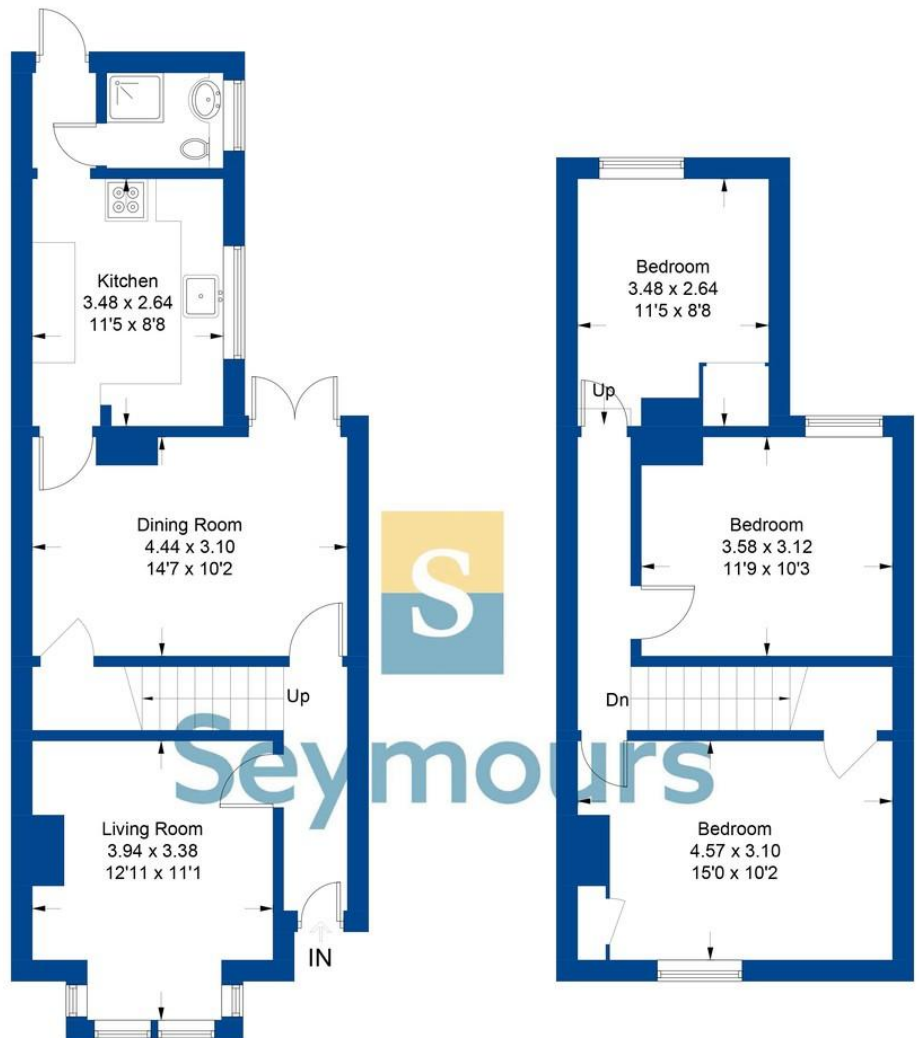

Ground Floor

First Floor

Illustration for identification purposes only, measurements are approximate, not to scale. FloorplansUsketch.com © 2023 (ID982064)