



Summerhill Avenue, £220,000

- Council Tax Band B
- Two separate 1-bedroom apartments
- Close to local amenities
- Occupied by sitting tenants
- Excellent public transport links
- EPC Rating: D



 3  2  2



About the property

We are delighted to present this unique opportunity for sale - an end of terrace property divided into two separate 1-bedroom apartments, both currently occupied by sitting tenants. This distinctive configuration makes this property a lucrative investment prospect, particularly appealing to investors looking for a steady income stream.

The property boasts two kitchens and two reception rooms, complementing the two bedrooms and two bathrooms, which ensures each apartment is self-contained and offers ample living space. This well-thought-out design ensures privacy and independence for the tenants, creating a desirable living situation that may support consistent rental income over time.

Located in a well-connected area with excellent public transport links, this property ensures ease of commute for the tenants. Furthermore, the vicinity is replete with local amenities, providing access to essential services and entertainment options. For those who prefer the outdoors, the property is also close to walking routes, offering a fine balance between urban convenience and natural beauty.

This property presents a truly remarkable opportunity for investors seeking a unique property configuration that promises a consistent return on investment. Its location, layout, and potential for improvement make it a noteworthy addition to any property portfolio.



Accommodation

Lower Flat

Kitchen/Dinner: 13.1 x 11.8
Living Room: 13.7 x 20
Bedroom: 10 x 13.4
Basement room: 13.4 x 12.9

Upper Flat

Kitchen: 6.6 x 8.8
Living Room: 13.6 x 11.9
Bedroom: 13.2 x 13.5
Loft room: 19.2 x 13.9

01633 221892

newport@peteralan.co.uk

Floorplan

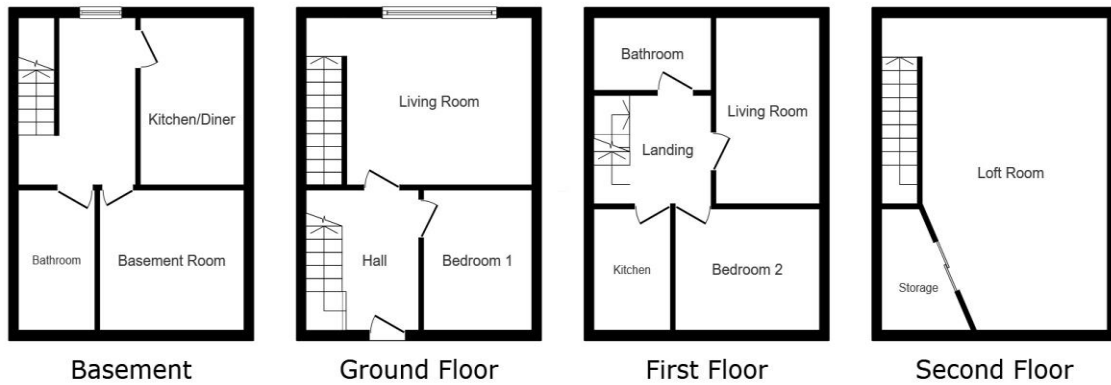

This floor plan is for illustrative purposes only. It is not drawn to scale. Any measurements, floor areas (including any total floor area), openings and orientations are approximate. No details are guaranteed, they cannot be relied upon for any purpose and do not form any part of any agreement. No liability is taken for any error, omission or misstatement. A party must rely upon its own inspection(s). Powered by www.Propertybox.io

Important Information

Note while we endeavour to make our sales details accurate and reliable, if there is any point which is of particular interest to you, please contact the office and we will be pleased to confirm the position for you. We have not personally tested any apparatus, equipment, fixtures, fittings or services and cannot verify they are in working order or fit for their purposes. Nothing in these particulars is intended to indicate that carpets or curtains, furnishings or fittings, electrical goods (whether wired or not). Gas fires or light fittings or any other fixtures not expressly included form part of the property offered for sale. This computer generated Floorplan, if applicable, is intended as a general guide to the layout and design of the property. It is not to scale and should not be relied upon for dimensions. Tenure: We cannot confirm the tenure of the property as we have not had access to the legal documents. The buyer is advised to obtain verification from their solicitor or surveyor.

Peter Alan Limited is registered in England and Wales under company number 2073153, Registered Office is Cumbria House, 16-20 Hockliffe Street, Leighton Buzzard, Bedfordshire, LU7 1GN. VAT Registration Number is 500 2481 05. For activities relating to regulated mortgages and non-investment insurance contracts, Peter Alan Limited is an appointed representative of Connells Limited which is authorised and regulated by the Financial Conduct Authority. Connells Limited's Financial Services Register number is 302221. Most buy-to-let

