



Russell Court
Camberley, GU17 0JP
OIEO £200,000

Property Details

 2 bedrooms

 1 baths

 EPC Rating TBC

 553 square foot

 Blackwater station 0.5 miles

- NO CHAIN
- Two bedrooms
- Full modernisation required
- Benefiting from a garage and garden
- Ground floor
- Conveniently located for Blackwater shops and amenities
- Share of freehold
-

An opportunity to purchase a ground floor two bedroom flat which benefits from being share of freehold and having a garage in a block as well as its own garden. The property does require full modernisation throughout and is brought to the market with no onward chain complications. It is conveniently located for Blackwater shops and local amenities as well as the railway station and would ideally suit a first time buyer wishing to put their own stamp on a property.



Property Details

Russell Court

Approximate Gross Internal Area = 51.3 sq m / 553 sq ft

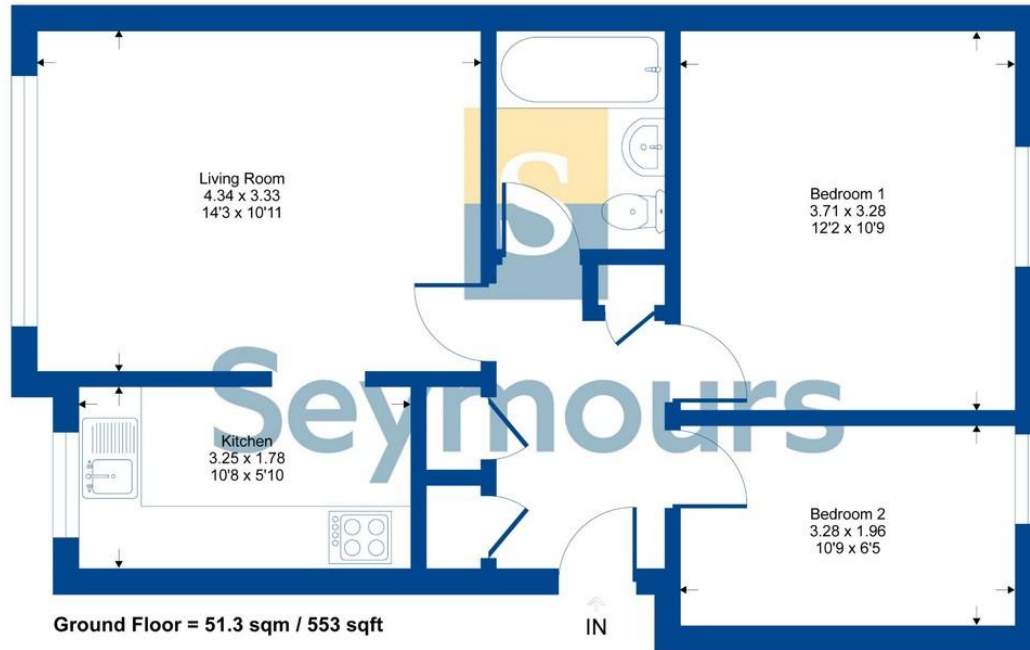

Ground Floor = 51.3 sqm / 553 sqft

Whilst every attempt has been made to ensure the accuracy of the floor plan contained here, measurements of doors, windows, rooms and any other items are approximate and no responsibility is taken for any error, omission or mis-statement. This plan is for illustrative purposes only and should be used as such by any prospective purchaser.



Seymours Blackwater Office 6 Kings Parade, 34 London Road, Blackwater, Camberley, Surrey, GU17 9AA

01276 534100 / james@seymours-blackwater.co.uk / seymours-estates.co.uk

The information contained in these Sales Particulars does not form part of any contract neither is any warranty given or implied by Seymours or their clients as to the accuracy of measurements of details stated. Every effort is made to ensure that our Sales Particulars are correct and reliable. We do not test service, systems and appliances and we are unable to verify they are in working order.