



## Cae Marchog, offers over £400,000

- Council Tax Band - E & EPC ratings - C
- Converted garage creating annex space
- Four double bedroom detached with Three bathrooms
- Conservatory leading from the modern kitchen/diner
- Beautifully presented throughout
- Spacious private front and rear gardens
- Driveway providing ample off-road



 4  3  3



## About the property

Situated in the sought-after area of Energlyn, in the popular town of Caerphilly, this beautifully presented four-bedroom detached property offers generous and flexible family accommodation throughout.

The ground floor comprises a welcoming living room, a well-appointed kitchen leading into a bright conservatory overlooking the rear garden, a study, & a spacious double bedroom. The former garage has been thoughtfully converted to create an annex space complete with an additional shower room, providing ideal accommodation for multi-generational living, guests, or independent teenagers.

To the first floor are three further bedrooms, a modern family bathroom with walk-in shower & Jacuzzi bath, offering excellent space for growing families.

## Accommodation

Externally the property benefits from spacious private gardens to both the front and rear, with attractive areas perfect for outdoor dining and entertaining. A driveway to the front provides ample off-road parking. Positioned on a quiet street, the home also enjoys direct access to the nearby mountain for scenic walks, while remaining conveniently close to local amenities, schools, and transport links. The property is within close proximity to Energlyn train station, which is approximately a 10 minute walk away, with trains to Cardiff Central and there are also bus routes nearby directly connecting to Caerphilly town centre.

A fantastic opportunity to acquire a spacious and versatile family home in a desirable & peaceful location.



02920 867611

caerphilly@peteralan.co.uk

## Floorplan



**Ground Floor**

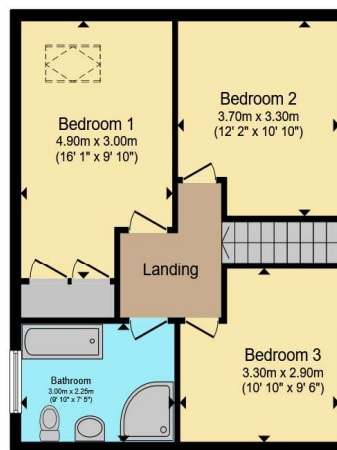

**First Floor**

Total floor area 158.1 m<sup>2</sup> (1,702 sq.ft.) approx

This floor plan is for illustrative purposes only. It is not drawn to scale. Any measurements, floor areas (including any total floor area), openings and orientation are approximate. No details are guaranteed, they cannot be relied upon for any purpose and they do not form part of any agreement. No liability is taken for any error, omission or misstatement. A party must rely upon its own inspection(s). Powered by [www.propertybox.io](http://www.propertybox.io)

## Important Information

Note while we endeavour to make our sales details accurate and reliable, if there is any point which is of particular interest to you, please contact the office and we will be pleased to confirm the position for you. We have not personally tested any apparatus, equipment, fixtures, fittings or services and cannot verify they are in working order or fit for their purposes. Nothing in these particulars is intended to indicate that carpets or curtains, furnishings or fittings, electrical goods (whether wired or not). Gas fires or light fittings or any other fixtures not expressly included form part of the property offered for sale. This computer generated Floorplan, if applicable, is intended as a general guide to the layout and design of the property. It is not to scale and should not be relied upon for dimensions. Tenure: We cannot confirm the tenure of the property as we have not had access to the legal documents. The buyer is advised to obtain verification from their solicitor or surveyor.

Peter Alan Limited is registered in England and Wales under company number 2073153, Registered Office is Cumbria House, 16-20 Hockliffe Street, Leighton Buzzard, Bedfordshire, LU7 1GN. VAT Registration Number is 500 2481 05. For activities relating to regulated mortgages and non-investment insurance contracts, Peter Alan Limited is an appointed representative of Connells Limited which is authorised and regulated by the Financial Conduct Authority. Connells Limited's Financial Services Register number is 302221. Most buy-to-let