

Agents Note: Whilst every care has been taken to prepare these particulars, they are for guidance purposes only. All measurements are approximate and whilst every care has been taken to ensure their accuracy, they should not be relied upon and potential buyers/tenants are advised to recheck the measurements.

WWW.EPC4U.COM

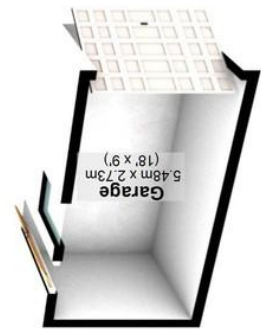

Total area: approx. 106.7 sq. metres (1148.4 sq. feet)  
All measurements are approximate  
Plan produced using Planip.

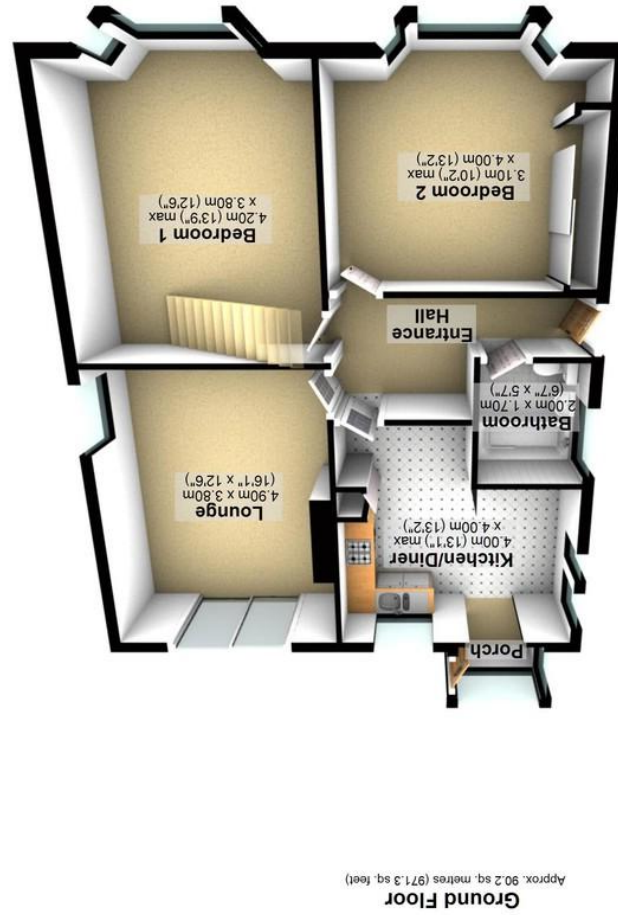
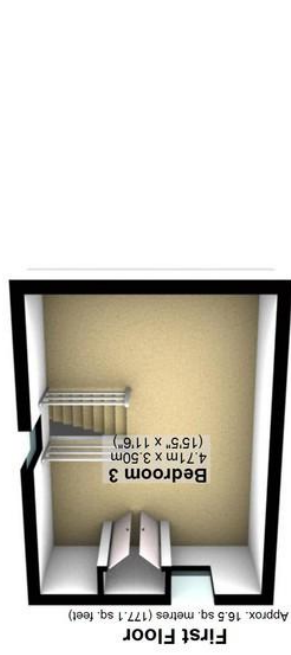



243 Baslow Road | Totley | Sheffield | S17 4DU

Property Tenure: Freehold

An incredibly rare opportunity has arisen to purchase this hugely deceptive three bedroomed, double fronted, bay windowed dormer detached bungalow. Enjoying a fabulous rear backdrop and with manageable rear private garden together with parking and detached garage this property is perfect for those looking to downsize or the family. With super light and spacious accommodation to the ground floor and third large double bedroom to the loft. Number 243 is offered to the open market with the benefit of no upward chain. Located in the very heart of well sought after Totley and on the cusp of The Peak District, a number local amenities are a short stroll away and regular public transport links are also on offer combined with high regarded



### PROPERTY FEATURES

- THREE BEDROOMED DETACHED DORMER BUNGALOW
- DOUBLE FRONTED AND BAY WINDOWED
- OFF ROAD PARKING AND DETACHED GARAGE
- PRIVATE REAR MANAGEABLE GARDEN
- STUNNING VIEWS TO THE REAR
- HEART OF WELL SOUGHT AFTER TOTLEY
- NUMEROUS LOCAL AMENITIES WITHIN A SHORT STROLL
- CLOSE TO THE PEAK DISTRICT
- FREEHOLD COUNCIL TAX BAND C - £1825.63
- IN THE CATCHEMENT FOR MANY HIGHLY REGARDED SCHOOLS

**OFFERS IN REGION OF £350,000**

