



Elm Wood Drive, offers in the region of £230,000

- Popular Residential Development
- Close To All Amenities And Excellent Road Links For M4 Corridor
- Ideal For The Family
- Double Parking And Double Garage
- Corner Plot Position
- EPC Rating: C



 3  1  2



About the property

Are you looking for a property with room for all the family? Take a look at this modern and move in ready three-bedroom detached family home in Tonyrefail. The property is positioned on the highly sought after estate of Mountain View and is just a short drive to Talbot Green retail park which offers a number of high street shops and restaurants. The M4 corridor is also just a short drive further.

The property is incredibly well maintained throughout and the accommodation comprises of; entrance hall, cloakroom, living room/ diner, a modern kitchen and a generous sized conservatory overlooking the rear garden. To the first floor there are three bedrooms, a modern family bathroom and stairs to the attic which has sky lights.



Accommodation

Lounge

16' 1" max x 15' 4" max (4.90m max x 4.67m max)

Kitchen

9' x 7' 6" (2.74m x 2.29m)

Conservatory

10' 6" x 10' 6" (3.20m x 3.20m)

Bedroom 1

15' 5" x 6' 10" (4.70m x 2.08m)

Bedroom 2

6' 10" x 7' 3" (2.08m x 2.21m)

Bedroom 3

6' 8" x 7' 8" (2.03m x 2.34m)

Attic Room

15' 7" max x 9' 7" max (4.75m max x 2.92m max)

01443 222851

talbotgreen@peteralan.co.uk

Floorplan

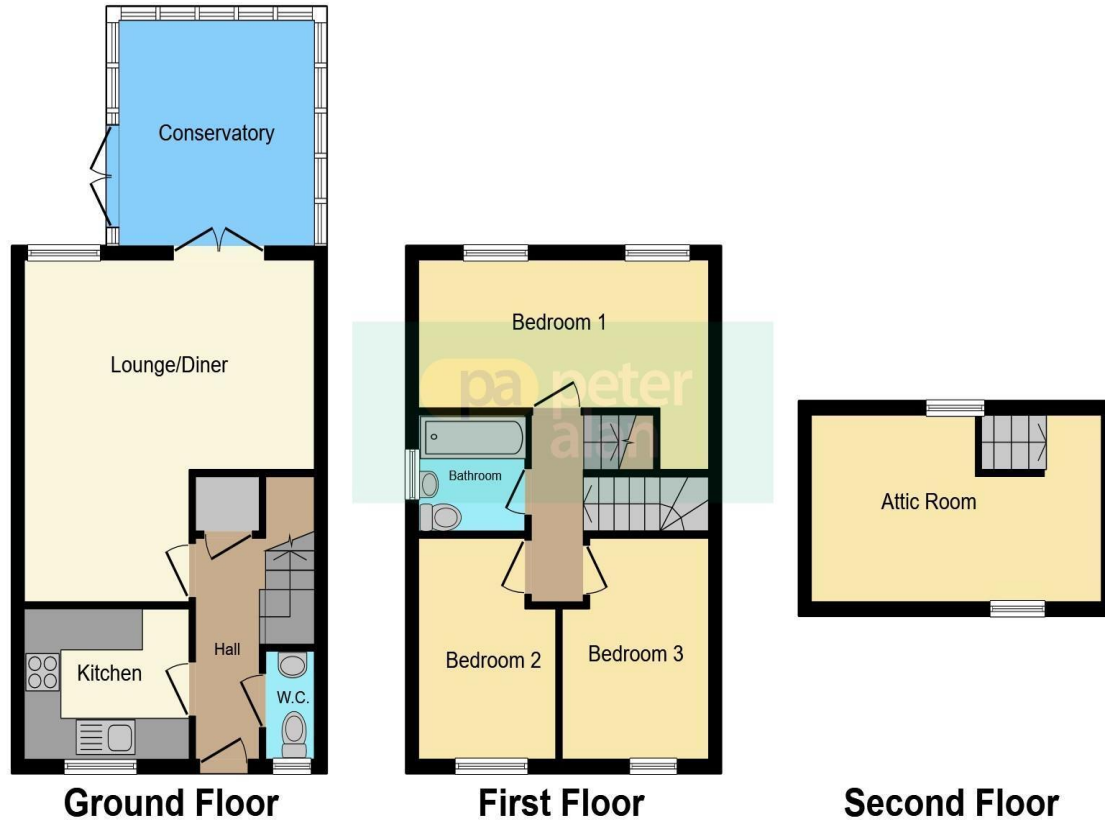

This floorplan is for illustrative purposes only and is not drawn to scale. Measurements, floor-areas, openings and orientations are approximate. They should not be relied upon for any purpose and do not form any part of an agreement. No liability is taken for any error or mis-statement. All parties must rely on their own inspections.

Important Information

Note while we endeavour to make our sales details accurate and reliable, if there is any point which is of particular interest to you, please contact the office and we will be pleased to confirm the position for you. We have not personally tested any apparatus, equipment, fixtures, fittings or services and cannot verify they are in working order or fit for their purposes. Nothing in these particulars is intended to indicate that carpets or curtains, furnishings or fittings, electrical goods (whether wired or not). Gas fires or light fittings or any other fixtures not expressly included form part of the property offered for sale. This computer generated Floorplan, if applicable, is intended as a general guide to the layout and design of the property. It is not to scale and should not be relied upon for dimensions. Tenure: We cannot confirm the tenure of the property as we have not had access to the legal documents. The buyer is advised to obtain verification from their solicitor or surveyor.

Peter Alan Limited is registered in England and Wales under company number 2073153. Registered Office is Cumbria House, 16-20 Hockliffe Street, Leighton Buzzard, Bedfordshire, LU7 1GN. VAT Registration Number is 500 2481 05. For activities relating to regulated mortgages and non-investment insurance contracts, Peter Alan Limited is an appointed representative of Connells Limited which is authorised and regulated by the Financial Conduct Authority. Connells Limited's Financial Services Register number is 302221. Most buy-to-let

