



Mid-Terraced Three Bedroom Home

A beautifully presented 3 bedroom mid-terraced property in Cranbrook featuring 3 bedrooms, family bathroom, a bright kitchen, spacious lounge diner and parking for 2 cars

5 Horse Field | Exeter | EX5 7JG



thoroughly good property agents



PROPERTY TYPE

Mid Terraced House



SIZE

904 sq ft



LOCATION

Cranbrook



AGE

Modern



BEDROOMS

3



RECEPTION ROOMS

1



BATHROOMS

1



WARMTH

EON District Heating System



PARKING

Off Road Parking



OUTSIDE SPACE

Garden



EPC RATING

85 B



COUNCIL TAX BAND

C



in a nutshell...

- Three Bedrooms
- 2 Parking Spaces
- Kitchen
- Spacious Lounge Diner
- Mid-Terraced
- Family Bathroom
- Close To Local Amenities
- Access To M5 & A30
- Short Drive From Exeter Airport





the details...

This attractive property offers a practical and well-proportioned layout, ideal for modern living. To the front of the home is a fitted kitchen, providing space for a fridge/freezer and washing machine, along with ample workspace and storage.

To the rear, the bright and spacious lounge/diner benefits from plenty of natural light and offers excellent versatility, with ample room for both living and dining areas-perfect for relaxing or entertaining.

Upstairs, the property comprises three bedrooms. The third bedroom is well suited as a nursery or home office, while the second bedroom is a generous double with plenty of space for furnishings. The principal bedroom is also a good size and benefits from space for wardrobes. The family bathroom includes a bath with shower over, wash basin, and WC.

Externally, the rear garden features a combination of patio and lawn areas, along with a useful shed for storage. To the front of the property, there are two allocated parking spaces.

This home is ideal for first-time buyers or families looking for a well-located property in a thriving community.



What the owner loves most...

What I love most is how spacious and bright the house feels. I also love how convenient the location is and how great it is to have a country park so close to the house.



the floorplan...

Approximate Gross Internal Area 904 sq ft - 84 sq m

Ground Floor Area 452 sq ft – 42 sq m

First Floor Area 452 sq ft – 42 sq m

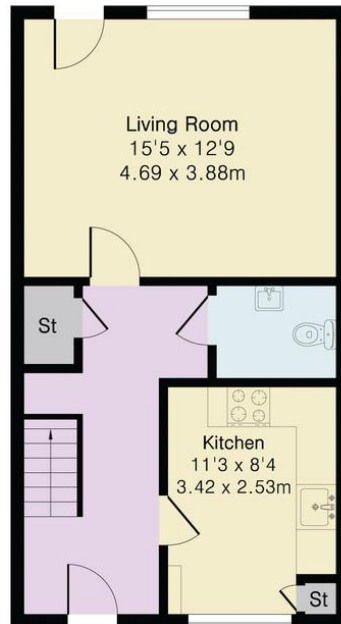

Ground Floor

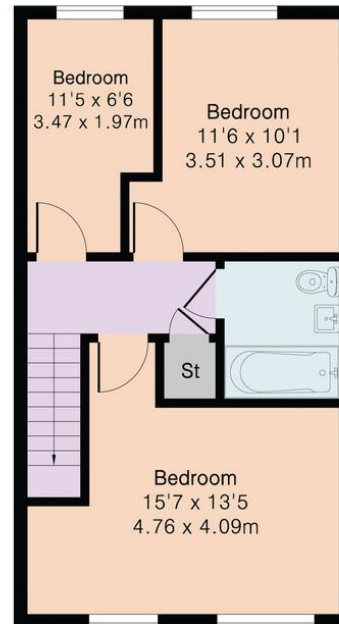

First Floor



Floor plan produced in accordance with RICS Property Measurement 2nd Edition. Although Pink Plan Ltd ensures the highest level of accuracy, measurements of doors, windows and rooms are approximate and no responsibility is taken for error, omission or misstatement. These plans are for representation purposes only and no guarantee is given on the total square footage of the property within this plan. The figure icon is for initial guidance only and should not be relied on as a basis of valuation.

complete.

Our note. For clarification we have prepared these sales particulars as a general guide and have not carried out a detailed survey nor tested the services, appliances or fittings. Room sizes should not be relied upon for carpets or furnishings. If there are any important matters which are likely to affect your decision to buy, please contact us before viewing this property. These particulars, whilst believed to be accurate, are set out as a general outline only for guidance and do not constitute any part of an offer or contract. Intending purchasers should not rely on them as statements of representation of fact, but must satisfy themselves by inspection or otherwise as to their accuracy. No person in the employment of Complete Property Services has the authority to make or give any representation or warranty in respect of the property.

SKETCH PLAN FOR ILLUSTRATIVE PURPOSES ONLY. All measurements and sizes and locations of walls, doors, window fittings and appliances are shown conventionally and are approximate only and cannot be regarded as being a representation either by the Seller or his Agent. We hope that these plans will assist you by providing you with a general impression of the layout of the accommodation. The plans are not to scale nor accurate in detail. © Unauthorised reproduction prohibited.

As part of the service we offer we may recommend ancillary services to you which we believe will help with your property transaction. We wish to make you aware that should you decide to proceed we will receive a referral fee. This could be a fee, commission, payment or other reward. We will not refer your details unless you have provided consent for us to do so. You are not under any obligation to provide us with your consent or to use any of these services, but where you do you should be aware of the following referral fee information. You are also free to choose an alternative provider. To find out more about this, please speak to a member of the team.



bear in mind...

This property is currently Shared-Ownership and is therefore subject to the Devon Rule.

Ask us about this.



the location...

Shopping – Morrisons and Co-Operative

**Relaxing – The Cranbrook Country Park and
The Cranberry Farm**

**Travel – Local access to the M5 and A30 as well
as Exeter Airport being only a short drive
away. This property also benefits from a bust
stop being a short walk away providing direct
routes into Exeter City Centre.**

**Schools – St Martins C of E Primary School and
the Cranbrook Education Campus**

Please check Google maps for exact distances and travel times.

Property postcode: **EX5 7JG**





Need a more complete picture? Get in touch with your local branch...

Tel **01392 422500**
Email exeter@completeproperty.co.uk
Web completeproperty.co.uk

Complete
141 Younghayes Rd
Cranbrook
EX5 7DR

Are you selling a property too? Call us to get a set of property details like these...

selling

letting

land &
new homes

signature
homes

complete.