



STUART THOMAS  
ESTATES



- DETACHED BUNGALOW
- MODERN INTERIOR THROUGHOUT
- THREE DOUBLE BEDROOMS
- LARGE ROOF LANTERN

2 Cross Road, Thundersley , Essex, SS7 1RP

Guide Price £550,000

A cleverly extended THREE double bedroom detached bungalow perfect for entertaining. The property is IMMACULATE throughout with bifold doors leading to the garden & patio area. Situated in a great location just a short walk from local shops, King John School and close to local bus routes.



## Property Description

### GENERAL

A cleverly extended THREE double bedroom detached bungalow

A bright spacious layout, perfect for entertaining. This property provides good size living throughout offering a generous sized lounge IMMACULATE throughout with bifold doors leading to the garden & patio area.

Situated in great location, you are just a short walk from local shops, close to local bus routes and the school CATCHMENT is King John School which is just a short walk away.

### ENTRANCE HALL

Wood effect laminate flooring, large radiator, access to the loft which has a loft ladder.

### LOUNGE/FAMILY ROOM

19' 0" x 12' 2" (5.812m x 03.728m) Modern & bright lounge/diner with bi-fold doors leading to the rear garden. Stunning roof lantern. Newly fitted wood effect flooring. Large radiator. Spacious utility cupboard.

### KITCHEN

10' 6" x 7' 3" (3.206m x 2.227m) Stunning newly fitted modern kitchen. Range of blue & grey units at eye and base level with granite work surfaces. Belfast sink unit with mixer tap over. Double glazed window to the side. Integrated dishwasher. Ceramic 4 ring electric hob with a built under oven. Extractor cooker hood. Wood effect laminate flooring.

### BEDROOM ONE

10' 9" x 10' 2" (3.277m x 3.113m) Modern bedroom with





french doors to the side leading to tiled terrace area, newly fitted grey carpet. Dressing area has his & hers wardrobes. Open plan to the en suite shower room.

#### ENSUITE

Fantastic modern en-suite. Heated chrome towel rail. Walk in shower. Sink with vanity cupboard. Low level WC. Underfloor heating throughout (including shower).

#### BEDROOM TWO

10' 10" x 10' 10" (3.303m x 3.316m) Stunning DOUBLE bedroom with sliding mirrored wardrobes. Double glazed bay window to front. Radiator

#### BEDROOM THREE

10' 9" x 9' 2" (3.286m x 2.815m) Modern DOUBLE bedroom with sliding mirrored wardrobes. Double glazed bay window to front. Radiator

#### BATHROOM

Three piece suite comprising tiled panelled bath, wash hand basin with mixer tap and low level w/c, heated chrome towel rail, extractor fan, double glazed obscure window to side, modern grey heated tiled flooring (including shower space).

#### REAR GARDEN

Modern slab paved patio area, remainder laid to lawn, side gated access to driveway.

#### FRONT GARDEN/DRIVE

Block paved driveway providing off street parking for multiple vehicles, side gated access to rear garden. Grass & rockery feature to right of property.

#### COUNCIL TAX BAND



GROUND FLOOR  
 947 sq.ft. (88.0 sq.m.) approx.

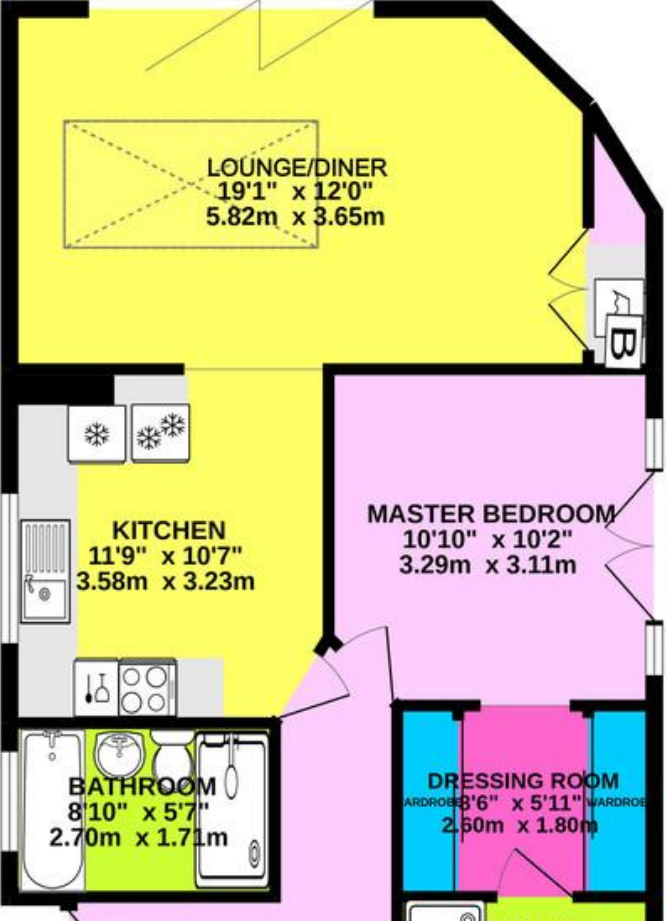

Score	Energy rating	Current	Potential
92+	A		
81-91	B		87   B
69-80	C	71   c	
55-68	D		
39-54	E		
21-38	F		
1-20	G		

294 Kiln Road, Benfleet, Essex,  
 SS7 1QT

stestates.co.uk  
 01702 558110  
 info@stestates.co.uk

Agents Note: Whilst every care has been taken to prepare these sales particulars, they are for guidance purposes only. All measurements are approximate and for general guidance purposes only and whilst every care has been taken to ensure their accuracy, they should not be relied upon and potential buyers are advised to recheck the measurements