

Property Description

Located close to CLOCKHOUSE PRIMARY SCHOOL and with POTENTIAL TO EXTEND (subject to local planning) is a THREE BEDROOM SEMI DETACHED home with OFF STREET PARKING. The property benefits from a 21FT THROUGH LOUNGE/DINER and a MODERN KITCHEN TO THE REAR. Call KEYSTONES to book an internal viewing!!!!

The property opens into an entrance hallway with stairs immediately to the first floor. The modern fitted kitchen is straight in front with a door opening onto the rear garden. There is a door to your right to the 21ft dual aspect lounge diner and again with doors out onto the rear garden. The first floor offers three bedrooms and the family bathroom. Externally the property has off street parking to the front with a shared side access leading round to the garden.

Entrance Hallway

Lounge/Diner - 21'4 Max x 11'4 Max

Kitchen - 10'7 x 6'2

First Floor Landing

Bedroom 1 - 11'6 x 9'9

Bedroom 2 - 10'6 x 10'1

Bedroom 3 - 7'6 x 7'1

Bathroom - 7'1 x 6'2

Rear Garden

Keystones property also offer a professional, ARLA accredited Lettings and Management Service. If you are considering renting your property in order to purchase, are looking at buy to let or would like a free review of your current portfolio then please call the Lettings Branch Manager on the number shown above.

Disclaimer: Information provided about this property does not constitute or form part of an offer or contract, nor may be it be regarded as representations. All interested parties must verify accuracy and your solicitor must verify tenure/lease information, fixtures & fittings and, where the property has been extended/converted, planning/building regulation consents.

All dimensions are approximate and quoted for guidance only as are floor plans which are not to scale and their accuracy cannot be confirmed. Reference to appliances and/or services does not imply that they are necessarily in working order or fit for the purpose.

"Our Service is Key"

**3 Bedroom
Semi-Detached House
Asking Price Of £475,000**

Victoria Avenue, Collier Row, Romford, RM5 2QH



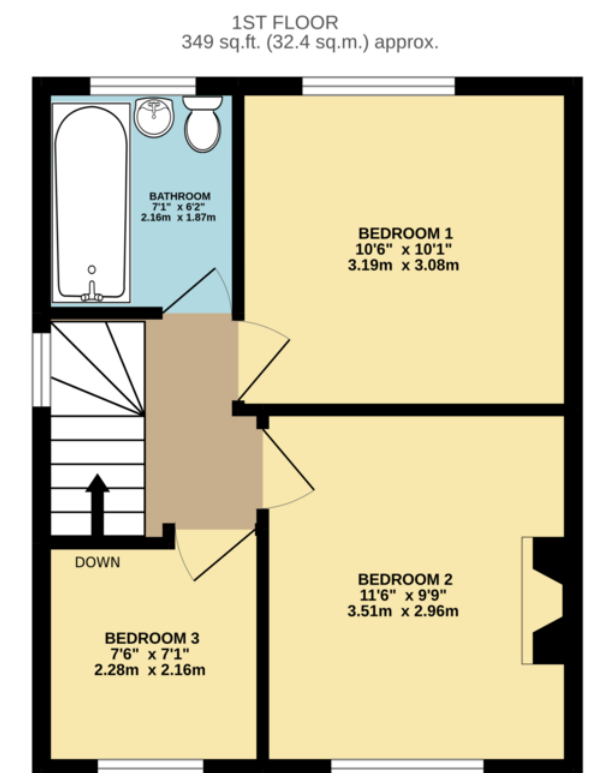
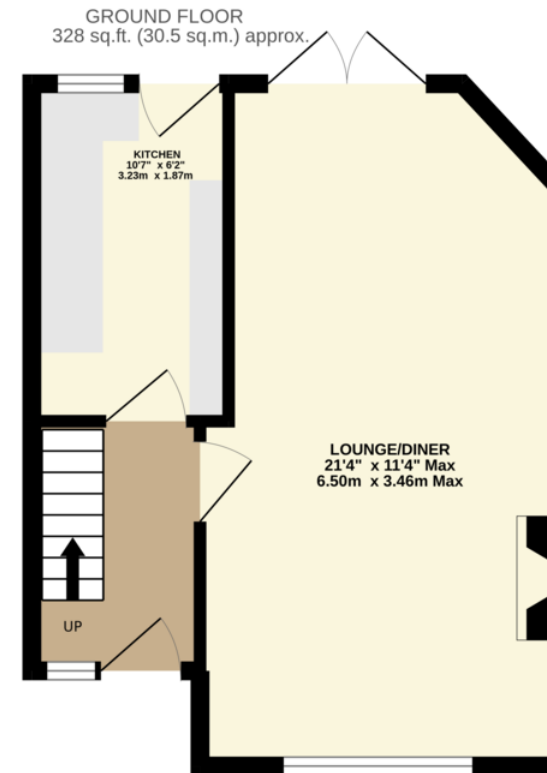

TOTAL FLOOR AREA : 677 sq.ft. (62.9 sq.m.) approx.
 Whilst every attempt has been made to ensure the accuracy of the floorplan contained here, measurements of doors, windows, rooms and any other items are approximate and no responsibility is taken for any error, omission or mis-statement. This plan is for illustrative purposes only and should be used as such by any prospective purchaser. The services, systems and appliances shown have not been tested and no guarantee as to their operability or efficiency can be given.
 Made with Metropix ©2022

