



Seymours



Burley Way Camberley, GU17 0HQ £425,000 Guide Price

Arrange a viewing: 01276 534100

Property Details

- 3 bedrooms
- 1 baths
- EPC Rating TBC
- 1301 sqft (including outbuilding)
- Blackwater Station (0.9 miles)

- Three bedrooms
- Spacious living room
- Large modern kitchen dining room
- Cloakroom and bathroom
- Rear garden
- Driveway parking for two cars
- Office/gym
- Conveniently located for Blackwater
- Council tax band D

A fantastic three-bedroom home which has been converted previously to offer a large modern kitchen/dining room as well as a spacious Living room with access out onto the rear garden. There is also a downstairs cloakroom. To the rear of the garden there is also a Office/gym. The property also benefits from driveway parking for two cars and is located in this popular close in Blackwater which offers a range of shops and amenities as well as a railway station and good local schools.

[01276 534100](tel:01276534100) / james@seymours-blackwater.co.uk

Burley Way

Approximate Gross Internal Area = 104.7 sq m / 1127 sq ft
Outbuilding = 16.2 sq m / 174 sq ft
Total = 120.9 sq m / 1301 sq ft

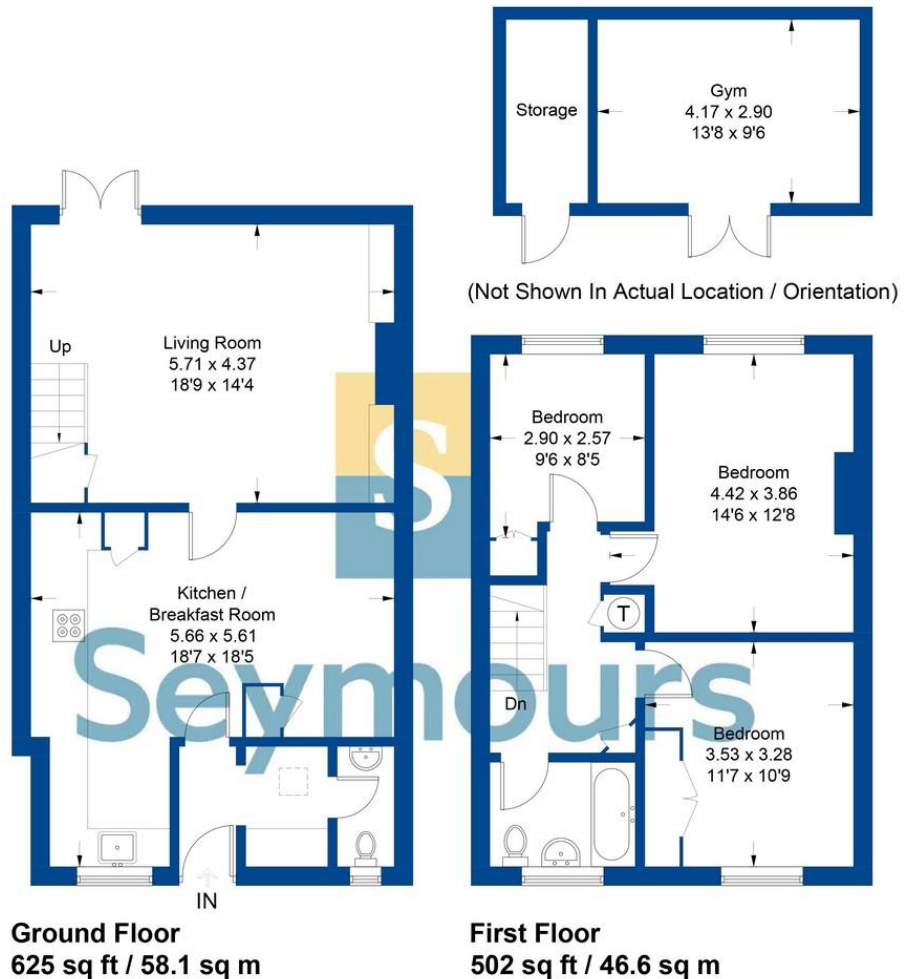

Illustration for identification purposes only, measurements are approximate, not to scale. FloorplansUsketch.com © 2023 (ID967394)