

FOR SALE



Sandringham Avenue, Whiston
Asking Price Of £185,000

MARTIN & CO



Sandringham Avenue, Whiston

3 Bedrooms, 1 Bathroom

Asking Price Of £185,000

- Semi detached
- Three bedrooms
- Two reception rooms
- No chain
- Drive and garage

Offered for sale with no chain involved is this extended three bedroom semi detached home, positioned within a well established and popular part of Whiston. The property presents an opportunity for those looking to take on a refurbishment project, with clear potential to update and personalise throughout. Currently unregistered, the sale may appeal to a range of buyers including investors, developers, or those keen to create a long term home in a convenient and well connected setting. The accommodation begins with a side facing lobby which leads into the main living areas. To the front of the property sits the lounge, featuring a bay window that brings in a good level of natural light and adds to the sense of space. An inner hallway provides access to the first floor and links through to the rear reception space. The dining room, which could also serve as an additional sitting room, offers flexibility depending on requirements and overlooks the rear garden. The kitchen is fitted with a range of wall and base units, with space available for freestanding appliances. There is scope here for modernisation and reconfiguration, allowing the layout to be adapted to suit contemporary living preferences if desired. To the first floor, the landing leads to three bedrooms. The main bedroom benefits from fitted wardrobes, providing useful storage. The remaining bedrooms



offer versatility, suitable for use as sleeping accommodation, a home office, or additional storage space. The family bathroom is fitted with a three piece suite and again presents an opportunity for updating. Externally, the property occupies a pleasant plot with a lawned garden to the front and a driveway running along the side, providing off road parking and access to a single garage. The rear garden is mainly laid to lawn with established shrub borders, offering a straightforward outdoor space that could be further landscaped or enhanced.

ENTRANCE HALL With a side facing entrance door, stairs to the first floor landing and door to the dining room.

DINING ROOM With a wall mounted electric fire, doors to the lounge, access to the kitchen and side facing

window.

LOUNGE With a wall mounted gas fire and front facing window.

KITCHEN With a range of fitted wall and base units. Base units are set beneath worktops which include a single bowl sink, gas cooker point, plumbing for washing machine, space for fridge freezer, tiled splash backs, laminate flooring, side facing entrance door and rear facing window.

FIRST FLOOR LANDING With spindle balustrade.

BEDROOM ONE With fitted wardrobes to one wall and front facing window.

BEDROOM TWO With a rear facing window and laminate floor.

BEDROOM THREE With dual aspect windows to the front, rear and laminate flooring.



BATHROOM Having a white three piece suite which comprises of a low flush w.c, wash hand basin, bath with shower over, tiled walls and rear facing window.

OUTSIDE To the front is a lawn garden with drive to the side. Carport gives access to the garage. To the rear is good size lawn garden with borders.



%epcGraph_c_1_544%



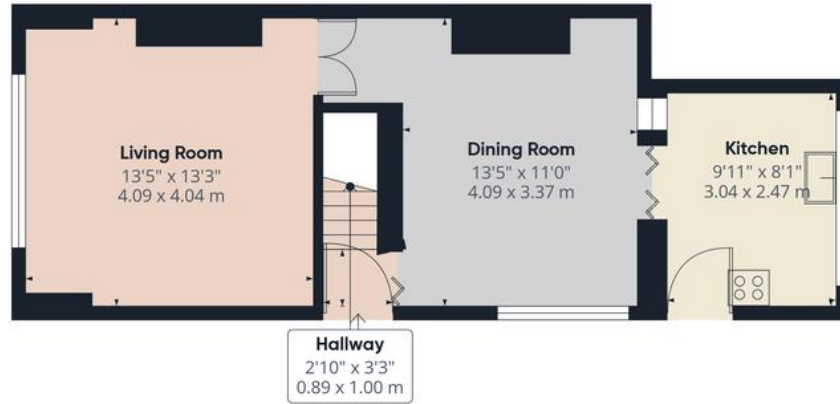

Ground Floor



Approximate total area[®]
852 ft²
79.1 m²

(1) Excluding balconies and terraces

Calculations reference the RICS IPMS
3C standard. Measurements are

Martin & Co Rotherham

5 Worry Goose Lane • Whiston • Rotherham • S60 4AA
T: 01709 544982 • E: rotherham@martinco.com

01709 544982

<http://www.martinco.com>

MARTIN&CO

Accuracy: References to the Tenure of a Property are based on information supplied by the Seller. The Agent has not had sight of the title documents. A Buyer is advised to obtain verification from their Solicitor. Items shown in photographs including but not limited to carpets, fixtures and fittings are not included unless specifically mentioned within the sales particulars. They may however be available by separate negotiation. Buyers must check the availability of any property and make an appointment to view before embarking on any journey to see a property. No person in the employment of the agent has any authority to make any representation about the property, and accordingly any information given is entirely without responsibility on the part of the agents, sellers(s) or lessors(s). Any property particulars are not an offer or contract, nor form part of one. **Sonic / Laser Tape:** Measurements taken using a sonic / laser tape measure may be subject to a small margin of error. **All Measurements:** All Measurements are Approximate. **Services Not tested:** The Agent has not tested any apparatus, equipment, fixtures and fittings or services and so cannot verify that they are in working order or fit for the purpose. A Buyer is advised to obtain verification from their Solicitor or Surveyor.