



## Dale Close, offers over £230,000

- Detached
- Well Presented
- Off Road Parking
- Close Links To M4
- Freehold
- 3 Bedrooms
- 2 Reception Rooms
- EPC Rating: C



 3  1  1



## About the property

Located in the sought-after Forestfach area, this attractive three-bedroom detached home offers generous living space and a bright, welcoming atmosphere throughout.

The ground floor features a spacious living room, perfect for relaxing with the family, along with a separate dining room ideal for entertaining. A practical and well-laid-out kitchen completes the downstairs accommodation, benefiting from plenty of natural light and an airy feel.

Upstairs, you'll find three generous bedrooms along with a modern family bathroom, making it an excellent choice for families or anyone needing additional space.

Outside, the property boasts a beautiful rear garden, providing a peaceful area to unwind. The well-presented front garden includes a driveway with space for at least three cars, offering ample off-road parking.

Situated close to M4 transport links, the city centre, and a range of local amenities, this home is perfectly positioned for convenience while still providing a quiet residential setting.



## Accommodation

### Dining Room

16' x 7' 5" ( 4.88m x 2.26m )

### Living Room

16' 5" x 12' ( 5.00m x 3.66m )

### Kitchen

10' 4" x 8' 1" ( 3.15m x 2.46m )

### Bedroom 1

12' 5" max x 9' 8" max ( 3.78m max x 2.95m max )

### Bedroom 2

9' 1" max x 8' 6" max ( 2.77m max x 2.59m max )

### Bedroom 3

9' 6" x 6' 7" ( 2.90m x 2.01m )

### Bathroom

01792 894422

gorseinon@peteralan.co.uk

## Floorplan

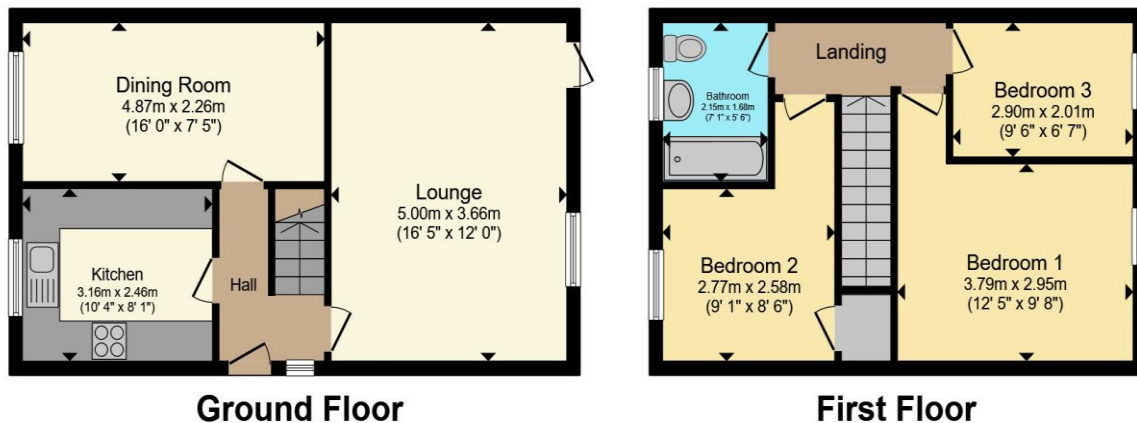

Total floor area 82.5 m<sup>2</sup> (888 sq.ft.) approx

This floor plan is for illustrative purposes only. It is not drawn to scale. Any measurements, floor areas (including any total floor area), openings and orientation are approximate. No details are guaranteed, they cannot be relied upon for any purpose and they do not form part of any agreement. No liability is taken for any error, omission or misstatement. A party must rely upon its own inspection(s). Powered by [www.propertybox.io](http://www.propertybox.io)



## Important Information

Note while we endeavour to make our sales details accurate and reliable, if there is any point which is of particular interest to you, please contact the office and we will be pleased to confirm the position for you. We have not personally tested any apparatus, equipment, fixtures, fittings or services and cannot verify they are in working order or fit for their purposes. Nothing in these particulars is intended to indicate that carpets or curtains, furnishings or fittings, electrical goods (whether wired or not). Gas fires or light fittings or any other fixtures not expressly included form part of the property offered for sale. This computer generated Floorplan, if applicable, is intended as a general guide to the layout and design of the property. It is not to scale and should not be relied upon for dimensions. Tenure: We cannot confirm the tenure of the property as we have not had access to the legal documents. The buyer is advised to obtain verification from their solicitor or surveyor.

Peter Alan Limited is registered in England and Wales under company number 2073153, Registered Office is Cumbria House, 16-20 Hockliffe Street, Leighton Buzzard, Bedfordshire, LU7 1GN. VAT Registration Number is 500 2481 05. For activities relating to regulated mortgages and non-investment insurance contracts, Peter Alan Limited is an appointed representative of Connells Limited which is authorised and regulated by the Financial Conduct Authority. Connells Limited's Financial Services Register number is 302221. Most buy-to-let

