



bonners & babingtons

Clinkard Place
Moor Common

Clinkard Place
Moor Common
Lane End
Buckinghamshire
HP14 3HQ

- Tenure: Freehold
- Price: £525,000
- Local Authority: BCC
- EPC Rating: C
- Council Tax Band: F



Situated in a small cul-de-sac set high in the Chiltern Hills and within an area of outstanding natural beauty (AONB) between the sought after villages of Lane End and Frieth is this modern four bedroom detached family home. The accommodation briefly comprises entrance hall, cloakroom, lounge with wood burning stove, double doors to separate dining room and a good sized kitchen. On the first floor there is a master bedroom with en-suite shower room and built in wardrobes, three further bedrooms and a family bathroom. Externally there is a single garage with driveway parking, lawned front garden and side pedestrian access leading to the low maintenance rear garden which benefits from a good degree of privacy. The property also benefits from double glazed windows, gas central heating and is offered for sale with NO ONWARD CHAIN.

Moor Common is a delightful semi rural environment, located almost equidistant between the Chiltern villages of Frieth & Lane End, both approximately one mile away. Lane End offers a selection of shops for daily needs whilst Frieth is a charming quintessential English village with a village primary school, period Church & two pub/restaurants. The bustling riverside town of Marlow is just over 4 miles away with its array of individual shops, cafes & restaurants, along with Business Park and Station to London Paddington via Maidenhead. High Wycombe is less than 5 miles with Station to London Marylebone, with the M40 motorway to London or Oxford accessible at either J4 Handy Cross or J5 Stokenchurch both within a 10 minute drive. Local recreational facilities include walking, cycling & riding nearby in the Hambleden Valley, with a host of sports clubs of all types in both Marlow & High Wycombe.



Offered with NO ONWARD CHAIN a well presented, modern FOUR bedroom DETACHED FAMILY HOME located within a CUL-DE-SAC and set in an area of outstanding natural beauty (AONB) high in the CHILTERN HILLS between the lovely villages of Lane End and Frieth.



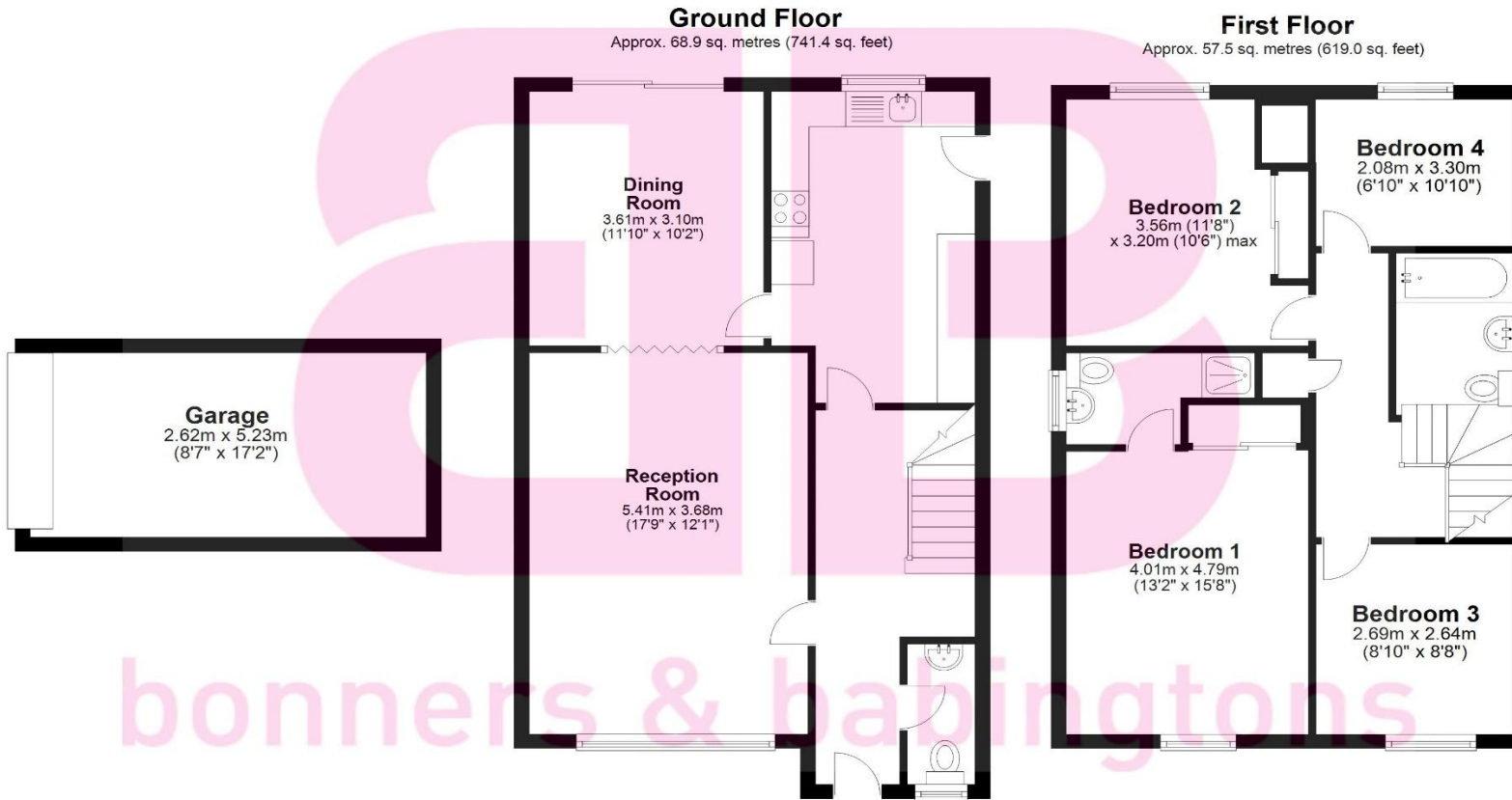

Total area: approx. 126.4 sq. metres (1360.5 sq. feet)

This floorplan is not to scale. It is to be used for guidance and illustrative purposes only. Accuracy is not guaranteed.
Plan produced using PlanUp.



bonners & babingtons

3 Anglers Court, Spittal Street,
Marlow, Bucks, SL7 3HJ



01628 333800

www.bb-estateagents.co.uk

Disclaimer

We endeavour to make our particulars accurate and reliable. They are for guidance only and are intended to give a fair overall summary of the property. They do not form part of any contract or offer, and should not be relied upon as a statement or representation of fact. Measurements, areas and distances are approximate and photographs provided for guidance only. No undertaking is given as to the structural condition of the property, or any necessary consents, or the operating ability or efficiency of any service, system or appliance. Prospective purchasers must satisfy themselves with regard to each of these points. If there is any particular aspect of the property about which you would like further information, please contact us, especially, before you travel to the property. B2170