



High Street, Somersham, PE28 3JB

£875 pcm Unfurnished

2 Bedrooms

Available from 27/06/2026

EPC rating: E (likely to be better if reassessed).

45 Mill Road, Cambridge CB1 2AW

TEL: 01223 322552

E-MAIL: cambridgelettings@pocock.co.uk

WEB: www.pocock.co.uk



High Street, Somersham PE28 3JB

Recently refurbished two bedroom cottage with modern kitchen and shower room. Small garden with store and on street parking. Close to village amenities.

- Character cottage
- Two bedrooms
- New kitchen and shower room
- Recently refurbished throughout
- Deposit £1009.00
- Low ceilings
- EPC - E (has been refurbished since)
-
-
-

Rent: £875 pcm

Viewing by appointment

Recently refurbished two bedroom cottage with modern kitchen and shower room. Small garden with store and on street parking. Close to village amenities.

Somersham is a well served village close to St Ives and with easy access to Huntingdon or Cambridge. St Ives is on the guided bus route to both larger towns.

This two bedroom cottage was recently fully refurbished.

LIVING ROOM

12'10" x 8'10" (3.90 m x 2.70 m)

Entrance from the street and stairs to the first floor plus access to the kitchen.

KITCHEN

10'6" x 12'10" (3.20 m x 3.90 m)

Room for a small dining table and chairs. Recently fitted kitchen units with ceramic hob, extractor hood and electric oven. Space and plumbing for a washing machine and for a freestanding fridge freezer (neither provided).

BEDROOM 1

Double room overlooking the High Street with built in wardrobe.

BEDROOM 2

Single room with cupboard housing the hot water tank.

Energy Efficiency Rating		Current	Potential
<i>Very energy efficient - lower running costs</i>			
(92 plus) A			94
(81-91) B			
(69-80) C			
(55-68) D			
(39-54) E		41	
(21-38) F			
(1-20) G			
<i>Not energy efficient - higher running costs</i>			

SHOWER ROOM

Newly fitted shower cubicle, basin and WC.

Garden at the rear with brick store and 'work room'.
Garden access via side passage and through a neighbouring garden.

Parking is on the street.

EPC rating is E, but the refurbishment may have improved the rating.

Council Tax Band: A

Holding Deposit: £201

Material Information:

https://sprift.com/dashboard/property-report/?access_report_id=5362556

Ground Floor

Approx. 25.8 sq. metres (277.4 sq. feet)

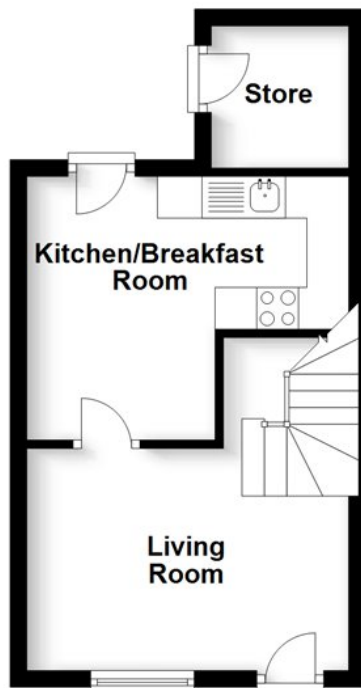

First Floor

Approx. 22.8 sq. metres (245.5 sq. feet)

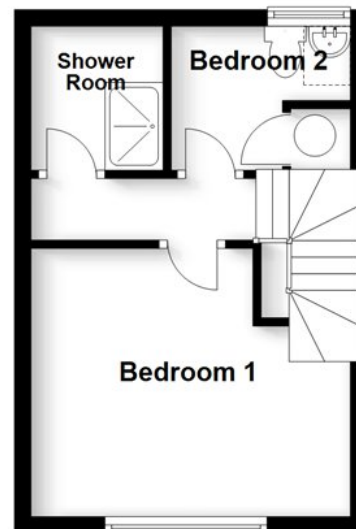

Applying for a Property

British or Irish Citizens must evidence their right to rent from the documents listed below.

Either:

- a passport
- a travel document issued by the Home Office
- an immigration status document sent to you when you were given permission to stay in the UK

All of the above must include a Home Office endorsement. For example, a stamp or a vignette (sticker) inside. This must say you have one of the following

- indefinite leave to enter or indefinite leave to remain in the UK
- no time limit to your stay in the UK
- a certificate of entitlement to the right of abode
- exemption from immigration control
- limited leave to enter or limited leave to remain in the UK, or permission to stay for a time limited period - this must cover the time you'll be renting
- a certificate of entitlement to readmission to the UK

Non British or Irish Citizens will need to obtain a share code and including the following documentation to indicate the named person may stay in the UK. <https://www.gov.uk/prove-right-to-rent/get-a-share-code-online>

Either:

- a British passport (current or expired)
- an Irish passport or passport card (current or expired)
- a certificate of re-astration or naturalisation as a British citizen

OR

Two of the following:

- a current UK driving licence (full or provisional)
- a full birth or adoption certificate from the UK, Guernsey, Jersey, the Isle of Man or Ireland
- a letter from your employer
- a letter from a British passport holder in an accepted profession
- a letter from a UK government department or local council
- proof that you currently receive benefits
- a letter from a British school, college, or university that you currently go to
- a Disclosure and Barring Service (DBS) certificate
- proof that you have served in the UK armed forces
- a letter from a private rented sector access scheme or a voluntary organisation assisting you with housing
- a letter confirming you have been released from prison within the past 6 months
- a letter confirming you are on probation from your offender manager
- a letter from the UK police about the theft of your passport

These checks need to be followed up either 12 months from the date of the previous check, or before the expiry of the person's right to live in the UK. Copies of these documents are kept and will also be sent to our reference company so they can be verified

Important

All applications and negotiations are subject to contract, successful referencing and landlord approval. The payment of the initial monies will be deemed as acceptance of these terms.

Deposit held during the tenancy:

The security deposit of no more than the equivalent of 5 weeks' rent (or 6 weeks' for a property with a rent of over £50,000 per year), is held during the tenancy and this, together with the initial rent payment, is to be received by Pocock & Shaw before the tenancy can commence.

Other costs a tenant may incur

In addition to the deposit and rent, a tenant may potentially be charged for the following when required:

1. A holding deposit of no more than one weeks' rent;
2. A default fee for late payment of rent (after 14 days);
3. Reasonable charges for lost keys or security fobs;
4. Costs associated with contract variation when requested by the tenant, at £50, or reasonable costs incurred if higher.
5. Costs associated with early termination of the tenancy, when requested by the tenant; and
6. Costs in respect of bills - utilities, communication services, TV licence, council tax and green deal or other energy efficiency charges.