

Agents Note: Whilst every care has been taken to prepare these sales particulars, they are for guidance purposes only. All measurements are approximate and for general guidance purposes only and whilst every care has been taken to ensure their accuracy, they should not be relied upon and potential buyers are advised to check the measurements



59 FREESTONE WAY, CORSHAM  
TOTAL APPROX. FLOOR AREA 1151 SQ.FT. (106.9 SQ.M.)  
Schematic Diagram only - Not to scale  
Made with Metropix ©2017

GROUND FLOOR  
APPROX. FLOOR  
AREA 408 SQ.FT.  
(37.9 SQ.M.)

1ST FLOOR  
APPROX. FLOOR  
AREA 398 SQ.FT.  
(36.9 SQ.M.)

TOP FLOOR  
APPROX. FLOOR  
AREA 345 SQ.FT.  
(32.0 SQ.M.)

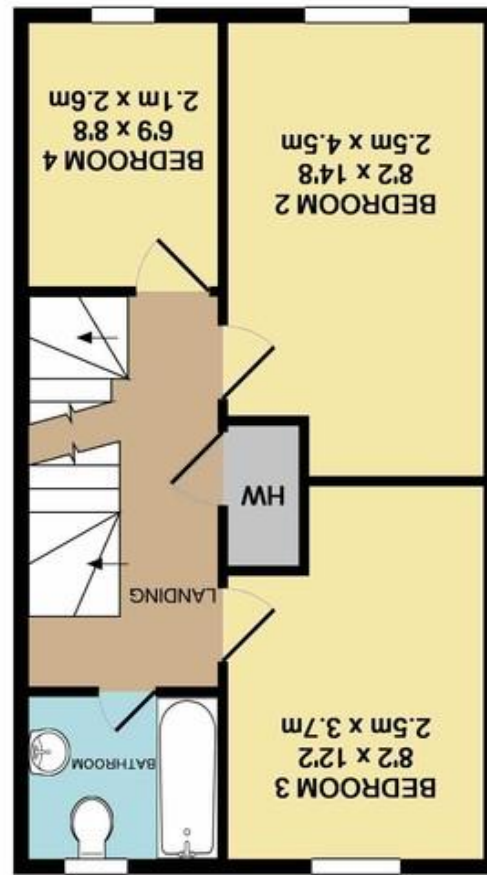
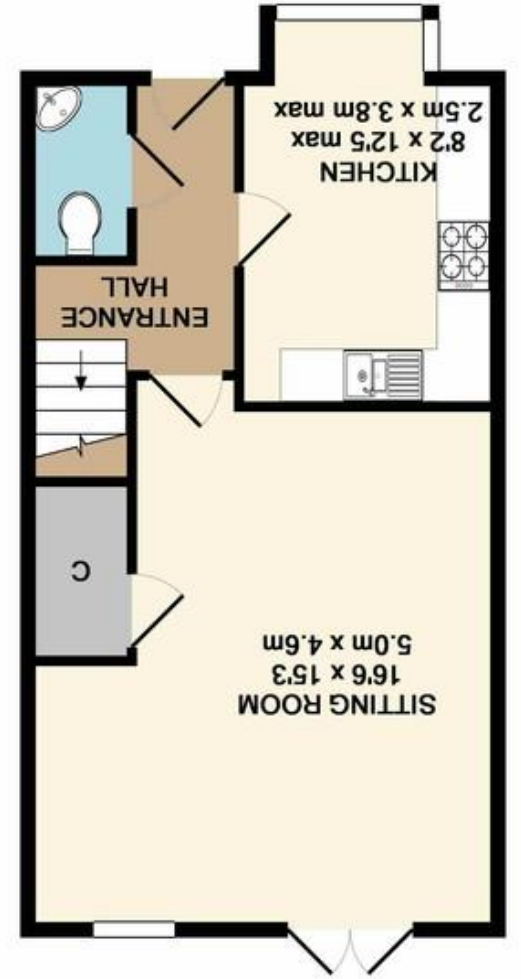

59 Freestone Way, Corsham, Wiltshire, SN13 9EE

DAVID  
INGRAM  
RESIDENTIAL SALES

59 Freestone Way, Corsham, Wiltshire, SN13 9EE

£270,000

### Situation and Description

This well proportioned bay fronted townhouse offers excellent accommodation set over three floors, and is offered for sale with NO ONWARD CHAIN.

The ground floor comprises a kitchen/breakfast room with bay window and space for a small table & chairs; a generous sized L shaped living room with fireplace, French doors to the garden, and a large understairs cupboard. There is also a cloakroom off of the main entrance hall. On the first floor are 2 double bedrooms, 1 single bedroom and a family bathroom. The top floor is entirely dedicated to a spacious master bedroom with dressing area and en-suite shower room.

Externally there is a well enclosed private garden laid to patio and lawn. There is also a rear door to the back of the garage with power & light.

Freestone Way is situated towards the edge of the popular Katherine Park development with lovely lakeside and woodland walks almost on the door step and within easy access of Corsham's picturesque and historic high street which offers a variety of interesting shops, cafes and restaurants. Other local amenities include junior and comprehensive schooling, doctors surgery and leisure centre. Ideally placed for access to the A4, the Georgian city of Bath is within 9 miles with it's vast array of shopping, cultural and leisure amenities and high speed rail service to London, which is also available at nearby Chippenham. There is also fast road access to the M4 motorway via junction 17.

EPC Rating - C



### Directions

From Co-Op car park turn left onto Newlands Road and right at the mini roundabout into Pickwick Road. At the next roundabout, turn left into Valley Road. Take the fourth turning right into Freestone Way. Continue straight on at the first roundabout, right at the second roundabout, and the property will be found on the right hand side.