

Agents Note: Whilst every care has been taken to prepare these sales particulars, they are for guidance purposes only. All measurements are approximate and whilst every care has been taken to ensure their accuracy, they should not be relied upon and potential buyers are advised to check the measurements as to their accuracy or efficiency can be given.

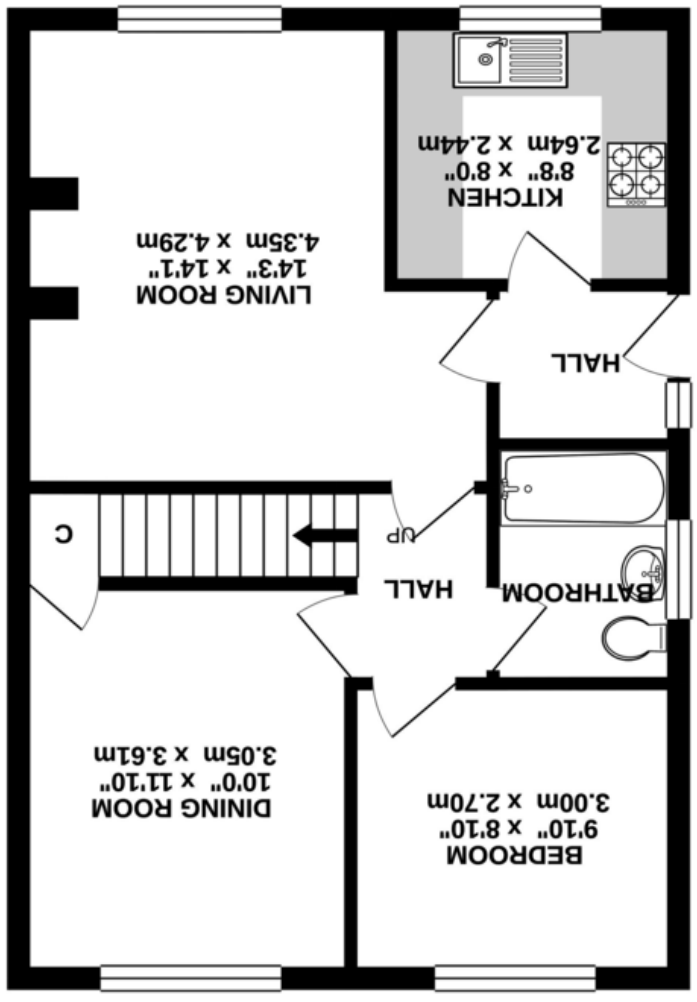

GROUND FLOOR
570 sq.ft. (52.9 sq.m.) approx.

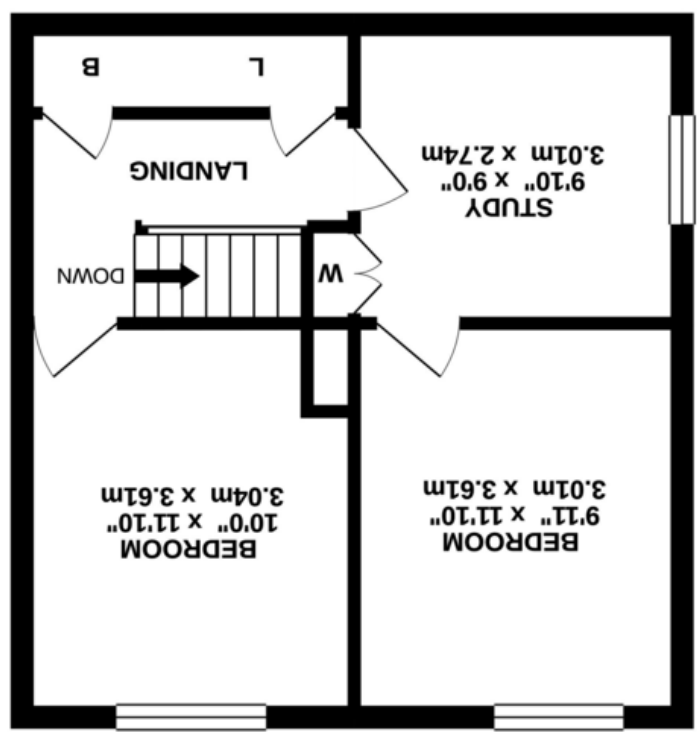

1ST FLOOR
414 sq.ft. (38.5 sq.m.) approx.

Whilst every attempt has been made to ensure the accuracy of the floorplan contained here, measurements of doors, windows, rooms and any other items are approximate and no responsibility is taken for any error, omission or mis-statement. This plan is for illustrative purposes only and should be used as such by any prospective purchaser. The services, systems and appliances shown have not been tested and no guarantee is given as to their operability or efficiency.



24 Tellcroft Close, Corsham, Wiltshire, SN13 9JH



24 Tellcroft Close, Corsham, Wiltshire, SN13 9JH

- Immaculate semi detached house
- UPVC double glazing and gas central heating
- Study/occasional bedroom
- Garage and ample driveway parking
- Three bedrooms, two reception rooms
- Modern kitchen and bathroom
- Good sized, well maintained garden
- Popular location

£289,500

Situation and Description

A beautifully presented and versatile semi detached chalet style property situated on a popular and established road within walking distance of schools and amenities.

The property offers generous accommodation over two floors comprising; entrance vestibule, good sized sitting room, dining room with large cupboard, kitchen with modern units, landing with boiler cupboard (boiler was replaced in February 2020 and has a 7 year guarantee) and cupboard/hanging space for clothes, three double bedrooms, study/occasional bedroom with built in wardrobe and a bathroom with white suite.

Outside

Rear Garden

Well maintained, predominately lawned garden with decked seating areas and pretty flower beds.

Garage

Single unit with up and over door to front, window to rear, power and lighting. There is parking in front of the garage and a parking bay to the front of the house for numerous vehicles.

Corsham offers an excellent range of amenities including the primary schools, secondary school, sports centre, library, arts centre and cricket club. The picturesque high street with its variety of interesting shops, cafes, public houses and Corsham Court with its lovely grounds is also within easy access. More comprehensive shopping and leisure facilities are available in The World Heritage City of Bath within about nine miles which has a mainline railway station with fast access to London (Paddington) as does nearby Chippenham which is within about 4 miles. Junctions 16 and 17 of the M4 motorway are within easy reach and commuting distance of Bristol, Swindon and London.

EPC Rating - C



Directions

From the Co-Op car park, turn left onto Newlands Road. At the mini-roundabout turn left onto B3353 Pickwick Road. At the next mini-roundabout turn right onto Pound Pill. Continue over the next mini-roundabout and then turn right onto Lypiatt Road. Take the third turning on the right onto Tellcroft Close, follow the road round to the left and the property can be found on the right hand side.