



Seymours



Trotsford Meadow Blackwater, GU17 0PD £725,000 Guide Price

Arrange a viewing: 01276 534100

Property Details

 4 bedrooms

 2 baths

 EPC Rating C

 2,017sqft

 Blackwater Station (0.8 miles)

- Detached house in popular close
- Modern refurbished open plan
- kitchen/breakfast/family room
- Living room
- Study
- Utility area
- Cloakroom
- Four double bedrooms
- Modern family bathroom and en-suite

A substantial and well-appointed detached family home which benefits from superb open plan downstairs living space having been much improved by the current owners. The property is situated in this sought-after close in Frogmore, giving excellent access to good local schools, amenities and road links as well Blackwater station all close by. The house offers a fabulous open plan Kitchen/breakfast/family room with bi-fold doors to the garden. There is also a separate Sitting room and a spacious study. Upstairs the Master bedroom has a modern en-suite and then 3 further double bedrooms with a refitted modern family shower room. To the rear of the property is an attractive garden.

[01276 534100](tel:01276534100) / james@seymours-blackwater.co.uk



Trotsford Meadow

Approximate Gross Internal Area = 184.5 sq m / 1986 sq ft
Garage = 2.9 sq m / 31 sq ft
Total = 187.4 sq m / 2017 sq ft

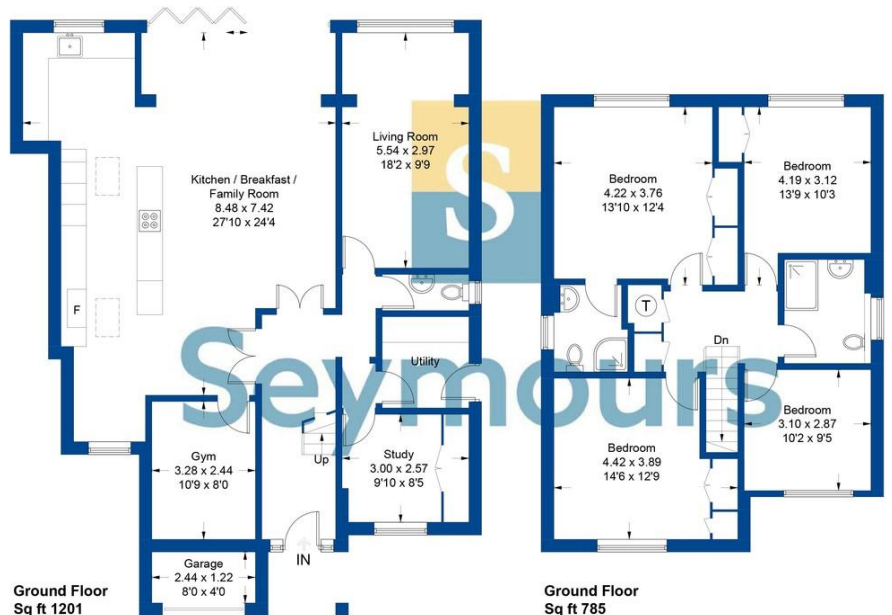

Illustration for identification purposes only, measurements are approximate, not to scale. FloorplansUsketch.com © 2021 (ID793399)